

2023 UIL STATE MARIACHI FESTIVAL

PARTICIPANT INFORMATION

CONTACT INFORMATION

Prior to Event: UIL Web Site: <https://www.uiltexas.org/music/mariachi>
E-mail: music@uiltexas.org (best method for quickest response)
Phone: (512) 471-5883

During Event: UIL Web Site: <https://www.uiltexas.org/music/mariachi>
E-mail: music@uiltexas.org (best method for quickest response)
Phone (emergency only): (832) 515-5115 OR (806) 335-6244

SCHEDULE

The final schedule will be released seven to ten days prior to the event, after the final region contests conclude. Schools will be scheduled for the session requested when completing entry unless demand exceeds availability. If demand for a particular session exceeds availability, groups will be selected based on random draw. Schools will be scheduled in conference order (small to large), within each session. See <http://www.uiltexas.org/music/state-mariachi-festival> for session times. The festival will run on schedule. Please advise spectators to arrive well in advance of your performance.

BUS PARKING AND EQUIPMENT UNLOADING

See maps included.

SPECTATOR PARKING

Please communicate to your spectators that spectator parking at no charge is provided in the lots indicated on the enclosed map.

GROUP STAGING AREA

No group staging area will be available. Plan to keep equipment on your bus until time to enter the warm-up room. Instrument and case storage will be provided in rooms A110 and A111, but not monitored. **NOTE: Playing of instruments is permitted only in designated rooms.**

DIRECTOR CHECK-IN

The director must check-in at the festival office in the auditorium lobby upon arrival (see map) and bring the following items with you:

- 1) Three (3) published or computer generated scores **WITH MEASURES NUMBERED** and name of selection that includes a *son* in the style of *son jaliscience*.
- 2) The times that your group will listen to other performances (See Festival Information) http://www.uiltexas.org/files/music/SMF_Rules.pdf

CHANGING FACILITIES AND RESTROOMS

You are encouraged to have your students in performance attire when you arrive at the festival site. If your students need changing facilities they may use the public restrooms located in the lobby area. There will be no storage area available. There will be two classrooms provided for students to do their hair and makeup (Male Green Room and Female Green Room) (A114 and A116).

FESTIVAL GUIDE

A festival guide will be assigned to your group. You will meet your guide at the performer entrance ([see map](#)). Your guide will be available 15 minutes prior to your scheduled warm-up and will remain with you through your performance, clinic and group photo.

WARM-UP

Your group will be scheduled for 30 minutes in warm-up and will be expected to proceed to the stage entrance 10 minutes prior to your performance time. NOTE: Warm-up is permitted only at your assigned time and in your assigned room (1 or 2). **Although your group will be scheduled for 30 minutes in warm-up, actual festival performance schedule may necessitate a reduction to this time. Be prepared to be flexible to keep the festival running on schedule.**

AMPLIFICATION

Each group has the option to perform with or without amplification. Amplification will be provided by the UIL.

OFFICIAL TIME

Performance time is limited to 10 minutes of music. Groups are assigned performance times based on conference and scheduled at 15-minute intervals. The time structure for each performance will be held strictly to:

- 1) 3 minutes set up and sound check (directors may work with sound provider to adjust volume and/or microphone placement.)
- 2) 1 minute announcement
- 3) 10 minutes of music performance
- 4) 1 minute stage exit

The Festival Compliance Official (FCO) will be located backstage to monitor and make note of performance times. The FCO will also have a visible clock for the above 15-minute structure. Directors should plan their program accordingly.

PERFORMANCE ANNOUNCEMENT

The announcement of your group will be made using the information you provide in the online entry form. All groups will be announced following the same format. Once your group has been announced on stage your 10-minute performance time will begin either at the beginning of your music or at the end of the 1 minute announcement – whichever comes first.

RULES AND COMPLIANCE

As stated in the published information all performing groups shall follow the rules of the state mariachi festival pilot, including performance regulations, instrumentation, and music scores. Any group not meeting these requirements is **subject to disqualification**. The decision of the judges and all compliance matters as determined by UIL are final.

CLINIC

At the conclusion of your performance, you will proceed to one of the rehearsal rooms, where your group will receive a 25-minute clinic with an adjudicator. Our hope is that this experience will add a personal element to the festival and allow the students to actually meet and learn from a nationally recognized mariachi clinician.

GROUP PHOTO

At the conclusion of your clinic, the guide will direct your group to the site for a group photo. Group photos and orders will be done by Jolesch Enterprises.

RATINGS AND AWARDS CEREMONY

There will be an awards ceremony at the conclusion of each session. One student representative from each group will be asked to return to the stage and line up in performance order. Each school will be recognized and Division 1 ratings announced. Outstanding performers will also be announced and draped with their medal. Ratings will be posted online at www.uiltexas.org/music at the conclusion of each session's awards.

CHECK-OUT

After the awards conclude for the session, directors will check-out at the festival office and receive adjudicator comments sheets, music scores, and awards.

LIVE STREAMING

The festival will be live streamed. More information may be found here: <https://www.uiltexas.org/music/mariachi>. **Due to copyright restrictions, recordings will not be made.**

RECORDED ADJUDICATOR COMMENTS

Judges will use digital recorders for all performance evaluations. After the performance these digital files will be emailed to the address submitted in the online entry.

CHAPERONE/PARTICIPANT ADMISSION

The entrance admission policy is established by the UIL. When you check-in each student participant and the group director will be issued a UIL wristband for identification and admission. In addition, the director will be given 4 additional wristbands to issue at your discretion. Consideration for these 4 additional wristbands should be given to assistant director(s), chaperones, bus driver, etc. Each group will receive the same number of additional wristbands. The wristbands are good for all sessions. School Administrators will be allowed complimentary admission by identifying themselves at the entrance

EMERGENCY REPAIRS

On-site instrument repair services will NOT be available. Please plan accordingly.

VENUE GUIDELINES

Please communicate the following with all participants, colleagues, & spectators:

1. No audio or video recording is allowed at any time during a performance.
2. No flash photography is allowed during a performance.
3. No food/drinks, etc. are allowed in the auditorium, including chewing gum.
4. No balloons or signs are allowed in the auditorium.
5. No tobacco, alcohol, or weapons are allowed on venue property.
6. Only participants and their director are allowed in the warm-up, stage, clinic, and group photo areas.
7. ***NEW*** Only clear bags are permitted in the auditorium (see clear bag policy).

ADMISSION CHARGE

Admission policy is established by the UIL. Admission for the State Mariachi Festival:

Ages 3 and up: \$15.00 + fees, per person per session

Ages 2 and under: no admission charge

Session 1 – Friday afternoon/evening

Session 2 – Saturday morning/early afternoon

Session 3 - Saturday late afternoon/evening

Tickets are available online only. NO CASH SALES. See the UIL website for all information. Spectators must have a paid admission for each session. **All sales are final.**

UIL State Mariachi Festival

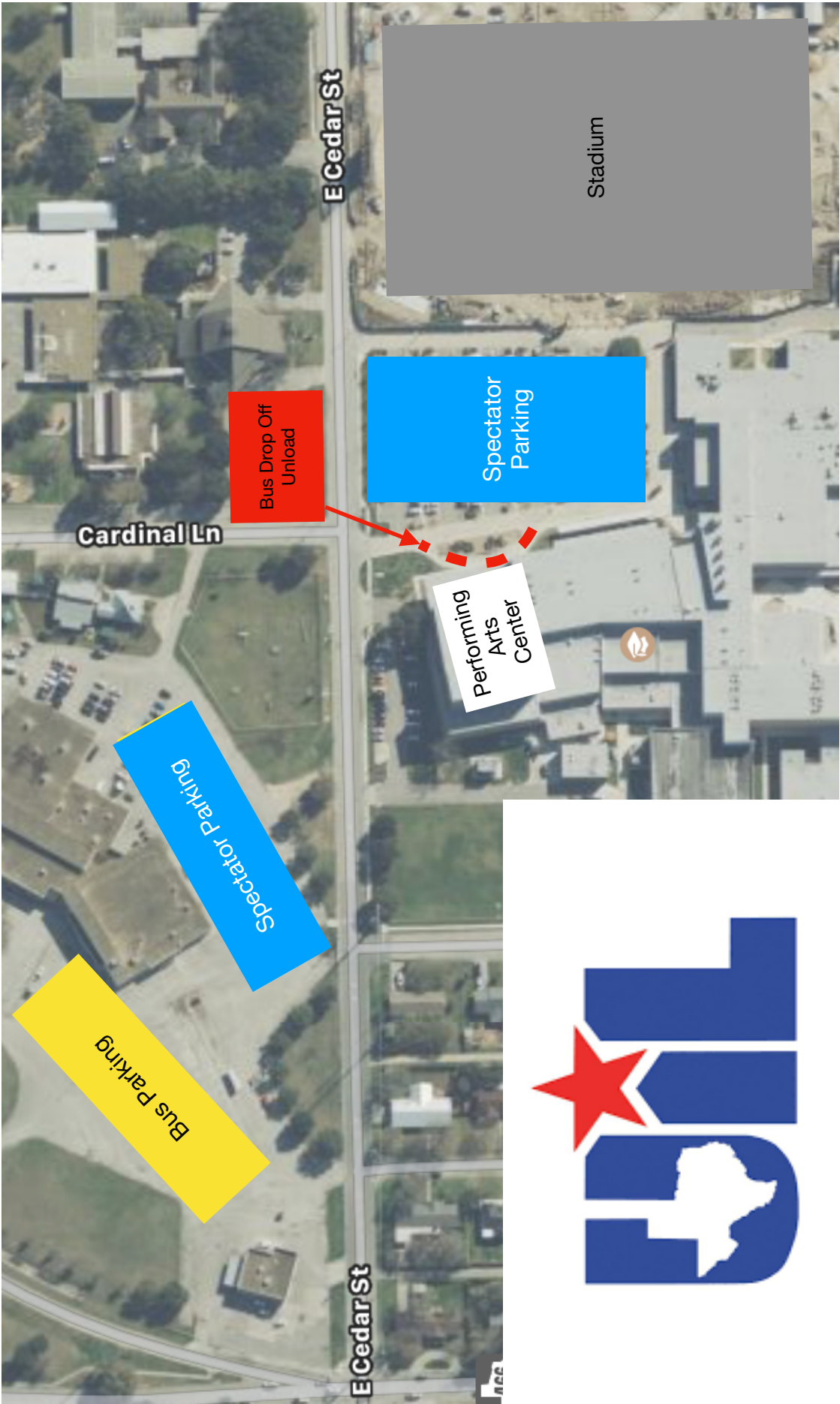

UIL State Mariachi Festival

Seguin High School - Seguin, Texas

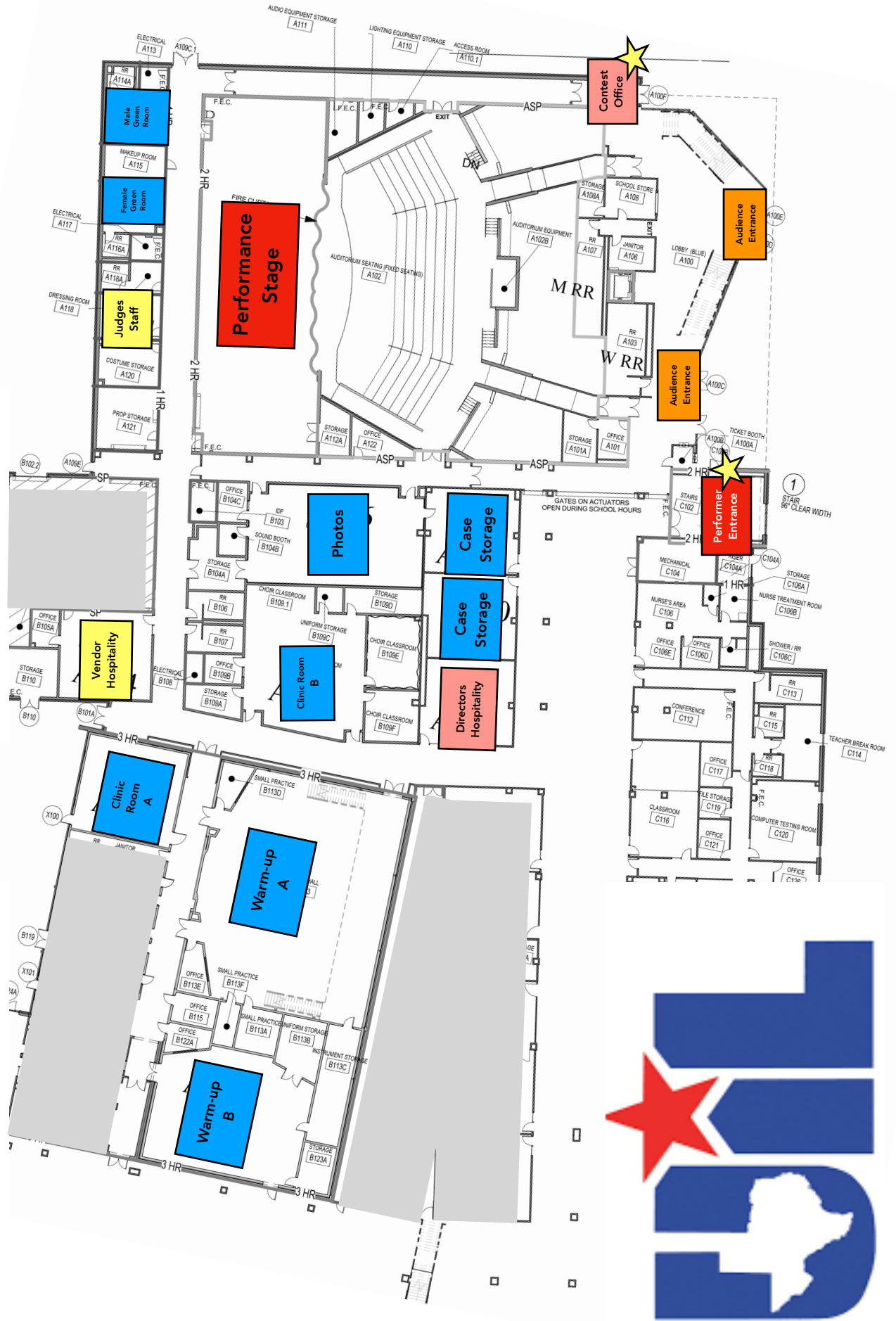

Matador Clear Bag Policy

APPROVED BAGS



OR



OR



6.5X4.5" Small Bag
Small Clutch Purse

Medical bags are permitted and subject to a thorough inspection.

Seat cushions more than 16" wide are permitted and subject to a thorough inspection.

* No backpacks are allowed in Matador Stadium.

PROHIBITED BAGS

These items are not allowed.

- Purses
- Diaper bags
- Cases (camera, binocular, etc.)
- Fanny packs
- Printed pattern plastic bags
- Reusable grocery totes
- Mesh or straw bags
- Duffle bags
- Large Totes



State Mariachi Festival Stage Chart

This diagram shows how microphones will be set for the various instruments in your group. Sound techs will move and adjust the microphones during the 3 minute set up and sound check.

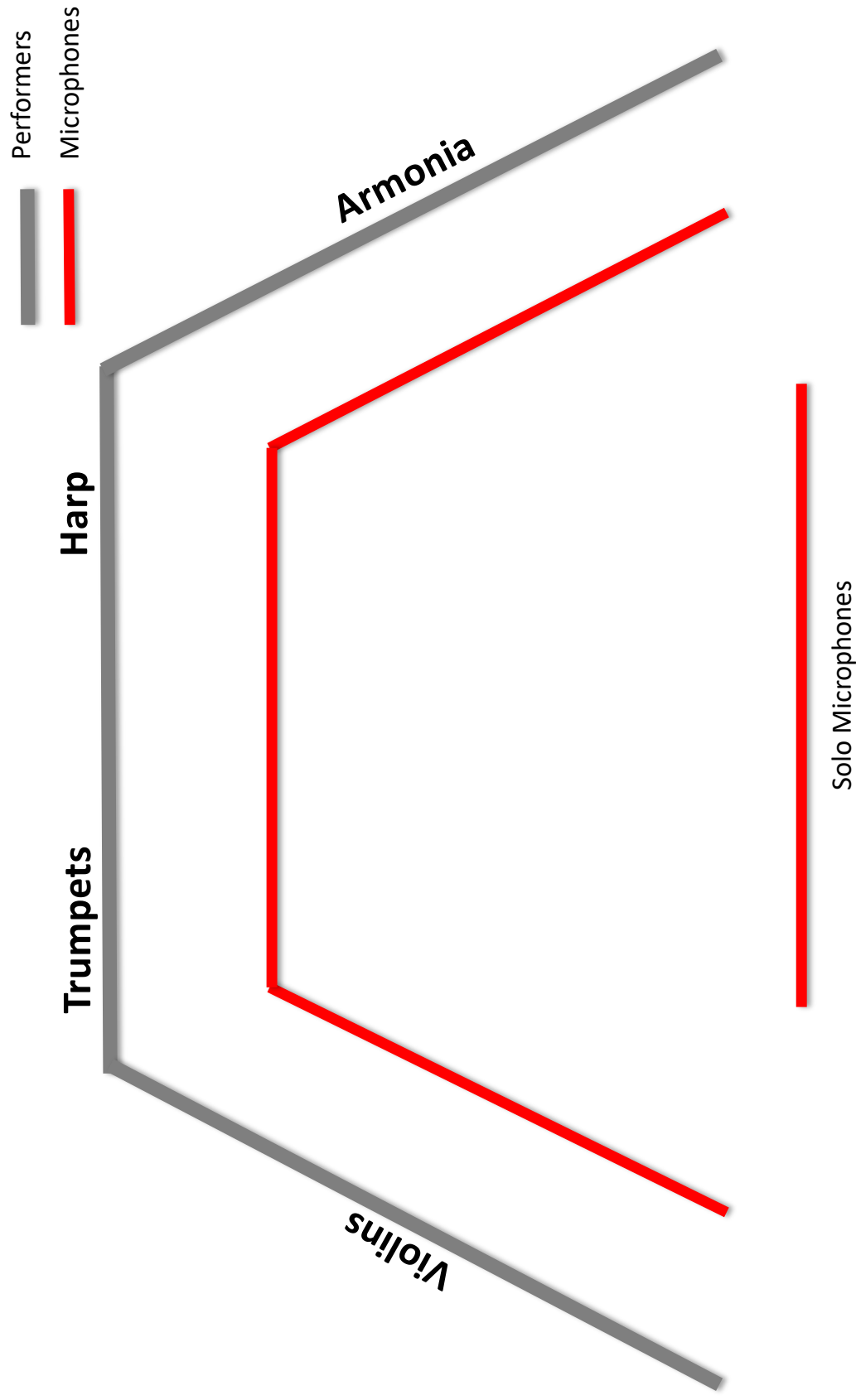

SMF Performance Compliance List

School_____ Conference_____

Performance Time Structure (All timed by FCO):

3 Minutes Set-up and Sound Check

1 Minute Announcement

10 Minutes Performance

1 Minute Stage Exit

Time Scheduled To Enter Stage: _____

Actual Time Entered Stage: _____ (3 minutes set-up and sound check)

Time Performance Began: _____ Ended: _____

Repertoire –

Performance included a *son jalisciense* (yes or no) _____

Instrumentation –

Total Number of Performers (Minimum 7; Maximum 24) _____

Traditional (yes or no) _____

Traditional: (Minimum)

Violins (3) _____

Trumpets (1) _____

Guitarron(1) _____

Vihuela(1) _____

Guitar(1) _____

Festival Compliance Official

State Mariachi Festival

RULES. Each performing ensemble shall follow the published rules of the state mariachi festival, including performance regulations, instrumentation, and music scores. Any ensemble not meeting these requirements shall be subject to disqualification.

ENTRY REQUIREMENTS.

- (1) [Entry for each ensemble](#) shall be completed within 2 business days after the ensemble's assigned region contest.
- (2) Each ensemble will be assessed an entry fee.

ELIGIBILITY. Any varsity ensemble in the traditional category receiving an overall Division 1 rating at the current year's assigned region contest is eligible to advance to the state mariachi festival. Non-varsity ensembles are not eligible to advance to the state festival and varsity ensembles receiving an overall Division 1 rating in the experimental category are not eligible to advance to the state festival.

REPERTOIRE. Repertoire must include a *son* in the style of *son jalisciense*. At least one other selection (may be included in a medley) must be performed and should be in a contrasting style.

ADMISSION FEE. Performances will be open to the general public. An admission fee will be charged. Admission information will be posted on the UIL website. Performers, directors, and school administrators will receive complimentary admission.

SCHEDULE. Ensembles will be scheduled by conference at 15-minute intervals as follows:

3 minutes: set up and complete sound check

1 minute: announcement

10 minutes: maximum performance time (no minimum)

1 minute: stage exit

A Festival Compliance Official (FCO) will have a Performance Compliance List (included) and time will be kept back stage by the official.

MUSIC SCORES. Upon arrival at the festival, directors are to check in at the festival office and provide three sets of music scores. The scores are to be published or computer generated with measures numbered and in standard published score format. Scores are to include all parts, including vocal part(s) and lyrics.

ADJUDICATION.

- (1) Each ensemble will receive a written and recorded critique from a panel of three judges.
- (2) Each ensemble will receive a rating of Division I, II, III, IV, or V from each of the three judges. An overall rating will be assigned based on the formula outlined in Section 1112 of the Constitution and Contest Rules.

CLINIC. Each ensemble will receive a 30-minute clinic with a nationally recognized mariachi educator/performer at the conclusion of their performance. The focus of this interaction will be on musicianship and the artistry of making music.

CONCERT ATTENDANCE. Each mariachi ensemble will be expected to structure a schedule that will enable the students to listen to the performance of at least two other performing groups over the course of the day.

AWARDS.

- (1) Each ensemble receiving an overall rating of Division 1 will receive a group award as well as individual gold medals for each member.
- (2) Each ensemble receiving an overall rating other than Division 1 will receive a distinguished performance award.
- (3) At the option of the judging panel, individual performers and/or sections of each ensemble may be honored for exemplary musical achievement and receive a draped state gold medal.