

# UIL STATE SOLO-ENSEMBLE CONTEST (TSSEC) May 27 & May 29, 2023

## 1A/2A/3A/4A Woodwinds, Brass, Percussion Site Information

*Site: Hendrickson High School, Pflugerville ISD*

## 1A/2A/3A/4A Voice, Strings, Twirling, Piano Site Information

*Kelly Lane Middle School, Pflugerville ISD*

In order for the contest to run as smoothly as possible it is essential that the following protocol, rules, and guidelines are followed. Please read all instructions carefully and make sure your students and spectators are aware of all procedures. Take special note of the maps and follow traffic flow and parking specifics.

**INFORMATION BOOTH:** Front entrance at each HHS & KLMS, additional information booth located at HHS Cafeteria.

**WARM-UP ROOMS:** HHS Cafeteria & KLMS Cafeteria

**WARM-UP PIANOS:** KLMS Band Ensemble Room

**PERCUSSION WARM-UP:** HHS Band Lot; however, in the event of inclement weather, the location will be moved to the small gym near the cafeteria. Plan to arrive at the staging area 10 mins prior to performance time.

### **INSTRUMENTS AND EQUIPMENT:**

Percussion Rooms: One set of Chimes, Bass Drum, (4) Timpani, 5.0 Oct. Marimba, 3.0 Oct Vibraphone, and 3.5 Oct. Xylophone. These instruments will be shared between the two locations (Band Hall/Aux Hall) and travel on an as needed basis.

The Keyboard Locations will have One 4.3 Marimba, and 3.5 Oct Xylophone available to be used and will travel between the individual performance rooms on an as needed basis.

All Other Rooms: Participants will be responsible for providing all instruments and equipment.

<b>NO MUSIC STANDS WILL BE PROVIDED:</b> If stands are needed, you must provide your own.
---

**RECORDED OR ELECTRONICALLY-GENERATED ACCOMPANIMENTS:** recorded or electronically-generated accompaniments may be used. Students must provide their own equipment and should activate the system prior to entering the room to prevent any delays in the contest schedule.

**BUSES:** There will be a parking monitor for buses entering the Hendrickson location. The attendant will instruct the bus driver where to drop-off, unload, & park. **Percussion vehicles** may follow the traffic flow map.

**Map QR Code:** *Participants should download the Google Earth Application*



**Site Map:** [2023 TSSEC Site Map](#)

**PERSONAL VEHICLE PARKING:** See [2023 TSSEC Site Map](#)

**FOOD:** Food and beverages will be available for purchase in the cafeteria; however, **NO FOOD OR DRINK MAY BE BROUGHT INTO THE PERFORMANCE HALLWAYS.**

**RATINGS:** Ratings will be posted [online](#).

**CONTEST OFFICE/AWARD STATION:** HHS & KLMS Library. Opens at 7:45 AM

**ADJUDICATION SHEETS AND MEDALS:** All adjudication evaluations are online. The comment sheet for each entry will be located in the director's account that registered the events for the contest ([www.texasmusicforms.com](http://www.texasmusicforms.com)). Medals must be picked up in the award station (located in the HHS Library and KLMS Library) by the sponsor or designee. **MEDALS WILL NOT BE MAILED. PLEASE PLAN ACCORDINGLY. EXCEPTION: OUTSTANDING PERFORMER MEDALS AND MUSIC THEORY MEDALS THAT WERE NOT PICKED UP ON SITE WILL BE MAILED TO THE ADDRESS ON THE TEXASMUSICFORMS ACCOUNT.**

**QUESTIONS:** Prior to the contest: [music@uiltexas.org](mailto:music@uiltexas.org). During the contest: either the information booth or the contest office.

**SPECTATORS:** All performances are open to the public. Parents, teachers, friends and other spectators are welcome to attend any contest performance.

**COPYRIGHT COMPLIANCE:** All Judges must have a copyright compliant score to listen to and adjudicate a performance. No exceptions. Due to copyright law the use of photocopies by a judge is prohibited. [See C&CR Section 1104 and Section 1108(h)(4).] Copyright compliant downloads must have documentation indicating such. Please understand that if you arrive at the contest site without a score that is compliant with US Copyright Law and UIL Regulations you will have to make your own arrangements to secure a compliant score or forfeit your opportunity to perform. **UIL EVENT STAFF AND SITE HOSTS WILL NOT HAVE ANY MUSIC OR PHOTOCOPY ACCESS.**

**DIRECTOR HOSPITALITY AREA:** HHS room G104; KLMS room 105

**CONTESTANT CHECK-IN:** There is NO contestant check-in at the contest office. Instruct all students to go directly to their performance room as early in the day as possible to check-in with the room monitor.

**MASTER SCHEDULE:** Each account holder may access their schedule by logging into your account at: [www.texasmusicforms.com](http://www.texasmusicforms.com). With a contest this size it is impossible to avoid all schedule conflicts, especially if an accompanist has been overextended or incorrect/incomplete accompanist information was given upon registration.

**SCHEDULE CHANGE REQUESTS:** All schedule change requests must be processed in the contest office. Changes will be made if availability exists.

**PERFORMING EARLY** An event may be permitted to perform to its scheduled time under one of the following provisions:

1. The judge is running ahead of schedule and allows the event to perform early.
2. An open time or no-show (DNA) allows the event to perform early.

**CHANGING MUSIC:** Changes to music selections must be made in the contest office.

**CHANGING PERFORMERS IN AN ENSEMBLE:** Up to 50 percent of performers in an ensemble may be substituted from the performers who qualified at the region contest. These changes must be made in the contest office.

**MEMORY REQUIREMENTS:** All solos must conform to the UIL C&CR and PML memory requirements.

**APPAREL, PATCHES, AND PINS:** Available for purchase at each site.

**2023 HHS & KLMS Site Bandapp:** <https://band.us/n/a2ab8aZ9X2P4b>  
**Band App QR Code:**



FIELD HOUSE  
↑

Competition /Big Gym

Auxiliary /Small Gym

catetera

locker rooms

ROTC

BUS LOOP

AG105 Office AG107

P2  
F1

F101 F102 F103 F104 F105

F106 F107 F108 F109 F110

F111 F112 F113

D101 D102 D103 D104 D105

D106 D107 D108 D109 D110

D111 D112 D113

B101 B102 B103 B104 B105

B106 B107 B108 B109 B110

B111 B112 B113 B114 B115

P3 P4 P5 P6 P7 P8

A101 A102 A103 A104

Dance Drill

Choir

Aux. Band

Band Hall

Art 2

Art 3

G101 G102 G103 G104 G105

E101 E102 E103 E104 E105

E106 E107 E108 E109 E110

E111 E112 E113

C101 C102 C103 C104 C105

C106 C107 C108

AP C100

Teach lounge

Conf Rm

Book room

Front Off.

Library

CONF ROOM

CONF ROOM

AP

AP

AP

AP

AP

AP

AP

AP

AP

AP

PAC

Stage

loading

BBOX

Partial view of building  
from the east  
and west

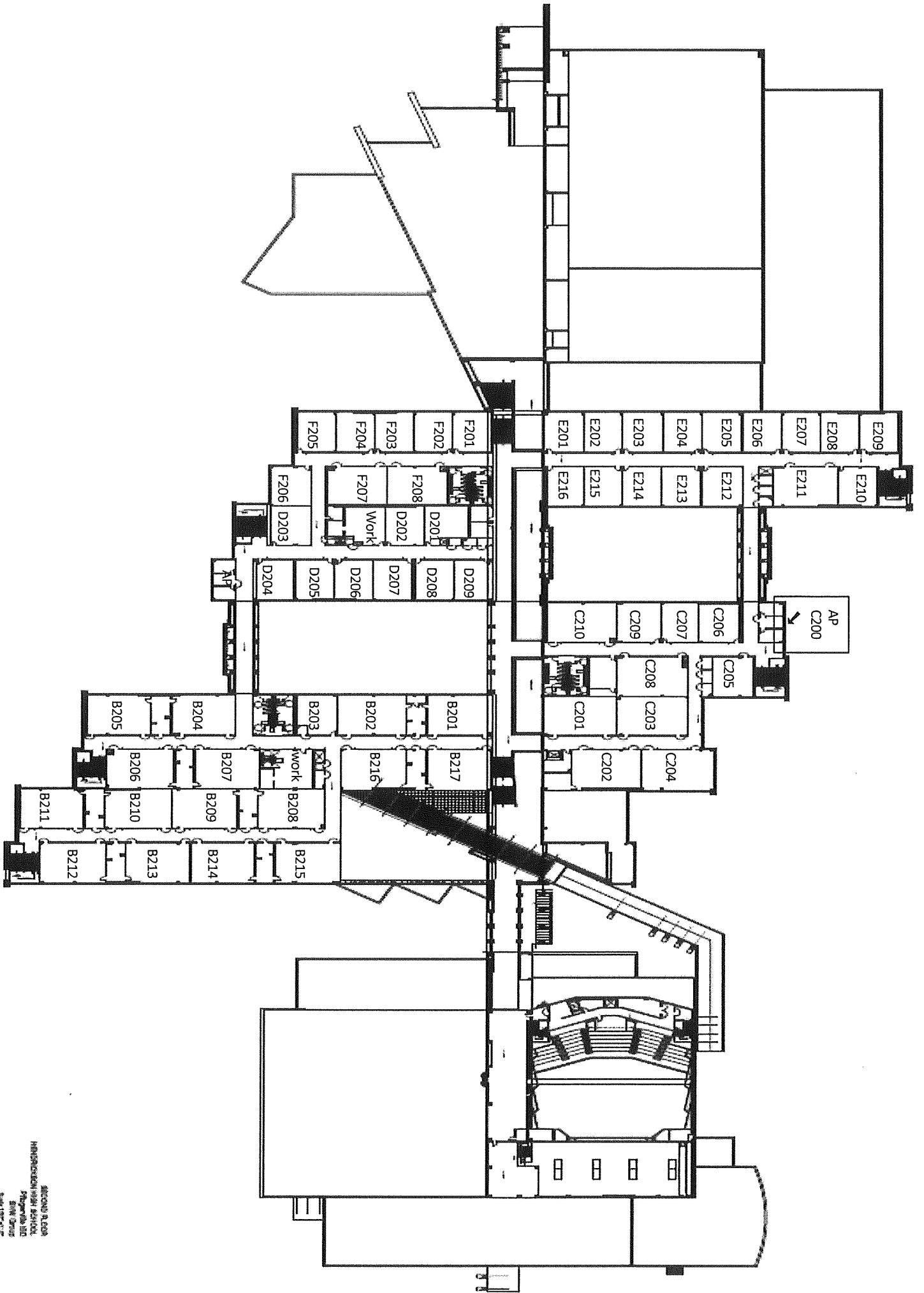

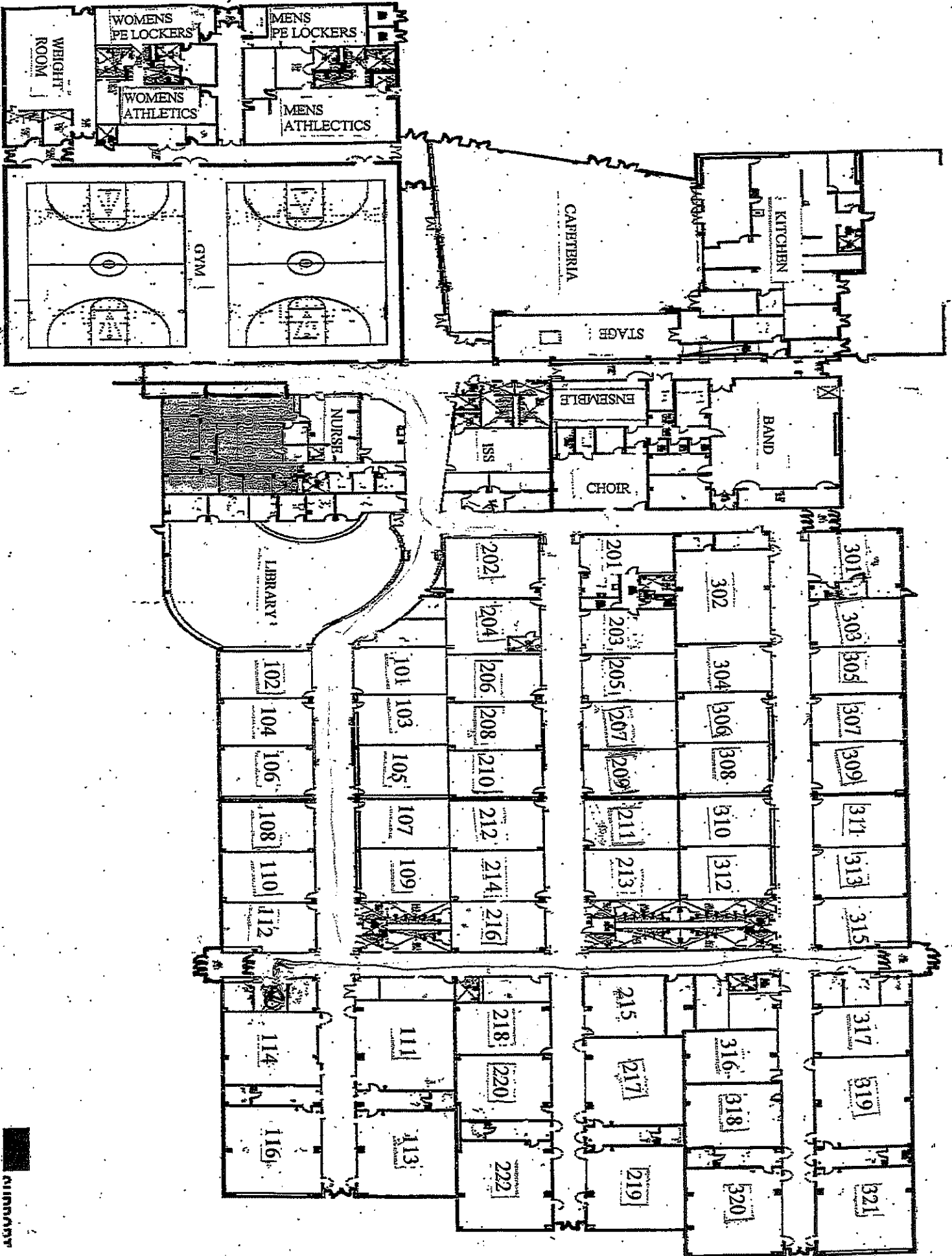

AIRWAY



# Hendrickson HS Percussion Layout

Front of School

Black Box Foyer

PAC Foyer

PAC Stage

A+ Federal Credit Union

PAC Foyer Staging Area

HHS Provided Equipment  
Instruments  
4.3 Marimba / 3.5 Xylophone

PAC Staging Area

Black Box Foyer Staging Area

Cafeteria/Small Gym

Dance Hall Staging Area

PAC Staging Area

Dance Hall

restrooms

P.E. Rm. Staging Area

Band Hall Staging Area

Percussion Ensemble Rm.

Band Hall Staging Area

Aux Hall Staging Area

Aux Hall

Band Hall

Percussion Equipment Entrance/Access

Band Lot  
(Loading/Warm-Up)

