



# UNIVERSITY INTERSCHOLASTIC LEAGUE

REGIONAL MEET HANDBOOK  
SPRING 2021

REGION IV  
SAN ANTONIO, TEXAS

***2021 UIL REGION  
IV  
SPRING MEET***

**ACADEMIC EVENTS**

**5-A AND 6-A**

**APRIL 16-17 – 5A ONE ACT PLAY**

**APRIL 14-15 - 6A ONE ACT PLAY**

**APRIL 16-17 - ACADEMIC CONTEST**

**ATHLETIC EVENTS**

**5-A AND 6-A**

**APRIL 19-22**

**GOLF**

**APRIL 27-28**

**TENNIS**

**APRIL 23-24**

**TRACK**

UIL REGION IV SPRING MEET 6A & 5A  
MESSAGE FROM THE UIL SPING MEET DIRECTOR GENERAL

It is my privilege to welcome you to the 2021 University Interscholastic League Region IV Spring Meet and to San Antonio. The past fifteen months have been difficult ones. Covid-19 protocols are posted on the UIL website. Host school district guidelines will also be followed. Our priority this year is to protect the health and safety of participants, coaches, directors, and fans as best we can. So please know any last minute changes to Covid-19 protocols and host school district expectations will be posted on the websites listed below. However, we are an optimistic group and we are looking forward to the UIL Region IV Spring Meet and the opportunity to see some great performances by the students in Region IV. Thank you to all for the preparation you have made for this meet.

The Handbook of rules and guidelines for the Region IV Spring Meet will be posted on various websites. Please see that all coaches, directors, and administrators know that access to this information is on the UIL website and the Northside and North East ISD athletic and fine arts department websites. There will be no hard copies available.

The responsibility of running this event is taken seriously by all of us who are involved in an official capacity with the UIL Region IV Spring Meet. Our desire is to make certain each participant has an opportunity to perform to their maximum ability within the confines of the rules. Therefore, thank you to all workers and hosts for what you will do to make the UIL Spring Meet in Region IV the best it can be.

Academic Director: Kandi King, retired  
Assistant Academic Director: Joseph Johnson, North East ISD  
Athletic Director: Rudy De Los Santos, Harlandale ISD  
Assistant Athletic Directors: Track - Kelly Parker, NEISD  
Tennis - Patrick Johnson - North East ISD  
Golf - Jay Govan, Northside ISD

Please make note of the event directors listed above. It is critically important for you to be aware of Zoom competition and how it is to be conducted. Thanks in advance to all coaches, directors and sponsors who will monitor events as needed to make certain we are able to conduct all activities in such manner as to meet the goals of the UIL. I am confident we in Region IV will rise up and make this one of our finest moments by overcoming any obstacle in our path.

Best wishes to all the contestants and coaches. We are looking forward to all individual and team performances in what promises to be another outstanding Spring Meet.

Jerry Comalander, Director General, UIL Region IV Spring Meet

## REGION IV SPRING MEET IMPORTANT COVID-19 NOTICE

1 - All Spring Meet events will be conducted according to the University Interscholastic League posted protocols for Covid-19 guidelines. Those guidelines can be found on the UIL website.

2 - Although at the posting of this notice Governor Abbott has lifted the requirement for face masks the choice will remain with the host school district for all events as to whether masks are required for competitors, coaches, directors, sponsors, workers, and spectators.

3 - All of the listed people in item 2 will be expected to check the posted requirements in the Handbook which will be continually updated on the Northside ISD, the North East ISD, and the UIL websites.

4 - The Region IV Spring Meet staff is most appreciative to the host school districts for taking on the tremendous responsibility of providing the use of their facilities. We thank you as competitors, coaches, directors, sponsors, workers, and spectators for your cooperation in being respectful of their guidelines and those of the UIL.

5 - Any questions should be directed to the listed Director in the Handbook for each event.

Jerry Comalander  
REGION IV SPRING MEET DIRECTOR GENERAL



# TABLE OF CONTENTS

UIL Region IV, Conferences AAAAA and AAAAAA



Letter from Director General .....	i
Region IV AAAAA and AAAAAA Contest Directors & Staff.....	1
Region IV Academic Directors and Speech Advisory Committees .....	5
Fee Information.....	8
Academic Information.....	11
Academic Events Schedule.....	24
5A One Act Play.....	28
Golf Information.....	44
Tennis Information.....	46
Track Information.....	57
5A & 6A District Alignment.....	87

# CONTEST DIRECTORS AND STAFF

## 2019-2020 UIL REGION IV ACADEMIC, ATHLETIC AND OAP

### DIRECTOR GENERAL

**Jerry Comalander**

[j-mcoma@satx.rr.com](mailto:j-mcoma@satx.rr.com)

15827 Eagle Cliff  
San Antonio, TX 78232

PH: 210-415-0002

ASSISTANT TO DIRECTOR GEN.

**Teresita Gonzalez**

[teresita.gonzalez@nisd.net](mailto:teresita.gonzalez@nisd.net)

Northside ISD Athletic  
Department  
8400 N Loop 1604 W  
San Antonio, TX 78249

PH 210-397-7535

FAX 210-558-3876

### ATHLETIC DIRECTOR

**Rudy De Los Santos**

[rudy.dls@yahoo.com](mailto:rudy.dls@yahoo.com)

Harlandale ISD, retired  
1201 96<sup>th</sup> Street  
San Antonio, TX 78214

PH: 210-488-2349

### TRACK MEET DIRECTOR

KELLY PARKER

[kparker2@neisd.net](mailto:kparker2@neisd.net)

North East ISD, Director  
Athletic Department  
12002 Jones Maltsberger  
San Antonio, TX 78216

PH: 210-392-3589

### TRACK MEET ASST. DIRECTOR

TIMOTHY WOODS

[twoods1@neisd.net](mailto:twoods1@neisd.net)

12002 Jones Maltsberger  
San Antonio, TX 78216

PH: 210-356-6930

### Track Referees

Tom Nalepa    Bob Majek

Don Griffith    Jeff Kelso

### TENNIS DIRECTOR

**Patrick Johnson**

[pjohns2@neisd.net](mailto:pjohns2@neisd.net)

12002 Jones Maltsberger  
San Antonio, TX 78216

PH 210-356-6921

FAX 210-491-6135

### GOLF DIRECTOR

**Jay Govan**

[jay.govan@nisd.net](mailto:jay.govan@nisd.net)

Regional Golf Director  
Northside ISD Athletic Dept.  
8400 N Loop 1604 W  
San Antonio, TX 78249

PH: 210-397-7599

FAX 210-558-3876

## **ACADEMIC DIRECTORS**

### **KANDI KING**

[mamakjking@yahoo.com](mailto:mamakjking@yahoo.com)

6058 Gaelic  
San Antonio, TX 78240

Ph.: 210-641-6761  
Cell: 210-885-5030

### **JOSEPH JOHNSON**

[jjohns@neisd.net](mailto:jjohns@neisd.net)

Asst. Director of Fine Arts  
North East ISD

Ph.: 210-407-0355  
Cell: 210-887-5646

## **ONE ACT PLAY DIRECTOR - 5A**

### **MICHAEL DOGGETT**

[mdogit@aol.com](mailto:mdogit@aol.com)

San Antonio, TX 78216

Ph. 361-676-6100

## **ONE ACT PLAY DIRECTOR - 6A**

### **RHONDA AMSTUTZ**

[rhonda.amstutz@laferiaisd.org](mailto:rhonda.amstutz@laferiaisd.org)

Harlingen, TX 78552

Ph. 956-792-6824

## **ONE ACT PLAY SCHOOL HOSTS**

SEE ONE ACT PLAY PAGES FOR INFORMATION

## **ACADEMIC EVENTS DIRECTORS**

*Gumecindo Laurel, Accounting*

*Weslaco East HS*

[glaurel@wisd.us](mailto:glaurel@wisd.us)

*Laura Maldonado, Accounting*

*Sharyland Pioneer HS*

[lmaldonado@sharylandisd.org](mailto:lmaldonado@sharylandisd.org)

*Guillermo Moreno, Com. Appl.*

*Alexander HS*

[guillermom@uisd.net](mailto:guillermom@uisd.net)

*Anthony Campos, Com. Appl.*

*Economedes HS*

[a.campos@ecisd.us](mailto:a.campos@ecisd.us)

*Galen Goodreau Com. Science*

*Vandegrift HS*

[galen.goodreau@leanderisd.org](mailto:galen.goodreau@leanderisd.org)

*Berry Nall, Com. Science*

*Roma HS*

[bnall@romaisd.com](mailto:bnall@romaisd.com)

*Chris Miffllin, Current Issues & Events*

*Madison HS*

[cmiffll1@neisd.net](mailto:cmiffll1@neisd.net)

<i>Stephanie Carrier, Current Issues &amp; Events</i>	<i>Churchill HS</i>	<a href="mailto:scarri@neisd.net"><u>scarri@neisd.net</u></a>
<i>Brenda Slaton Journalism</i>	<i>San Antonio Christian</i>	<a href="mailto:BrendaKaySlaton@gmail.com"><u>BrendaKaySlaton@gmail.com</u></a>
<i>Sue Jett, Journalism</i>	<i>Retired</i>	<a href="mailto:suecjett@yahoo.com"><u>suecjett@yahoo.com</u></a>
<i>TBA, Lit. Crit</i>		
<i>TBA, Lit. Crit.</i>		
<i>Maria Moncerrat Reyna, Ready Writing</i>	<i>Acad. of Health Science Professions &amp; Stem</i>	<a href="mailto:moncyreyna@aol.com"><u>moncyreyna@aol.com</u></a>
<i>JoAnna Hinojosa, Science</i>	<i>Robert Vela HS</i>	<a href="mailto:j.hinojosa@ecisd.us"><u>j.hinojosa@ecisd.us</u></a>
<i>Billie Lashua, Social Studies</i>	<i>Flour Bluff HS</i>	<a href="mailto:blashua@flourbluffschools.net"><u>blashua@flourbluffschools.net</u></a>
<i>Brenda Hernandez, Social Studies</i>	<i>Edinburg North HS</i>	<a href="mailto:br.hernandez@ecisd.us"><u>br.hernandez@ecisd.us</u></a>
<i>Lila Torguson, Spelling &amp; Vocab.</i>	<i>Sharyland HS</i>	<a href="mailto:ltorguson@sharylandisd.org"><u>ltorguson@sharylandisd.org</u></a>
<b><u>Math Events</u></b>		
<i>Todd Steckler</i>	<i>Acad. of Health Science</i>	<a href="mailto:t.steckler@southtexascollege.edu"><u>t.steckler@southtexascollege.edu</u></a>
<i>Juan Esparza</i>	<i>McAllen Memorial HS</i>	<a href="mailto:juan.esparza@mcallenisd.net"><u>juan.esparza@mcallenisd.net</u></a>
<b><u>SPEECH EVENTS</u></b>		
<i>Preston Stolte, Speech Tech Director</i>	<i>Churchill HS</i>	<a href="mailto:s.stolte33@gmail.com"><u>s.stolte33@gmail.com</u></a>
<i>Preston Stolte, LD Debate</i>	<i>Churchill HS</i>	<a href="mailto:s.stolte33@gmail.com"><u>s.stolte33@gmail.com</u></a>
<i>Rebecca Sibley, Poetry</i>	<i>MacArthur HS</i>	<a href="mailto:rsible@neisd.net"><u>rsible@neisd.net</u></a>

<i>Melissa Boley, Poetry</i>	<i>NISD</i>	<a href="mailto:melissa.boleynisd.net"><u>melissa.boleynisd.net</u></a>
<i>Hiram A. Orozco, Prose</i>	<i>Lamar Academy</i>	<a href="mailto:hiram.orozco@mcallenisd.net"><u>hiram.orozco@mcallenisd.net</u></a>
<i>Salena Pereida, Prose</i>	<i>Gregory-Portland HS</i>	<a href="mailto:spereida@g-pisd.org"><u>spereida@g-pisd.org</u></a>
<i>Gina Lozano, Persuasive</i>	<i>Hays HS</i>	<a href="mailto:lozanog@hayscisdn.net"><u>lozanog@hayscisdn.net</u></a>
<i>Kendall Reischling, Persuasive</i>	<i>Boerne Champion HS</i>	<a href="mailto:kendall.reischling@boerneisd.net"><u>kendall.reischling@boerneisd.net</u></a>
<i>Tara Ward, Informative</i>	<i>Marshall HS</i>	<a href="mailto:tara.ward@nisd.net"><u>tara.ward@nisd.net</u></a>
<i>Tessa Gregory, Informative</i>	<i>Medina Valley HS</i>	<a href="mailto:Tessa.Gregory96@gmail.com"><u>Tessa.Gregory96@gmail.com</u></a>

## **2021 UIL ACADEMIC REGIONALS**

### **POD SITES/SITES' DIRECTORS**

Pod 1	Cedar Park	Josh Marsh
Pod 2	Churchill	Stephanie Carrier
Pod 3	Boerne Champion	Brett Moseley
Pod 4	Laredo Alexander	Guillermo Moreno
Pod 5	Flour Bluff	Pam Pailes
Pod 6	Del Rio	Terri Arons
Pod 7	La Joya Acad. for Health Science	Todd Steckler
Pod 8	Harlingen South	Eddy Cavazos Marcos Almanza

## Region IV

### 2020-21 Regional Speech Advisory Committee Conference 5A

**Dawn Azbill-Smith**

Cedar Park High School  
512-570-1200  
dawn.azbill-smith@leanderisd.org

**Tammy Ballard**

Liberty Hill High School  
512-260-5500  
tballard@libertyhill.txed.net

**Vanessa Chapa**

McAllen High School  
956-632-3100  
Vanessa.chapa@mcallenisd.net

**Davy Holmes**

Dripping Springs High School  
512-858-3279  
davy.holmes@dsisdtx.us

**Dustin Hurley**

Medina Valley High School  
830-931-2243  
dustin.hurley@mvid.org

**Johnny Trillayes**

PSJA Southwest High School  
956-599-5849  
johnny.trillayes@psjaisd.us

**Bryan Winn**

Victoria East High School  
361-788-2820  
bryan.winn@visd.net

**Region IV**

**2020-21 Regional Speech Advisory Committee  
Conference 6A**

**Gina Lozano**

Hays High School

512-268-2911

[gina.lozano@hayscisd.net](mailto:gina.lozano@hayscisd.net)

**Preston Stolte**

Winston Churchill High School

512-965-2209

[s.stolte33@gmail.com](mailto:s.stolte33@gmail.com)



**MAKE CHECKS PAYABLE TO:**

**UIL REGION IV**

**ALL CHECKS SHOULD BE MAILED**

**TO:**

**DIRECTOR GENERAL, NISD**

**ATHLETICS**

**8400 N LOOP 1604 W**

**SAN ANTONIO, TX 78249**

**UIL REGION IV HANDBOOK LINK:**

**<https://nisd.net/athletics/sites/athletics/files/Pages/Home-Page/UIL2021.pdf>**

# FEE INFORMATION

The District Chair sends two (2) checks for the total entries for their District (excluding One Act Play):

Academic Fees = **\$2,585** send immediately upon the completion of the last District Academic Event  
**Plus**

Districts that hosted Area Track please pay:

Athletic Fees = **\$5,140** + **\$105** for each boy and girl golf medalist if not a member of a team advancing to Regional Meet. Usually 2 boys and 2 girls.  
 Send immediately upon completion of the last District Athletic Event, including Golf, Tennis and Track

**OR**

Districts that only hosted District Track please pay:

Athletic Fees = **\$3,780** + **\$105** for each boy and girl golf medalist if not a member of a team advancing to Regional Meet. . Usually 2 boys and 2 girls.  
 Send immediately upon completion of the last District Athletic Event, including Golf, Tennis and Track

\*\*\*\*\*See explanation below for Athletic check\*\*\*\*\*

Individual school is responsible for sending one (1) check for their ONE ACT PLAY entry:

One Act Play **\$850** Send immediately following qualification for the Regional OAP

**Athletic Fees explanation:**

**6A Districts – Do not send Golf Fees. See McAllen ISD for 6A Golf Fees.**

**Districts that held AREA Track & Field pay:**

<u>PRIMARY (Hosting) DISTRICT</u>		<u>SECONDARY (Competing) DISTRICT</u>	
Golf	\$2,100	Golf	\$2,100
Tennis	\$320	Tennis	<u>\$320</u>
Area Track & Field	<u>\$2,720</u>	Total	\$2,420
Total	\$5,140		

**OR**

**Districts that held DISTRICT Track & Field pay:**

Golf	\$2,100
Tennis	\$320
District Track & Field	<u>\$1,360</u>
Total	\$3,780

All checks payable to: **UIL Region IV**

All checks mailed to: Director General, NISD Athletics  
 8400 N Loop 1604 W  
 San Antonio, TX 78249

**Reminder:**

***Contestants will not compete unless all fees have been paid and received by the Director General prior to the Regional Meet.***

**2021  
FEE SCHEDULE**

**Explanation/breakdown of fees**

**ACADEMIC**

**Academic Total:** \$2,585

**ATHLETICS**

**Golf 6A**

2	girls golf teams (5 girls per team) \$20 entry + \$85 green fee each (36 holes)	1,050
2	boys golf teams (5 girls per team) \$20 entry + \$85 green fee each (36 holes)	1,050
<b>Golf Total</b>		<b>\$2,100</b>

\*\*Add \$105 for EACH golf medalist if not a member of a team advancing to Regionals

**Tennis**

4	mixed doubles @ \$20 each	\$ 80
4	girls tennis doubles @ \$20 each	80
4	boys tennis doubles @ \$20 each	80
2	girls tennis singles @ \$20 each	40
2	boys tennis singles @ \$20 each	40
<b>Tennis Total</b>		<b>\$320</b>

**Area Track And Field**

56	boys track and field participants @ \$20 each	\$1,120
56	girls track and field participants @ \$20 each	1,120
4	girls – 400,800 & 1600 meter relays @ \$20 each	240
4	boys – 400, 800 & 1600 meter relays @ \$20 each	240
<b>Area Track And Field Total</b>		<b>\$2,720</b>

**OR**

**District Track And Field**

28	boys track and field participants @ \$20 each	\$560
28	girls track and field participants @ \$20 each	560
2	girls – 400,800 & 1600 meter relays @ \$20 each	120
2	boys – 400, 800 & 1600 meter relays @ \$20 each	120
<b>District Track And Field Total</b>		<b>\$1,360</b>

**Athletics Total includes Area Track & Field Fee: \$5,140**

**OR**

**Athletics Total includes District Track & Field Fee: \$3,780**

\*\*See explanation of Athletic fees on Fee Information\*\*

# **ATTENTION ALL REGION IV 5A/6A ACADEMIC EVENTS' SPONSORS**

THE FOLLOWING PAGES INCLUDE  
IMPORTANT INFORMATION FOR ALL  
SPONSORS AND COMPETITORS. PLEASE  
READ THROUGH THEM CAREFULLY AND  
THOROUGHLY.

SHOULD YOU HAVE ANY QUESTIONS,  
PLEASE DO NOT HESITATE TO CONTACT  
KANDI KING, ACADEMIC CO-DIRECTOR AT  
[mamakjking@yahoo.com](mailto:mamakjking@yahoo.com)

IN THE CASE OF ANY LAST MINUTE OR  
EMERGENCY ISSUES, CALL KANDI KING AT  
210-885-5030.

## **IMPORTANT TO READ**

### **UIL REGION IV 5A/6A COACH/ CONTESTANT INSTRUCTIONS**

#### **Contestants –**

- With the exceptions of Computer Science and the speech/debate events, all tests will be taken at the designated testing site (pod).
  - Computer Science testing will be done from each home campus. Students must have internet access for video conferencing.
  - LD Debate and speech events will be done from home (not home campus). Students must have internet access, a Tabroom.com account, and video conferencing for synchronous presentations.
- Students are encouraged to bring laptops for Journalism and Ready Writing essays. Students may still handwrite essays. The student will submit essays to cloud folder for grading. All handwritten essays will be scanned by proctor and uploaded to cloud folder for grading.
- The traditional testing format will be used for all the tests.
- Students will be are not permitted to wait between testing periods in the building. Students should leave the campus once they are done testing for the day.

#### **Coaches –**

- All coaches should check in with the Site Director upon arrival.
- The Site Director will assign proctoring and grading duties to coaches for each event.
- The Event Tabroom (Zoom Meeting) will start 30 minutes prior to the test. Coaches are to use the tabroom for all communications regarding the event. Coaches should have a Zoom account to access the tabroom.
- Coaches assigned to proctoring will be given material and instructions by the Site Director.
- The Site Director will give the proctor and grader the link to the Event folder. All tests will be scanned and uploaded to the Event Folder.
- Proctors and graders will enter the student's answer into a Google answer sheet form for automatic grading of multiple-choice tests (CE&I, Lit Crit, Math, Science, and Social Studies).
- ALL event coaches are expected to help with grading.
  - The graders will grade the tests taken at the site and then grade the assigned location of another pod's tests as a second grading.
  - If there is a discrepancy between the first and second grading, the Event Director will be notified and grade the test a third time for a final determination.
  - The graders will only have to grade the multiple-choice tests taken at the site for verification.

# Region IV Contest Communications Structure

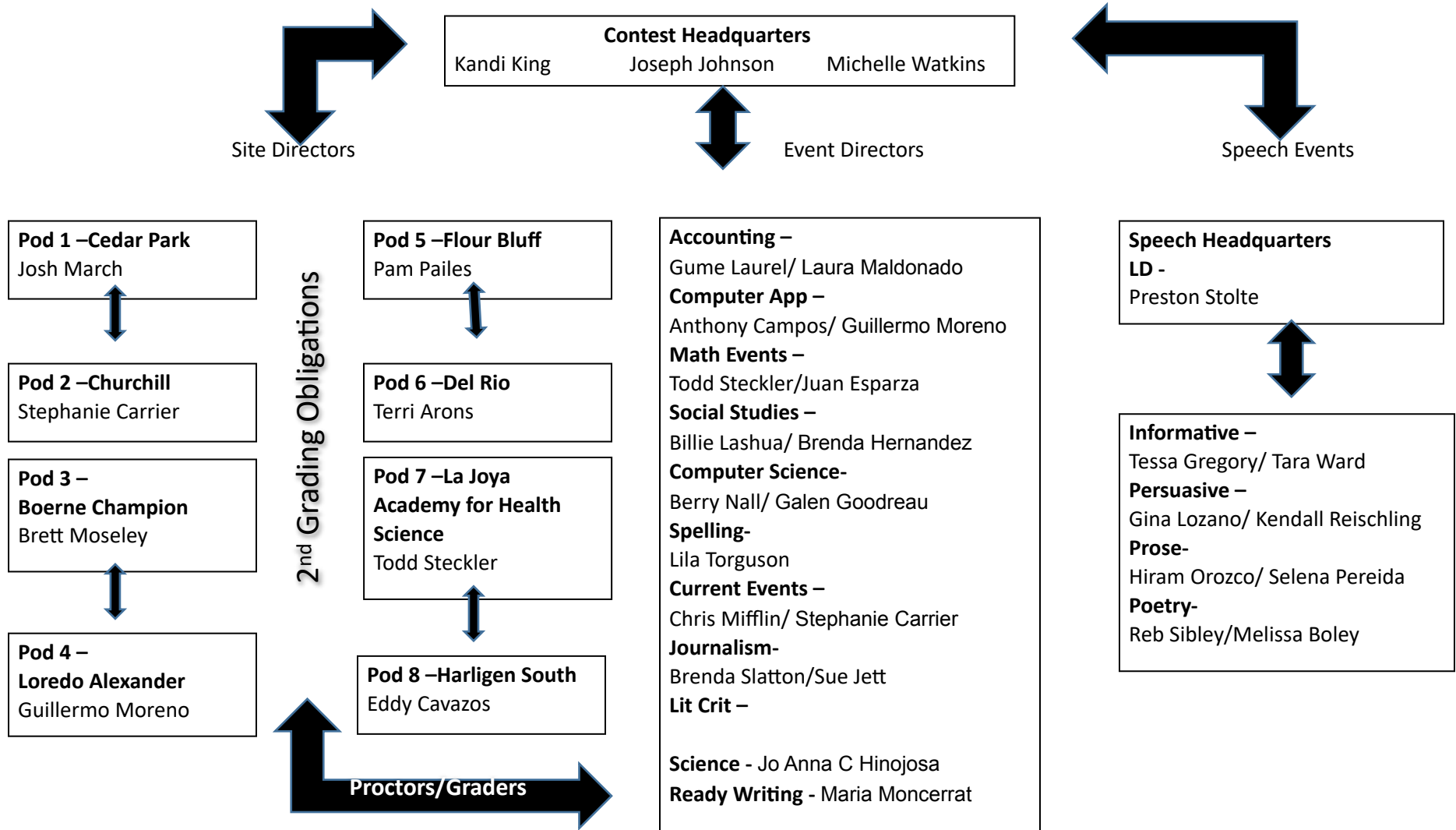

### Event Contact Information

Event tabrooms will start 30 minutes before the contest and remain open until verification is completed. Journalism and Ready students will have direct access to submitting tests to the Event Folder. Proctors and Coaches should submit testing material in all other events.

<b>Event</b>	<b>Directors</b>	<b>Zoom Meeting</b>	<b>Google Folder</b>
Accounting	Gume Laurel/ Laura Maldonado	<a href="#">Accounting Tabroom</a>	<a href="#">Accounting Folder</a>
Calculator Applications	Todd Steckler/Juan Esparza	<a href="#">Cal App Tabroom</a>	
Computer Applications	Anthony Campos/ Guillermo Moreno	<a href="#">Comp App Tabroom</a>	
Computer Science	Berry Nall/ Galen Goodreau	<a href="#">Comp Sci Tabroom</a> 211103	
Current Event	Chris Mifflin/ Stephanie Carrier	<a href="#">Current Events Tabroom</a>	
Informative/Persuasive	Tara Ward/Kendall Reischling Tessa Gregory/ Gina A. Lozano	<a href="#">Extemp Tabroom</a>	
Journalism	Brenda Slatton/Sue Jett	<a href="#">Journalism Tabroom</a>	
Lincoln Douglas Debate	Preston Stolte	<a href="#">Debate Tabroom</a>	
Lit Crit			
Mathematics	Todd Steckler/Juan Esparza	<a href="#">Math Tabroom</a>	
Number Sense	Todd Steckler/Juan Esparza	<a href="#">Number Sense Tabroom</a>	
Poetry/Poetry	Reb Sibley/Melissa Boley	<a href="#">Prose/Poetry Tabroom</a>	<a href="#">Poetry Folder</a> <a href="#">Prose Folder</a>
Ready Writing	Hiram Orozco/ Selena Pereida Maria Moncerrat	<a href="#">Ready Writing Tabroom</a>	
Science	Jo Anna C Hinojosa	<a href="#">Science Tabroom</a>	
Social Studies Spelling	Billie Lashua/ Brenda Hernandez Lila Torguson	<a href="#">Social Studies Tabroom</a> 5Y1Nyp <a href="#">Spelling Tabroom</a>	

Documentation must be submitted into the folders below by 4 pm on 4/15

# Proctoring and Grading Instructions

All coaches must check in the site's headquarters upon arrival for proctoring and grading assignments.

## Non –Multiple Choice Tests

Accounting/Computer App/NS/Cal  
App/Spelling

1. Site Director will deliver testing material to the Proctor.
2. Proctor conducts Test
3. Proctor Scans and uploads tests to Event Folder
4. Site Director will hand out answer keys to graders with instructions that graders cannot grade their own students.
5. Graders will grade tests at location for 1<sup>st</sup> grading and grade partnered pod's test for verification. (1/2, 3/4, 5/6, 7/8)
6. After confirming with partnered pod, the second grader will send scores to the Event Director.
7. If there is a discrepancy between scores, Event Director will grade the test for the 3<sup>rd</sup> verification.
8. Event Director will submit scores to Main Headquarters once all sites have verified the scores.

## Event Folder Design

Each Event will have a shared Google Folder to exchange verification.

## Multiple Choice Tests

Comp Sci/ Current Events/ Lit Crit/ Math/  
Science/ Social Studies

1. Site Director will deliver testing material to the Proctor.
  2. Proctor conducts Test
  3. Proctor scans and uploads test including essays to Event Folder
  4. Proctor and Graders enter answers into the Google Answer Sheet Form.
  5. Site Director will hand out answer keys.
  6. Graders will grade tests at location.
  7. Event Directors will send out results for graders to verify against their scores and resolve any discrepancies.
  8. Event Director will submit scores to Main Headquarters once all sites have verified the scores.
- \*Computer Sci – students will submit answer directly to grading system. Step 4 is not needed.

## Judged Tests

Journalism/ Ready Writing

1. Site Director will deliver testing material to the Proctor.
2. Proctor conducts tests.
3. Handwritten essays will be scanned and uploaded to the Event Folder by the proctor.
4. Essays taken on computers will be uploaded directly to the Events Folder.
5. Event Director will transfer all tests to Judge Folder for grading.
6. Event Director will place all grading material back into the events folder for verification.

testing material for grading and



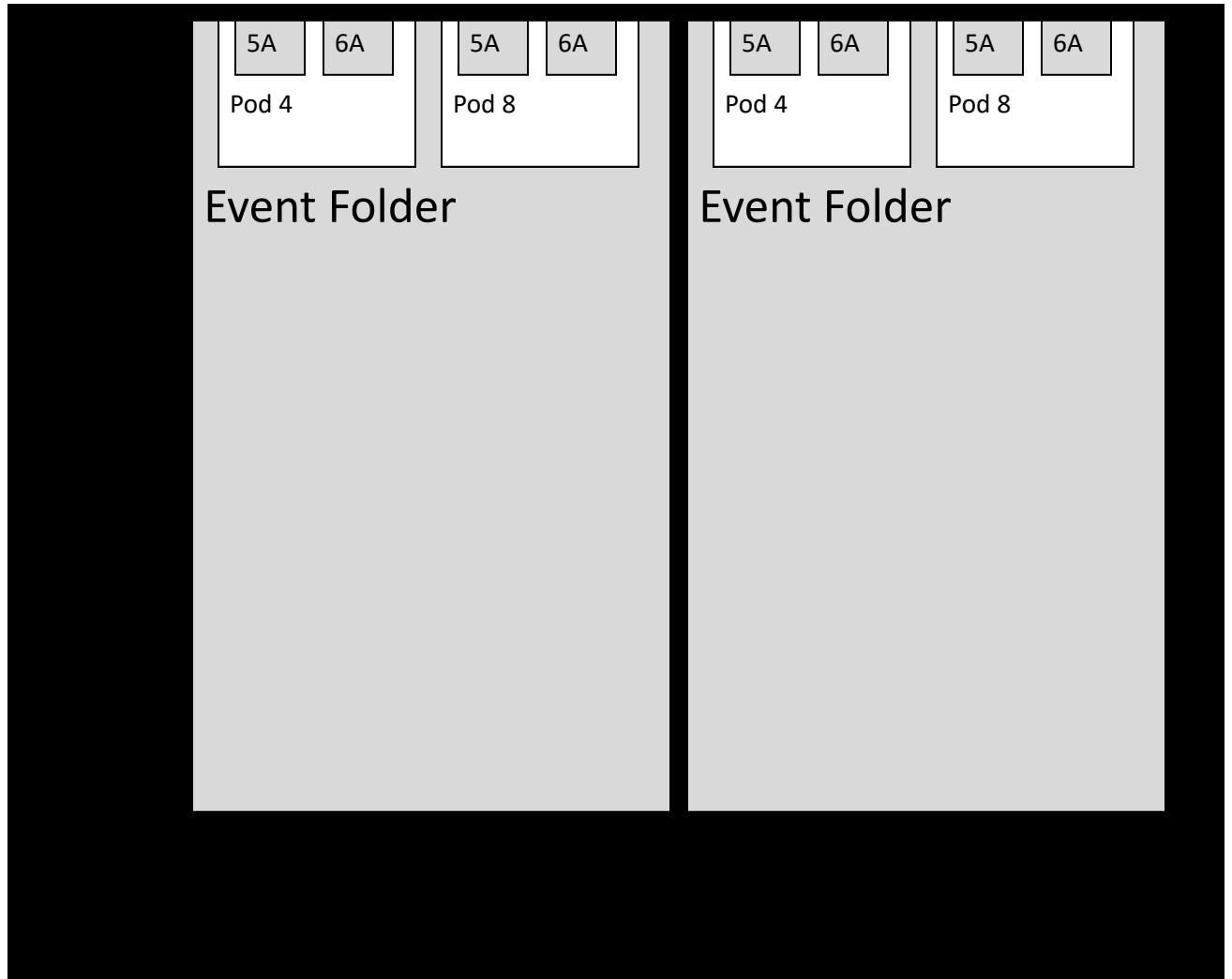

**PLEASE NOTE:  
IMPORTANT JUDGE REQUIREMENTS FOR  
SPEECH AND DEBATE EVENTS  
FOR THE 2021 REGION IV 5A/6A ACADEMIC MEET**

**JUDGING REQUIREMENTS FOR SPEECH EVENTS**

**Each UIL DISTRICT** sending competitors in Prose, Poetry, Informative, Persuasive and Lincoln-Douglas Debate must provide three judges:

- 1 judge qualified to judge Prose/Poetry prelims and finals.
- 1 judge qualified to judge Informative/Persuasive prelims and finals.
- 1 judge qualified to judge Lincoln-Douglas Debate prelims and elimination rounds.

The same person (judge) can judge both LD Debate and Informative/Persuasive. It is important to note that all rounds of LD Debate are on Friday so should one person serve as the judge, this person must be available for both days of competition at the Regional Meet.

Competing schools' speech/debate coaches are eligible to serve as judges.

**SUBMIT YOUR DISTRICT JUDGES WHO WILL BE FULFILLING THE  
REQUIREMENTS BY PROVIDING THE REQUESTED INFORMATION AT  
THE LINK:**

[Region IV District Judges](#)

The deadline for providing the required information is  
April 13, 2020 by 5 pm.

***Failure to provide judges may endanger the district's students' ability to compete  
at the Regional Academic Meet.***

Judges are required to report to each contest's Headquarters Zoom Room 15 minutes prior to roll call and check in with the Contest Directors.

Please see Region Meet Handbook for HQ room designations.

Judges from 5A Districts will judge 6A competitions;  
judges from 6A Districts will judge 5A competitions.  
No judge will judge his/her own competitors nor judge in his/her respective  
conference.

**Any changes to the District-submitted judges MUST be communicated to the Regional Director as soon as possible. Please email those changes to Kandi King at [mamakjking@yahoo.com](mailto:mamakjking@yahoo.com) If the change occurs within two days of the Regional Meet, call Kandi King at 210-885-5030.**

**Expenses:** All expenses of the district's judge or judges are the responsibility of the school and/or district.

**ACADEMIC COORDINATORS  
&  
SPEECH DIRECTORS**

**YOU ARE ASKED TO SUBMIT PROSE/POETRY  
DOCUMENTATION IN ADVANCE  
FOR ALL  
PROSE AND POETRY INTERPRETATION CONTESTS.**

**NOTE:**

The *UIL Constitution* allows for documentation to be checked in advance of an official UIL meet.

**Include both the official documentation form (<http://www.uiltexas.org/speech/oral-interp>) as well as the proper documentation.**

**Please label your documents with the following information:**

**District - Division**

**Student Name**

**Category**

**Coach's email address**

**Material will be submitted into the correct division's folder within the event's main folder. The links to the folders are below:**

[Poetry Folder](#)

[Prose Folder](#)

**Please submit by April 15, 2021 by 4 pm.**

Should you have any questions, please contact

Kandi King at

[mamakjking@yahoo.com](mailto:mamakjking@yahoo.com)

or

210-885-5030

IMPORTANT INSTRUCTIONS FOR VIRTUAL SPEECH &  
DEBATE PORTION OF 2021 REGION IV 5A/6A  
CONTESTS

FROM PRESTON STOLTE

UIL REGION IV 5A/6A SPEECH/DEBATE

TAB ROOM DIRECTOR

For UIL Region we will be using NSDA Campus as the video platform for our virtual competition rooms. The NSDA has a very extensive user guide available on their website for coaches to read if you would like, but in order to make this as easy as possible for you and your students, a short version of **important** things to know is listed below. Whether you have already used Campus this year or if this is your first time, please read all of the below information. If you have not set up a tabroom account already, please also read the attached document on how to do that/how to help your students create an account and add them to your roster. **ALL of these things must be done by APRIL 12 @ 6PM CST.**

The website for registering for regionals is: [www.5a6aRegion4.tabroom.com](http://www.5a6aRegion4.tabroom.com)

The website is now open for Registration

1) NSDA Campus is fully integrated with [tabroom.com](http://tabroom.com), there is no external website that students/judges need to visit to access their round. When students and judges receive the text/email blast

informing them of their upcoming debate round (i.e. when pairings are posted) they will log into [tabroom.com](http://tabroom.com), click on their email address in the top right-hand corner of the webpage, and on their homepage they will see their pairing that shows their opponent, side (aff/neg), and judge as well as a **blue camera icon**. If they click the camera button they are taken directly to their competition room (judges will also have a green 'start round' button that they will click to let the tabroom know the round has begun).

2) You must be using **google chrome** to access the NSDA Campus competition rooms. If it is your first time using campus, your web browser will say that the program needs your permission to use the camera/microphone; make sure you give your web browser permission to use the camera/mic. (This is just like when your iPhone apps ask for permission to use these things)

3) You should ALSO **require** your students to download the **Jitsi** app on their smartphone. Sometimes tech issues occur such as a computer microphone breaking or something and the fastest work around is to use your phone. Students will use the web browser on their phone to go to [tabroom.com](http://tabroom.com), login, and follow the same steps to get back to their virtual room, however, now when they click on the camera icon, it will open the Jitsi app. I've judged off of the Jitsi app this year so that I could see my entire computer screen and it works great with audio/video (but does drain battery quickly so have a phone charger available.) There are many things that can happen with tech (wifi goes out, computer freezes, water spills on keyboard, etc.) that having a backup plan in place is a good idea.

**THESE LAST TWO ARE THE MOST IMPORTANT— PLEASE READ:**

4) If you are competing from your school/on school WiFi OR if you have students using school provided devices, you **MUST** share the **attached document** with your school district's IT department and have them follow **ALL** of the steps to whitelist websites and open relevant ports. The most common issue is with IT departments that don't follow all the steps and then have students that are able to access tabroom/NSDA Campus/their virtual competition room, but their microphone and camera don't work and thus no one in the room can see or hear them.

5) Based on point 4, it is crucially important that you and your students test out the NSDA Campus platform to make sure you all can be seen/heard in the competition rooms.

- . To do this have your students go to separate rooms so that the only way they could see/hear each other is via computer.
- . Then you all should go to the following website (<https://campus.speechanddebate.org/>); this website will allow you to create a temporary competition room (last 2 minutes) for you and your students to test your technology/audio/video.
- . Type the name of your test room in the search bar that says "Enable Test Rooms" and then click the button that says "ENABLE". If you and your students all type the same thing, then you'll all go to the same test room (which is kinda essential so that you can check to see if you all can see/hear each other). The easiest way to do

this is to use your school name, so for example my students and I would all type "Churchill" in the box and then hit "ENABLE".

- Once you do that you all should click the button that says "Test Competition Room" and it should take you all to the same temporary test room.

- Turn on your microphone/video, click 'allow' when prompted to give permission to your browser to use microphone and video, and then have your students talk to each other so check that they can see/hear each other. If they **CANNOT** see and/or hear each other, you need to talk to your IT department.

That's it! The below document for IT departments should work if done correctly. It has worked for every school for which I have provided it.



# ACADEMIC EVENTS SCHEDULE

## Friday, April 16, 2021

### LINCOLN-DOUGLAS DEBATE

8:30 a.m. Roll Call                   AAAAA and AAAAAA                   VIRTUAL  
9:00 a.m. Round 1  
10:00 a.m. Round 2  
  
11:00 am - 12:30 pm Lunch Break  
  
12:30 p.m. Round 3  
1:45 p.m. Verification of LD contestants advancing to elims - Email will be sent via TabRoom that will include the advancing quarterfinalists and the break information. All challenges must be completed by 2 pm.  
  
2:15 pm    Quarters  
3:30 pm    Semis  
5:00 pm    Finals/Debate for 3rd place  
PLEASE NOTE: We will accelerate elimination rounds if possible.

### COMPUTER SCIENCE

4:00 p.m. Roll Call (Written test)   AAAAA and AAAAAA  
6:00 p.m. Roll Call (Hands-on)    AAAAA and AAAAAA

## Saturday, April 17, 2021

### NUMBER SENSE

8:00 a.m. Roll Call                   AAAAA and AAAAAA

### READY WRITING

8:00 a.m. Set Up                   AAAAA and AAAAAA  
8:30 a.m. Roll Call

### CURRENT EVENTS

8:00 a.m. Roll Call                   AAAAA and AAAAAA

### CALCULATOR

9:00 a.m. Roll Call                   AAAAA and AAAAAA

**COMPUTER APPLICATIONS**

9:15 a.m. Set Up AAAAA and AAAAAA  
10:00 a.m. Roll Call

**SPELLING**

11:30 a.m. Roll Call AAAAA and AAAAAA

**SCIENCE**

11:30 a.m. Roll Call AAAAA and AAAAAA

**ACCOUNTING**

11:30 a.m. Roll Call AAAAA and AAAAAA

**SOCIAL STUDIES**

2:00 p.m. Roll Call AAAAA and AAAAAA

**MATHEMATICS**

3:00 p.m. Roll Call AAAAA and AAAAAA

**LITERARY CRITICISM**

4:00 p.m. Roll Call AAAAA and AAAAAA

**JOURNALISM**

**COPY EDITING**

10:45 a.m. Roll Call AAAAA and AAAAAA

**NEWS WRITING**

11:30 a.m. Roll Call AAAAA and AAAAAA

**FEATURE WRITING**

12:30 p.m. Roll Call AAAAA and AAAAAA

**EDITORIAL WRITING**

2:00 p.m. Roll Call AAAAA and AAAAAA

**HEADLINE WRITING**

3:00 p.m. Roll Call AAAAA and AAAAAA

## **SPEECH AND DEBATE EVENTS**

### **POETRY AND PROSE**

8:30 a.m. Roll Call ~ *Prelims*

AAAAA/AAAAA

VIRTUAL

2:00 p.m. Roll Call ~ *Finals*

### **PERSUASIVE AND INFORMATIVE SPEAKING**

11:30 a.m. Roll Call ~ *Prelims* AAAAA and AAAAAA

VIRTUAL

4:00 p.m. Roll Call ~ *Finals*

# UIL ACADEMIC CONTEST SUBSTITUTE ELIGIBILITY FORM

SEND A COPY TO EACH AFFECTED CONTEST DIRECTOR.

School \_\_\_\_\_

School district \_\_\_\_\_ Conference (check one)  1A  2A  3A  4A  5 A

**SUBSTITUTIONS AND LATE ENTIRES** • See Section 902 in the UIL *Constitution and Contest Rules*. This form must be presented to the contest director before the contest begins. At the conclusion of the meet, the contest director must submit the substitution form or letters to the meet director to be filed with the school's original online entry information. Late entries will only be made if approved according to Section 902 for district competition or Section 903 for regional competition.

In the designated contest an **ORIGINAL** entry will be replaced by the following **SUBSTITUTE**:

CONTEST	ORIGINAL STUDENT	SUBSTITUTE STUDENT
_____	_____	_____

**AUTHORIZATION** • As the principal or designated administrator, I certify that the above student is eligible to compete in the contest named in accordance with Subchapter M of the Constitution and Contest Rules.

\_\_\_\_\_  
Designated administrator

\_\_\_\_\_  
Date

# UIL ACADEMIC CONTEST SUBSTITUTE ELIGIBILITY FORM

SEND A COPY TO EACH AFFECTED CONTEST DIRECTOR.

School \_\_\_\_\_

School district \_\_\_\_\_ Conference (check one)  1A  2A  3A  4A  5 A

**SUBSTITUTIONS AND LATE ENTIRES** • See Section 902 in the UIL *Constitution and Contest Rules*. This form must be presented to the contest director before the contest begins. At the conclusion of the meet, the contest director must submit the substitution form or letters to the meet director to be filed with the school's original online entry information. Late entries will only be made if approved according to Section 902 for district competition or Section 903 for regional competition.

In the designated contest an **ORIGINAL** entry will be replaced by the following **SUBSTITUTE**:

CONTEST	ORIGINAL STUDENT	SUBSTITUTE STUDENT
_____	_____	_____

**AUTHORIZATION** • As the principal or designated administrator, I certify that the above student is eligible to compete in the contest named in accordance with Subchapter M of the Constitution and Contest Rules.

\_\_\_\_\_  
Designated administrator

\_\_\_\_\_  
Date

# One-Act Play

REGION IV AAAAA

PRESENTS

REGIONAL ONE ACT PLAY

APRIL 16 AND 17, 2021

SOUTHWEST HIGH SCHOOL

11914 Dragon Ln, San Antonio, TX 78252 – 210-622-4500

Please email the contest manager [mdogit@aol.com](mailto:mdogit@aol.com) as soon as possible, after advancement from Bi-district, with school name, director's names/emails, cell numbers and play title. Email subject: 5A, Region IV OAP Contest.

## CONTEST MANAGER

Mike Doggett  
11245 Sir Winston St, Apt 301  
San Antonio TX 78216  
361-676-6100 (cell)  
[mdogit@aol.com](mailto:mdogit@aol.com)

## CONTEST HOST

Kary Driesse – [kdriesse@swisd.net](mailto:kdriesse@swisd.net)  
210-685-2848 (cell)  
210-622-4780 (classroom)

## HOST SCHOOL TECHNICAL DIRECTOR

Lane Walker – [walker7254@swisd.net](mailto:walker7254@swisd.net)

## CONTEST TECHNICAL DIRECTOR

Nathan Thurman – [nthurman6@alamo.edu](mailto:nthurman6@alamo.edu)

## CONTEST ADJUDICATORS

Melissa Utley 2911 Ellis Park San Antonio Texas, 78259	Tamera Young 24219 Invitation Oak San Antonio TX, 78261	Joel Garza 1201 E. University Drive Department of Communication, Liberal Arts College Edinburg, TX 78539
---	---	--

Please mail judge's script ASAP. **Do not require a signature.** Please mark your script with your school name and Region IV, 5A contest. Do not send a file which must be downloaded. Scripts must be the published copy with acting lines clearly indicated. Photocopies or manuscripts are only permitted if you show you have permission to copy. (Please include permission to copy with your script.)

## ENTRY FEES

Participating schools do not send entry fees to the Regional Director. **Each District Director will handle all entry fees for a district and then bill respective schools for the amount owed.** The entry fee for each one-act play is **\$850**. Entry fees must be in prior to competition.

District Chairpersons from these Districts are to collect all required fees from each school within their district. Individual schools shall **NOT** send fees to the Regional Director or the Fiscal Director. Please see the [regionivaaa.org](http://regionivaaa.org) for more details.

**By Noon the day after your Bi-District Contest (or as soon as the UIL opens the Mach Form:**

(1) **Region Contestant Entry form.** Make any necessary corrections to contestant entry, play and set information and additional directors via the UIL Spring Meet Entry System.

(2) **Submit the Region Contestant Entry Form.**

(3) Have you administrator sign the "Community Standards and Copyright Compliance Form". **This form shall NOT be signed until the administrator signing has seen the production as it will be performed at Region.**

Program information: You will be emailed a template to add your show information that will then be emailed to the contest manager. Mike Doggett ([mdogit@aol.com](mailto:mdogit@aol.com))

## COMMUNITY STANDARDS AND COPYRIGHT COMPLIANCE FORM

This form must be signed by your principal and presented to the Contest Manager before you begin the official rehearsal.

## BRING WITH YOU....

- Proof of royalty payment
- Publisher or author permission to cut (if performing a long play)
- UIL permission to produce plays not on the approved list, if applicable
- UIL approval for additions to the basic set, if any
- Official integrity script showing all cuts and approved adaptations
- Signed (Director) music log. ***You are required to note if the cue is from a copyrighted work, original music, or in the Public Domain.***
- Signed Standards and Copyright Compliance Form signed by your administrator
- Substitution Forms, if applicable.
- Approval from Publisher or Author allowing gender change of listed characters

## Directors' Meeting

The directors' meeting with the Adjudicators, contest manager and timekeepers will be remote via Zoom on Tuesday, April 13 at 8:30 pm. A link will be emailed to directors.

Be prepared to give starting and ending cues to the timekeepers.

**Schedule – Alternate Schedule C** - Each school will receive two hours to rehearse, perform, be critiqued and then leave campus.

**Friday, April 16**

**Show 1**

10:00 am -11:00 am Rehearsal  
11:15 am - 12:00 pm Perform/Strike  
12:00 am – 12:15 pm Critique/Clean  
12:15 pm leave contest site

**Show 2**

12:15 pm -1:15 pm Rehearsal  
1:30 pm – 2:15 pm Perform/Strike  
2:15 pm – 2:30 pm Critique/Clean  
2:30 pm leave contest site

**Show 3**

2:30 pm - 3:30 pm Rehearsal  
3:45 pm – 4:30 pm Perform/Strike  
4:30 pm – 4:45 pm Critique/Clean  
4:45 pm leave contest site

**Show 4**

4:45 pm - 5:45 pm Rehearsal  
6:00 pm – 6:45 pm Perform/Strike  
6:45 pm – 7:00 pm Critique/Clean  
7:00 pm leave contest site

**Saturday, April 17**

**Show 5**

10:00 am -11:00 am Rehearsal  
11:15 am - 12:00 pm Perform/Strike  
12:00 am – 12:15 pm Critique/Clean  
12:15 pm leave contest site

**Show 6**

12:15 pm -1:15 pm Rehearsal  
1:30 pm – 2:15 pm Perform/Strike  
2:15 pm – 2:30 pm Critique/Clean  
2:30 pm leave contest site

**Show 7**

2:30 pm - 3:30 pm Rehearsal  
3:45 pm – 4:30 pm Perform/Strike  
4:30 pm – 4:45 pm Critique/Clean  
4:45 pm leave contest site

**Show 8**

4:45 pm - 5:45 pm Rehearsal  
6:00 pm – 6:45 pm Perform/Strike  
6:45 pm – 7:00 pm Critique/Clean  
7:00 pm leave contest site

**Schools should arrive at least 30 minutes before scheduled rehearsal.** Give yourself travel time but if you arrive too early, you may have to wait on your bus awhile. **Please note C&CR Section 1033 (c) (2) (E) internal communication system.** If you do not wish to use the house system, then you must declare your communication system as part of the basic set and allow all companies to use it.

## **Performance Order**

Performance order was determined by blind draw. **A** and **B** shows are determined alphabetically by show title, excluding articles. Shows beginning with numbers are alphabetized by the first letter of the number word (3 = three, first letter T). **All shows run back to back.**

1. Bi-Districts 25/26 B
2. Bi-Districts 31/32 A
3. Bi-Districts 27/28 B
4. Bi-Districts 27/28 A
5. Bi-Districts 25/26 A
6. Bi-Districts 31/32 B
7. Bi-Districts 29/30 A
8. Bi-Districts 29/30 B

## **Audience**

Because of current safety protocols audience members will not be allowed this year.

## **Technical Information**

Please direct all technical and facilities questions to the host school technical director with a CC to the contest director.

Host School TD Lane Walker – [walker7254@swisd.net](mailto:walker7254@swisd.net)  
Contest TD Nathan Thurman – [nthurman6@alamo.edu](mailto:nthurman6@alamo.edu)

## **Stage Dimensions**

50' wide  
27'4" deep  
Mid stage traveler 15'3" upstage from main drape  
8'10" apron (not lit)  
Cyclorama or back black traveler available  
Stage diagram will be emailed to directors

## **Lights**

15 areas  
Blue, green and red wash  
ETC ION control board with 20x20 fader wing  
Light cues can be programmed before your rehearsal or run manually  
Instructions on how to program light cues early will be emailed to directors  
A light plot along with a picture of the light board will be emailed to directors



## **Sound**

Allen and Heath GLD 112 sound board

CD Player

Tape Player

Plug for Ipod/laptop - \*\*If you have a Iphone 7 or newer you will need to provide your own adapter.

## **UIL Set**

The contest site has a full UIL unit set with doors and windows.

## **Performance Safety Protocols**

Dressing room will not be provided, performers should be in costume and makeup upon arrival or fully ready to perform after your one hour rehearsal. Your performance will begin 15 minutes after your rehearsal.

**EVERYONE MUST WEAR MASKS AT ALL TIMES!** Even actors on stage during a performance. This is a Southwest ISD regulation.

The stage and unit set will be cleaned between performances.

## **Awards and Critiques**

The announcement of advancing plays and the presentation of awards will be done remotely via Zoom shortly after the final play is over and tabulations have been completed on Thursday evening. A text message will be sent out to all directors to alert them when the Zoom meeting will begin. Make sure the contest manager has you cell phone number. If you will not be at your home computer make sure the Zoom App is downloaded to your phone or tablet.

Because a Zoom meeting has a limited number of participants the live Zoom awards ceremony will only be for directors. You may record the ceremony and then share it with you company.

**BREAK A LEG!**

Mike Doggett

Contest Manager

PS: Please do not hesitate to contact me (call, text message or email) with any questions or concerns you might have. Text messages get faster replies.

# Southwest High School

---

UIL 2020

# The Stage

The following are the technical specifications of our acting space:

- 50' Proscenium
- Curtains: 4 legs, mid-stage traveler, backstage traveler, grand drape
- Stage Left Wing: Fly rig system, (1) exit door, stage management station with functional COM
- Stage Right Wing: Stage management station with functional COM, hallway entrance door, audience exit door, garage door for load-in
- See "SWHS Auditorium Stage Floor Plan" attachment in email for more specifics

# Lighting

- The stage is lit by three rows of five areas; 15 areas total.
- The light board is patched to satisfy the basic needs of 15 areas and the three color washes of RED, GREEN, and BLUE.
- Each individual color wash will have its own fader (16-18).
- Each area will have two faders for the purposes of separating TOP and FRONT light. Faders 1-15 will be corresponding area's front light; 21-35 are the area's TOP light.
- The cyclorama will be available for use with RGB lights programmed in the board.
- See 'SWHS Auditorium 15 Area Light Plot' - SLIDE #6

# Lighting

ETC ION w/ 20x20 Fader Wing



Each area is specifically labeled on the board itself.

Faders 1-15 = Area 1-15 Front Lights

Faders 21-35 = Area 1-15 Top Lights

Faders 16-18 = RedGreenBlue Color Wash    Faders 36-38 = RedGreenBlue CYC

# Sound Equipment

Allen and Heath GLD 112



Available playback systems include: CD player, tape player (yup...), and a plug for Ipod / laptop. If you have an iPhone 7 or newer then you will need to provide your own adapter.

# SWHS Light Plot

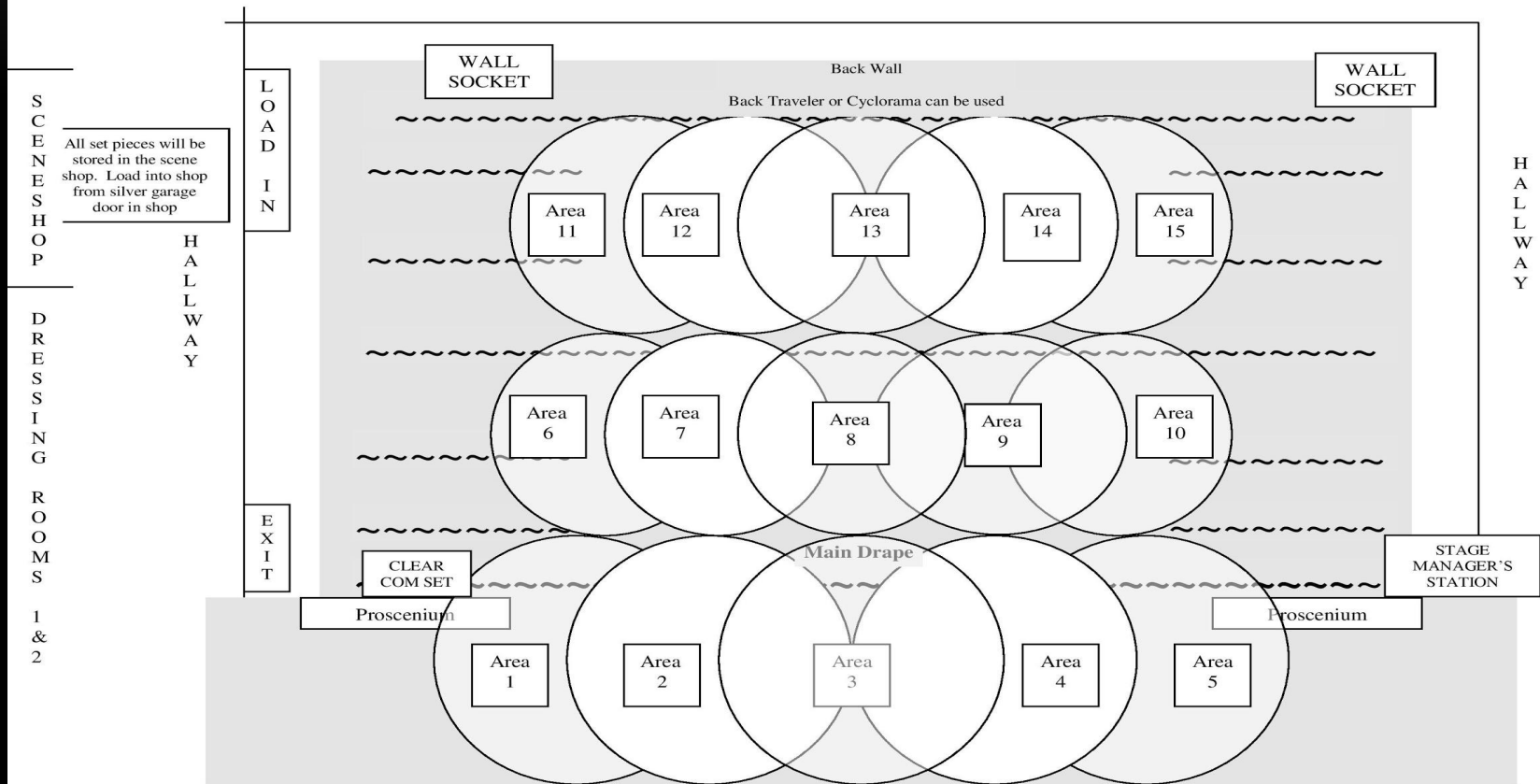

There is also a blue, green, and red wash

## Southwest High School Auditorium 15 Area Lighting Plan

The black orchestra pit cover will NOT be lit.

# SWHS STAGE DIMENSIONS

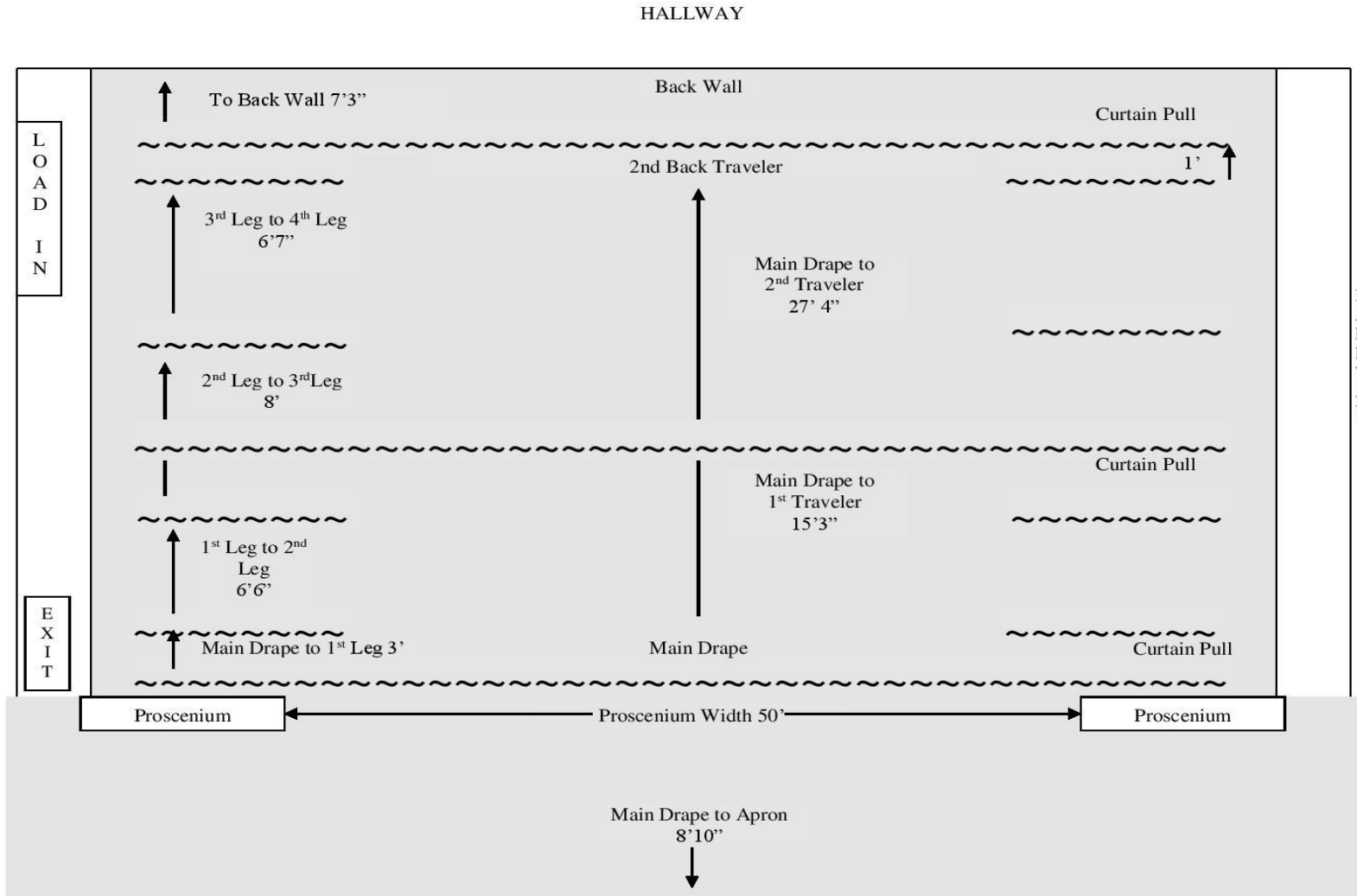

**Southwest High School Auditorium  
Stage Floor Plan**



# SITE MAP

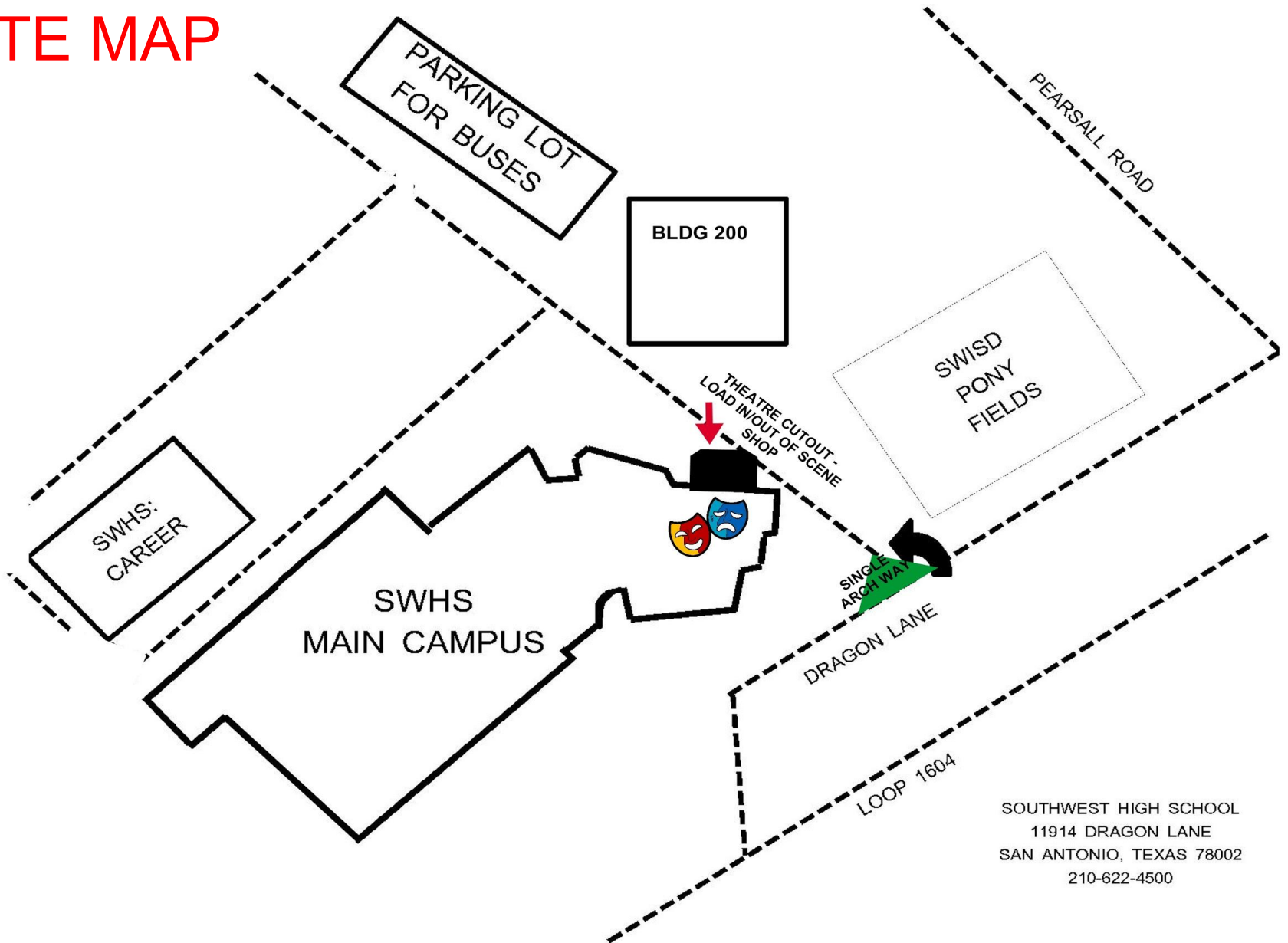

SOUTHWEST HIGH SCHOOL  
11914 DRAGON LANE  
SAN ANTONIO, TEXAS 78002  
210-622-4500

# AREA FOOD SOURCES

AUGUAS CALIENTES - GREAT MEXICAN FOOD/ GOOD PRICES (210)622-9766 -0.7 MILES AWAY

MC DONALDS/SONIC/BILL MILLER'S/ TACO BELL/ SUBWAYS/DOMINOS - OLD PEARSALL ROAD - 3.7 MILES AWAY

WHATABURGER / SUBWAYS - WEST LOOP 1604 SOUTH - 6.9 MILES AWAY

SUBWAY / PILOT PIZZA (GAS STATION) - INTERSTATE 35 - 1.9 MILES

WING STOP - 430 W LOOP 1604 N - 9.2 MILES AWAY

JACK IN THE BOX/ PANDA EXPRESS/ PIZZA HUT/ MC DONALDS/ LITTLE CEASARS- VALLEY HI DRIVE - 5.5 MILES AWAY

# AREA STORES - FOR EMERGENCIES

DOLLAR GENERAL - ON PEARSALL ROAD NEXT TO THE CAMPUS

WALMART - 7239 SW LOOP 410 - 4.2 MILES AWAY  
OR 11210 PORTRANCO ROAD - 9.1 MILES AWAY

HEB (GROCERY STORE) - 368 VALLEY HI DRIVE - 5.5 MILES AWAY

# EMERGENCY NUMBERS

IF YOU HAVE ANY QUESTIONS OR CONCERNS, PLEASE FEEL  
FREE TO CONTACT

KARY DRIESSE - SWHS THEATRE DIRECTOR -  
210-685-2848 (CELL)  
210-622-4780 (CLASSROOM)

SOUTHWEST HIGH SCHOOL - 210-622-4500

SOUTHWEST ISD MAIN NUMBER - 210-622-4300

**GOLF**  
**BOYS AND GIRLS**  
**REGION IV CONFERENCE 5A**  
Hyatt Hill Country Golf Club  
**APRIL 19-20, 2021 5A GIRLS**  
**APRIL 21-22, 2021 5A BOYS**

**TOURNAMENT FORMAT**

1. Progressive start off of two tees and will be paired in threesomes.
2. Highest team total will tee off first on the first day off of #1.
3. Medalists will be placed according to scores or spots available, and will be at the discretion of the Director.

AAAAA Girls - Monday, April 19 - 8:00 a.m. - Hyatt Hill Country Golf Club

AAAAA Girls - Tuesday, April 20 - 8:00 a.m. - Hyatt Hill Country Golf Club

AAAAA Boys - Wednesday, April 21 - 8:00 a.m. - Hyatt Hill Country Golf Club

AAAAA Boys - Thursday, April 22 - 8:00 a.m. - Hyatt Hill Country Golf Club

**Hyatt Hill Country Golf Club**

9800 Hyatt Resort Drive  
San Antonio, TX 78251  
Ph: (210)520-4040

**GOLF CONTINUED:**

In addition to the regular entry fee of \$20.00 per player, each player will pay an \$85.00 green fee for 36 holes which is a total of \$105.00 per golfer. This will be paid by your District Chairperson.

IMPORTANT: Add \$105.00 for each boys and girls golf medalist not on a team.

PRACTICE: One practice round of 18 holes only will be permitted. Sunday, April 18, 2021 will be the day set aside for the girls practice round. Tuesday April 20, 2021 will be the day set aside for the boys practice round, after 2:30 pm. If players choose to practice at the site on a weekend, they should only play 18 holes. Coaches need to make their practice round time by calling the golf courses.

There will be no coaches meeting. Packets may be picked up at the courses on Sunday (girls) from 1:00 - 3:00 pm or Tuesday (boys) from 1:00 - 3:00 pm.

**DISTRICT DIRECTORS** - Immediately upon completion of your district golf tournament, e-mail entries to Jay Govan (jay.govan@nisd.net): ***PLEASE MAKE SURE THAT YOU INCLUDE THE NAME, CELL PHONE NUMBER, AND EMAIL ADDRESS OF ALL COACHES WHO HAVE PLAYERS ATTENDING THE REGIONAL TOURNAMENT IN SAN ANTONIO.***

**5A BOYS & GIRLS:**

Jay Govan, Regional Golf Director  
8400 N Loop 1604 W  
San Antonio, TX 78249  
Ph: (210) 913-2570  
Email: jay.govan@nisd.net

**6A BOYS & GIRLS**- please refer to McAllen ISD Athletic Director.

**REGION IV TENNIS TOURNAMENT**  
**CONFERENCE 5A and 6A**  
**April 27 - 28, 2021**

**SITES:**   **5A - NEISD Tennis Center**                      **6A - Northside Tennis Center**  
                  12002 Jones Maltsberger Rd.                      12045 Leslie Road  
                  210-491-6108    Helotes, TX 78023

**DIRECTOR:**                      Patrick Johnson, Tennis Coordinator - NEISD  
  Phone: (210) 356-6921      Fax: (210) 491-6135

**ASST. DIR:**                      Kelly Parker, Executive Director for Athletics - NEISD  
  Phone: (210) 356-6902      Fax: (210) 491-6135

**FAX OR EMAIL ENTRIES TO:**                      PATRICK JOHNSON, NEISD  
  FAX: (210) 491-6135  
  [pjohns2@neisd.net](mailto:pjohns2@neisd.net)

**ENTRY DEADLINE:** **Mon., April 19, 2021** - Entries must be **typed** and **certified** by District Directors using the UIL Tennis Results Form. This should be done as soon as your district tournament is completed.

**ENTRY FEES:**                      See 2021 Fee Schedule in the Regional Meet Handbook  
  (fee paid by District Chairman)

**SEEDING MEETINGS:**      **Monday, April 26, 2021 @ 5:00 p.m.**

**5A @ NEISD Tennis Center (BAC)**  
  **6A @ Piper Bass Student Ctr. (next to NEISD Tennis Center at BAC)**

Both meeting sites are on the Blossom Athletic Center campus, 12002 Jones-Maltsberger Rd., San Antonio, TX 78216

**Covid-19 protocols will be followed at all times.**

**SCHEDULE OF PLAY:**

First day (Tue., Apr. 27) - 1<sup>st</sup> round singles matches will begin at 8:30 a.m. followed by doubles and mixed.

Second day (Wed., Apr. 28) - All matches begin at 8:30 a.m.

Athletes and coaches will meet at 8:00 a.m. at their tournament site on the first day of the tournament. Sites will be open for warm up at 7:00 a.m. UIL rules will be followed.

2021



GIRLS SINGLES

**Region IV- 5A Tennis**

NEISD Tennis Center

San Antonio, TX

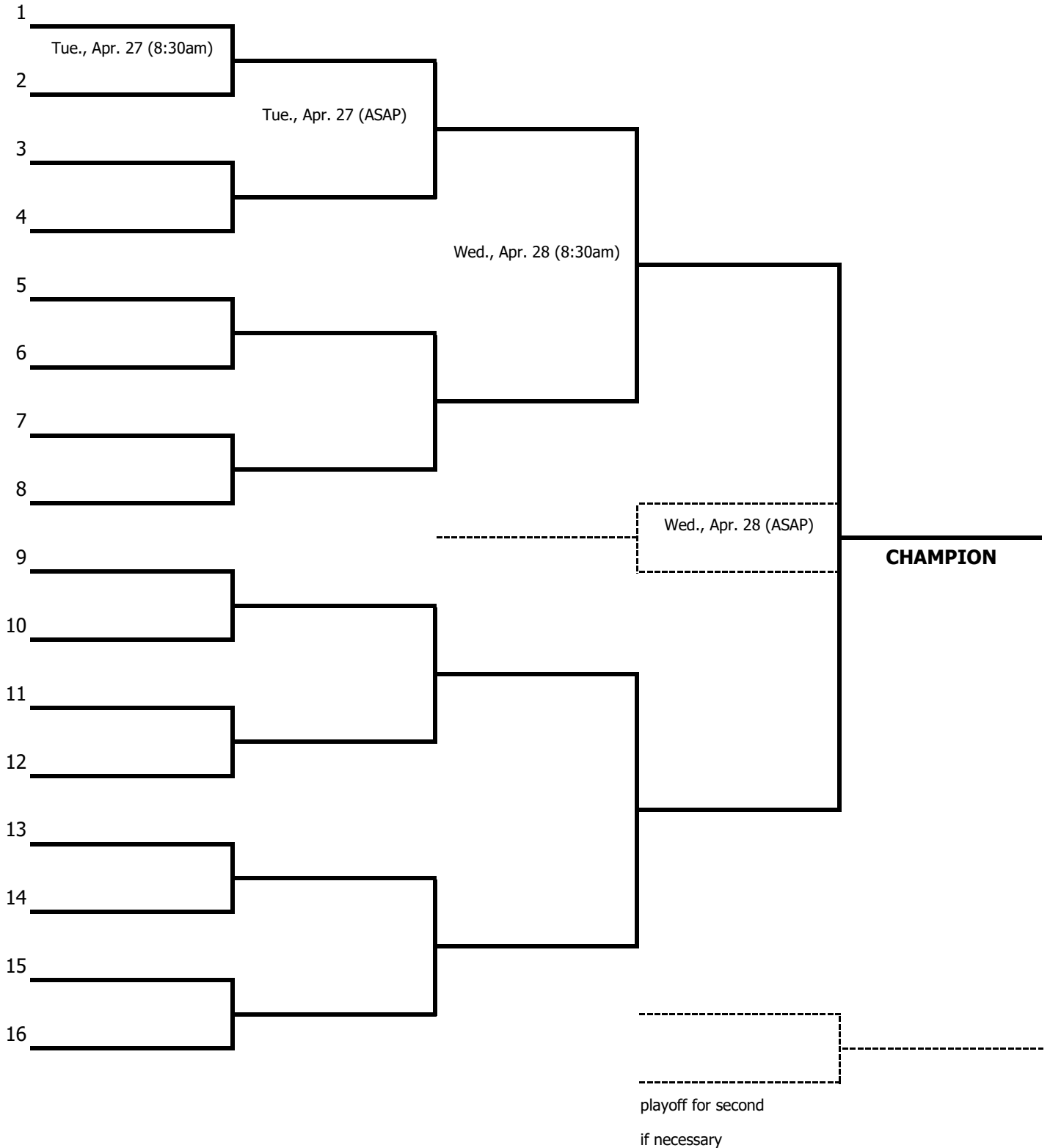



2021



BOYS SINGLES

**Region IV- 5A Tennis**

NEISD Tennis Center

San Antonio, TX

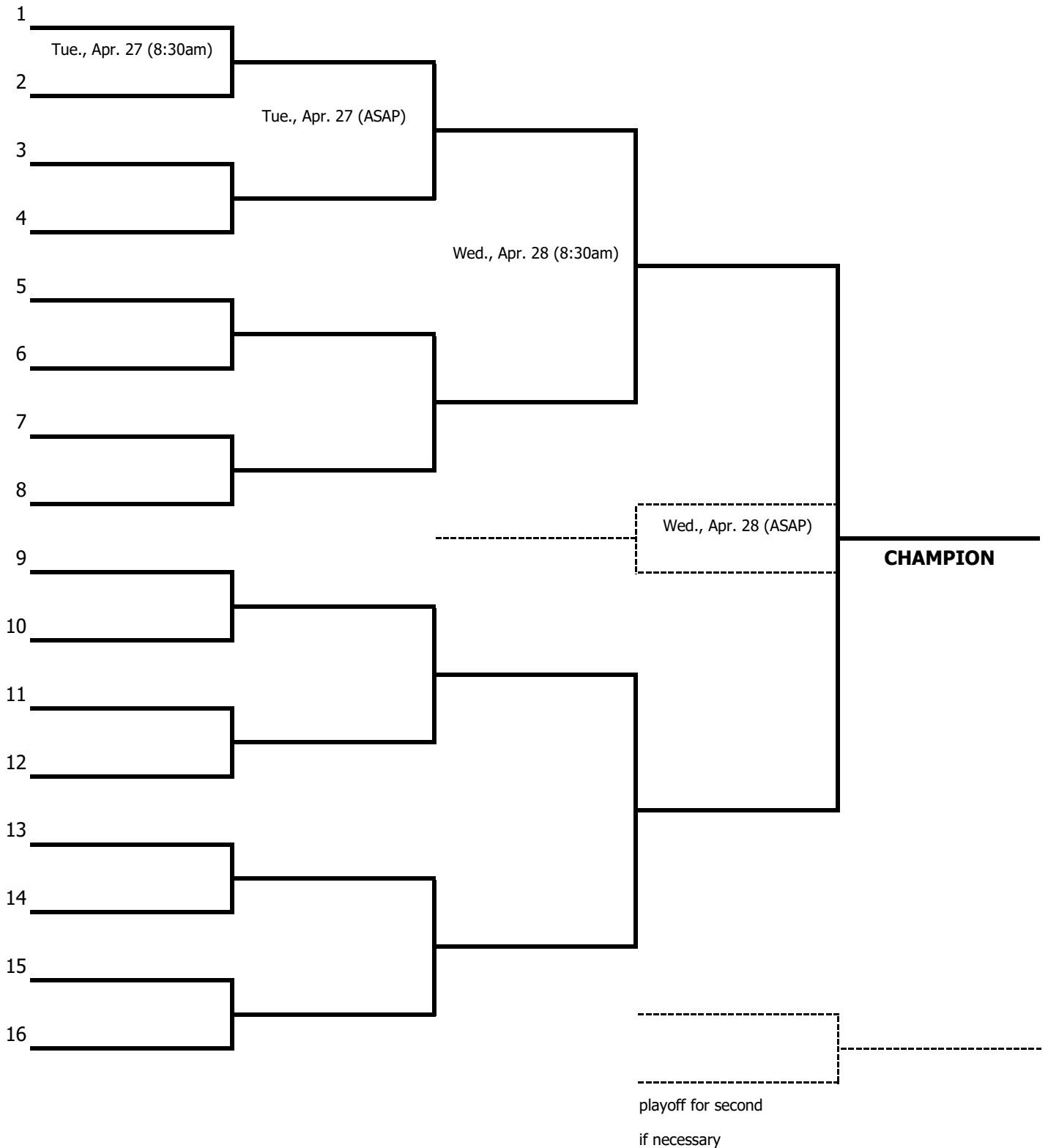

2021



GIRLS DOUBLES

**Region IV- 5A Tennis**

NEISD Tennis Center

San Antonio, TX

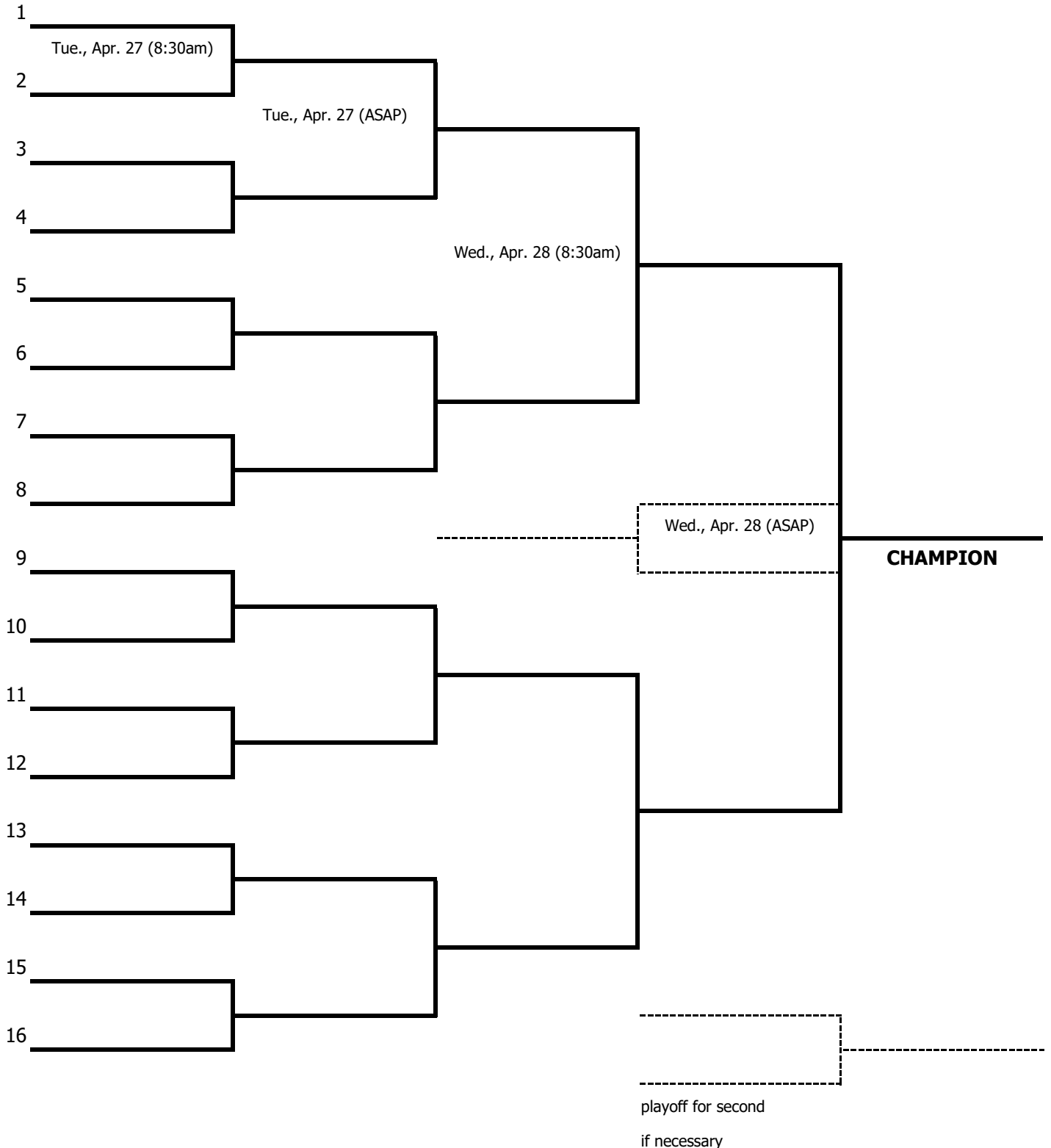

2021



BOYS DOUBLES

**Region IV- 5A Tennis**

NEISD Tennis Center

San Antonio, TX

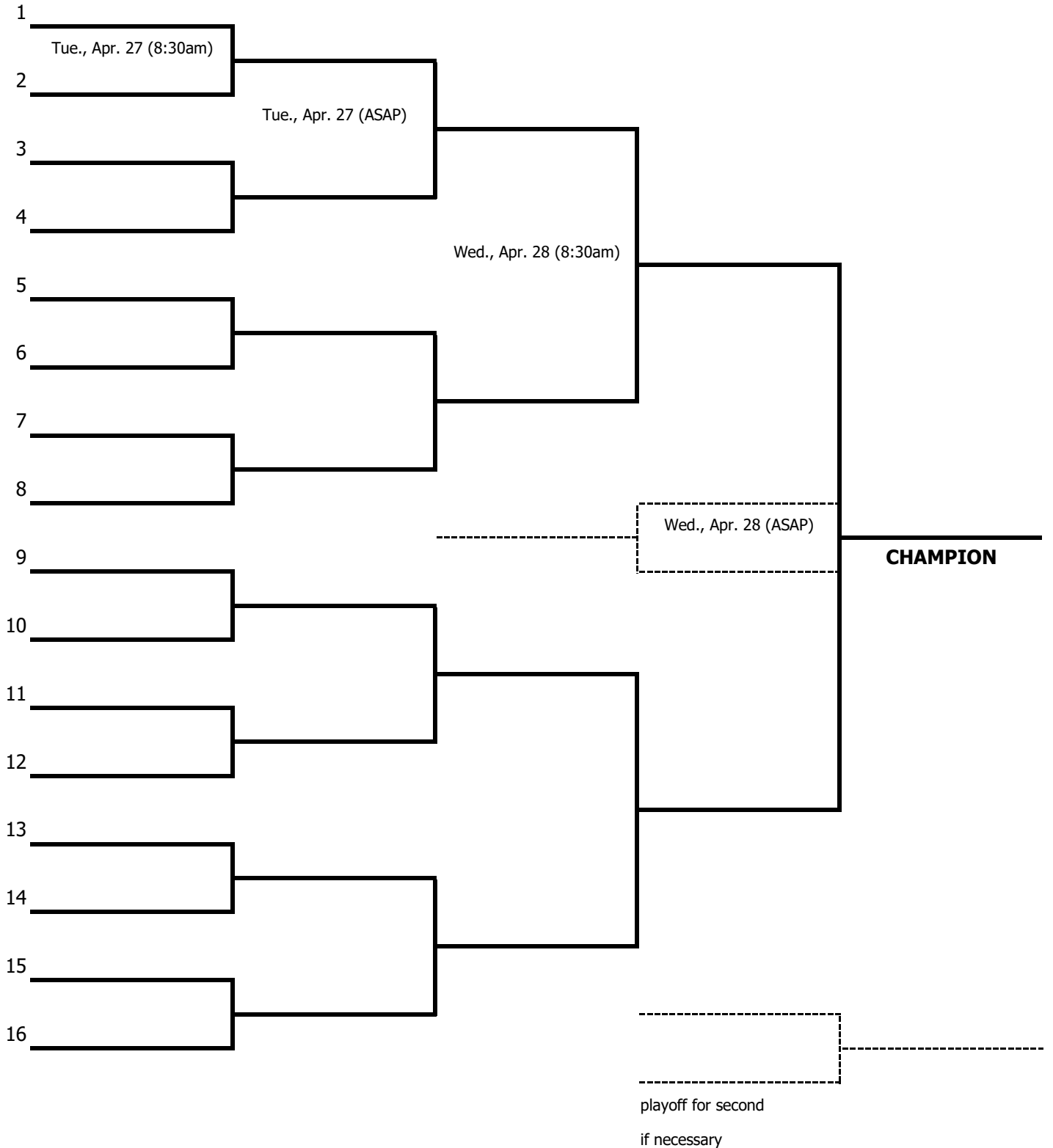

2021



MIXED DOUBLES

**Region IV- 5A Tennis**

NEISD Tennis Center

San Antonio, TX

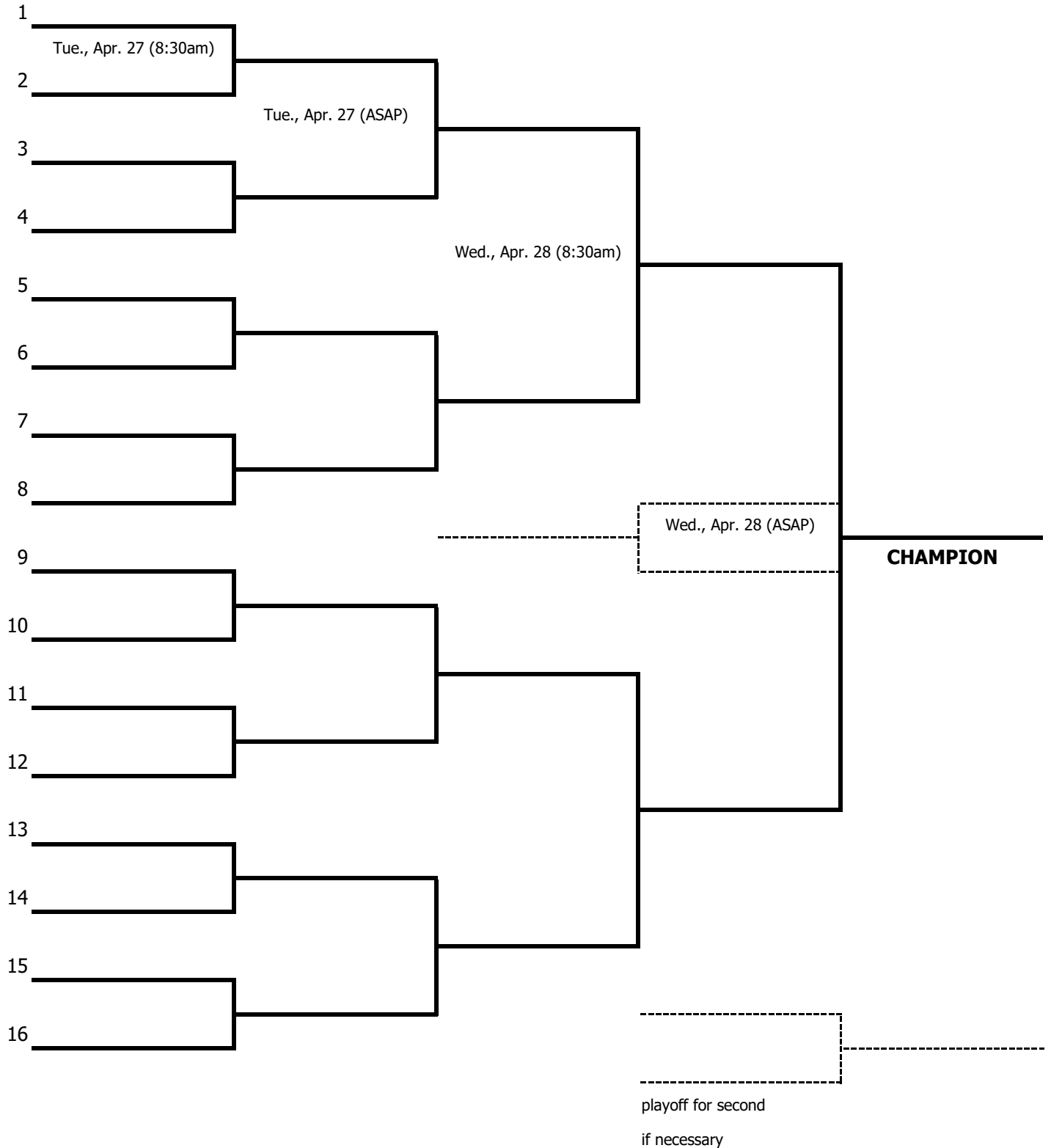

2021



GIRLS SINGLES

**Region IV- 6A Tennis**

Northside Tennis Center

San Antonio, TX

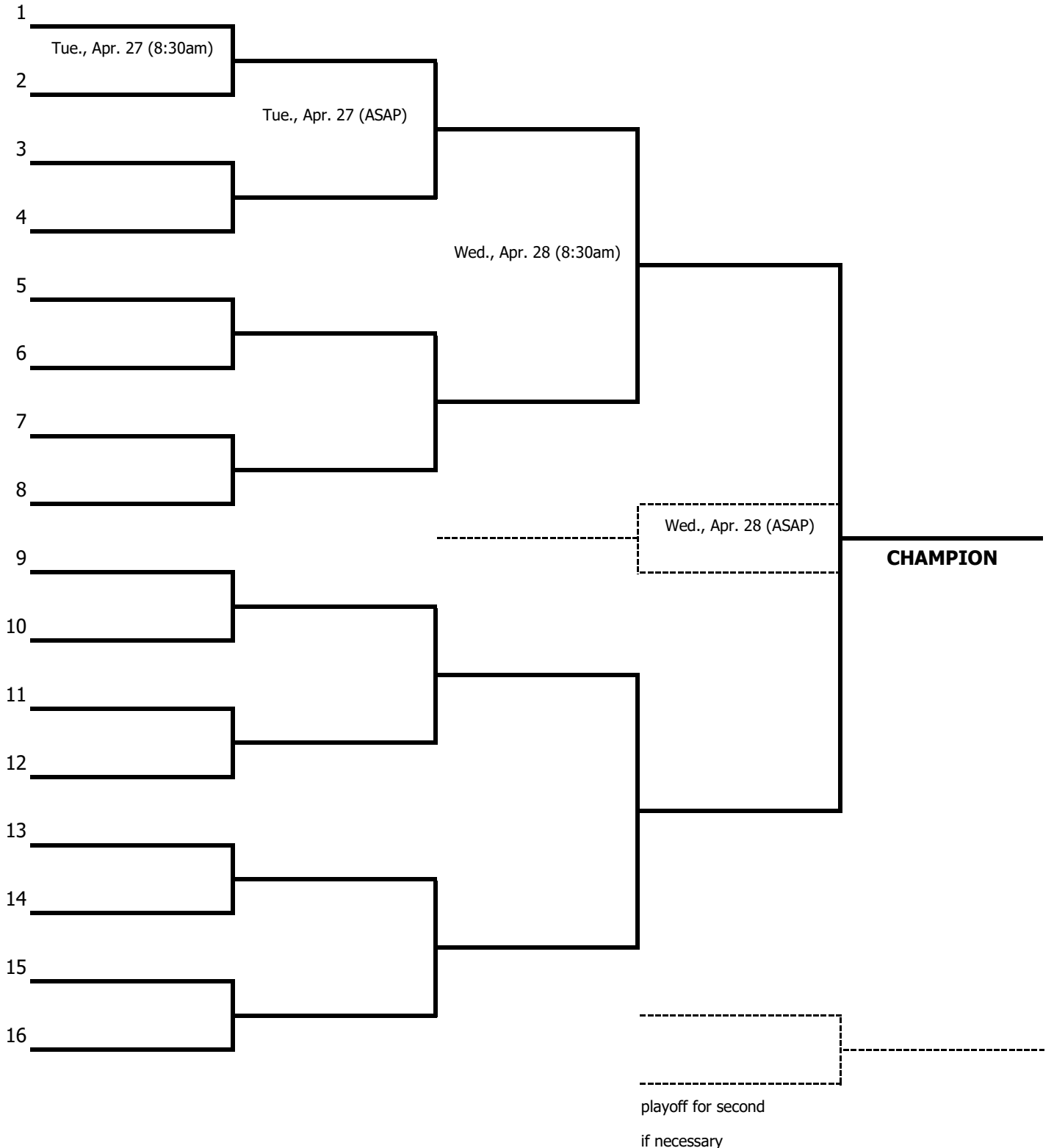

2021



BOYS SINGLES

**Region IV- 6A Tennis**

Northside Tennis Center

San Antonio, TX

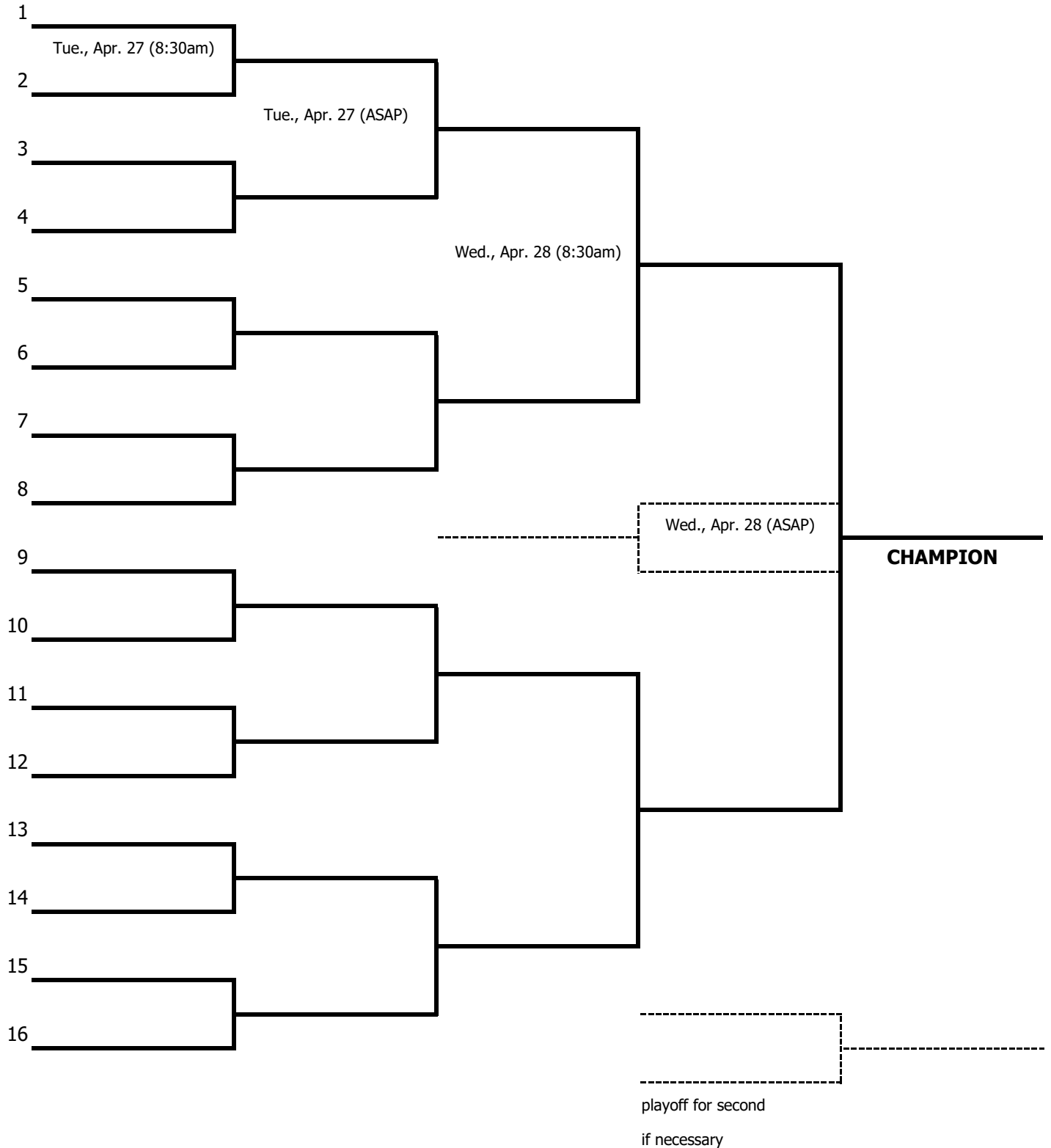

2021



GIRLS DOUBLES

**Region IV- 6A Tennis**

Northside Tennis Center

San Antonio, TX

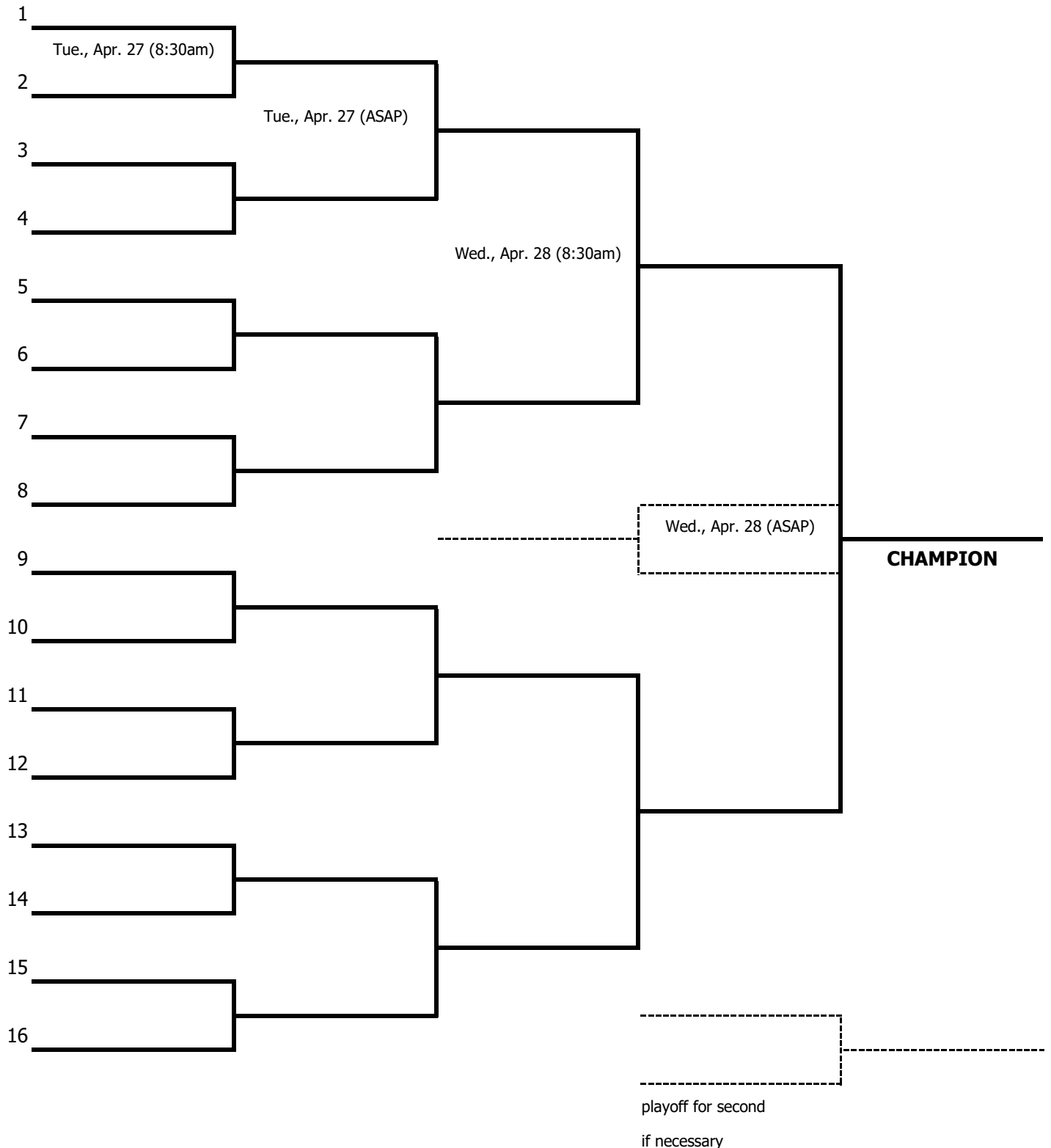

2021



BOYS DOUBLES

**Region IV- 6A Tennis**

Northside Tennis Center

San Antonio, TX

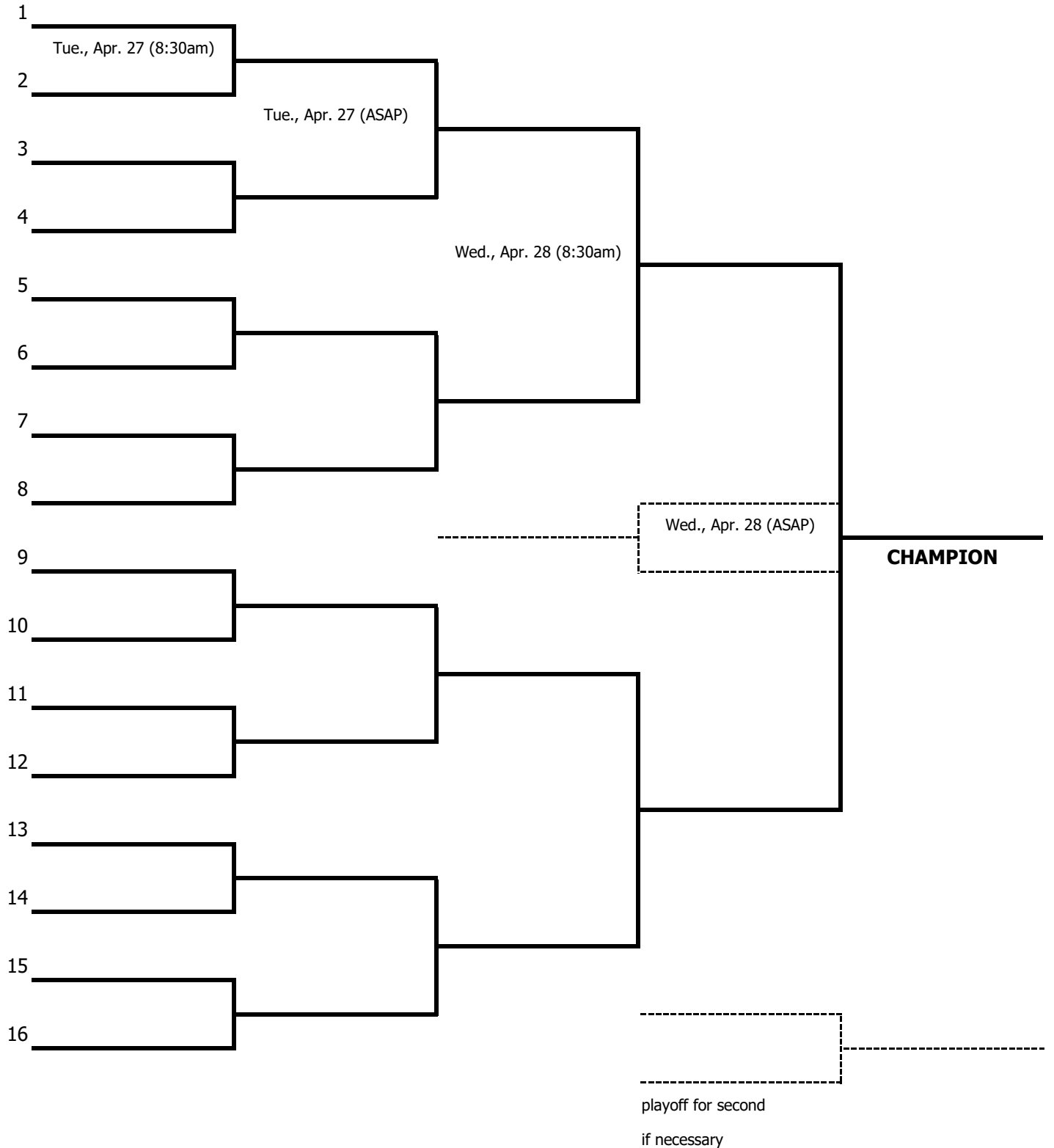



2021



MIXED DOUBLES

**Region IV- 6A Tennis**

Northside Tennis Center

San Antonio, TX

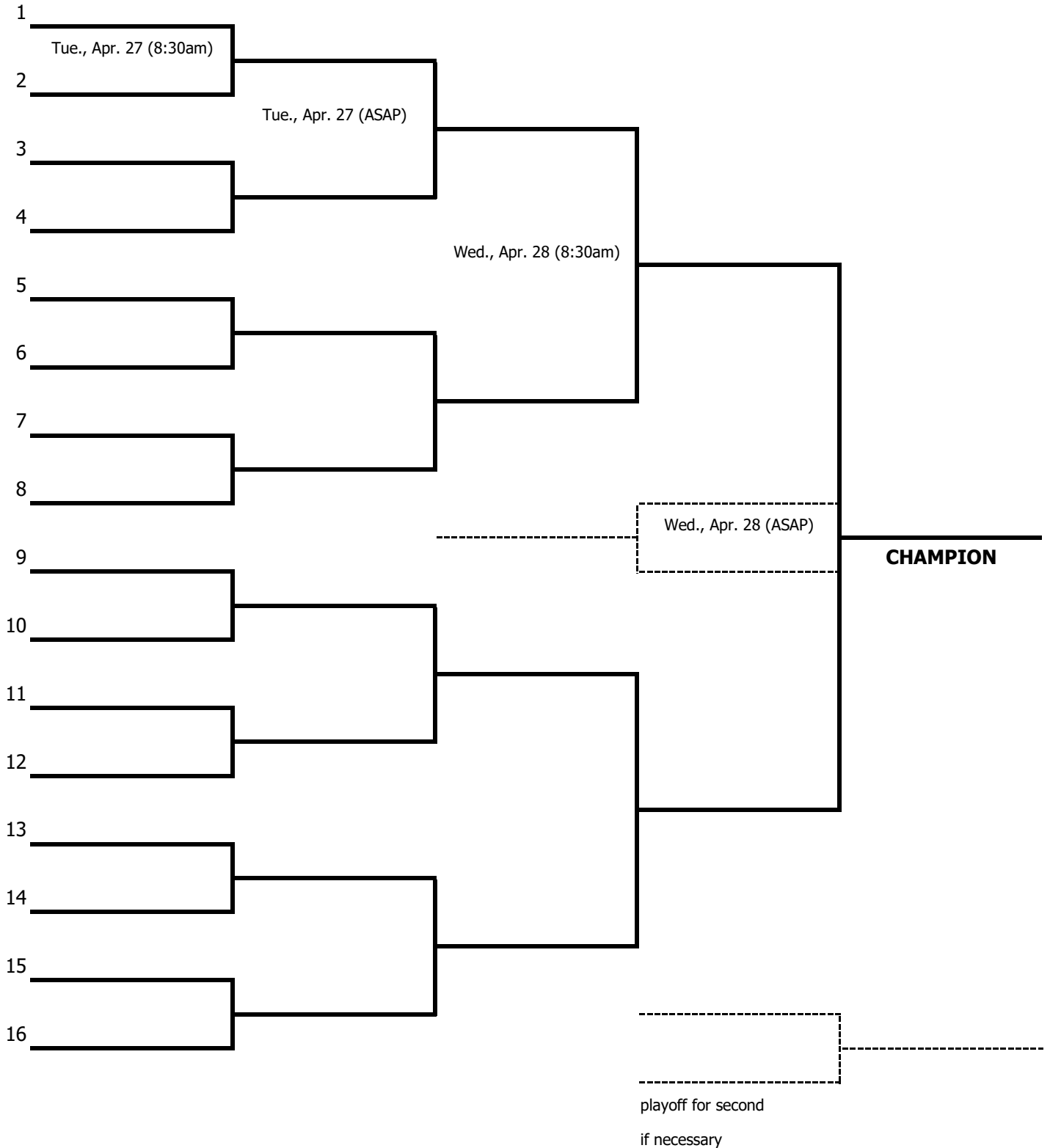

# GUIDELINES FOR DISTRICT AND AREA TRACK AND FIELD MEET

## SPRING 2021

For simplicity sake, the host district will be considered the primary district and the other competing district will be considered the secondary district. The primary district's DEC chairperson is responsible for the financial obligation to the regional meet and the billing to the secondary DEC Chairperson for their athletes qualifying for the regional track and field meet this spring. Only until the area meet is completed, will the primary DEC Chairperson know who qualifies for regional competition.

**NOTE** – This does not effect each district's fee for regional golf and tennis. The secondary district's DEC Chairperson will send a check for regional golf and tennis and will be billed by the primary district's DEC Chairperson for track and field.

If you choose not to participate in an area meet, but to participate in a district meet you will be responsible to qualify two (2) competitors in each track and field event for the regional meet, this April 23-24, 2021.

### Districts that held AREA Track & Field pay:

<u>PRIMARY (Hosting) DISTRICT</u>		<u>SECONDARY (Competing) DISTRICT</u>	
Golf	\$2,100	Golf	\$2,100
Tennis	\$320	Tennis	<u>\$320</u>
Area Track & Field	<u>\$2,720</u>	Total	\$2,420
Total	\$5,140		

### Districts that held DISTRICT Track & Field pay:

Golf	\$2,100
Tennis	\$320
District Track & Field	<u>\$1,360</u>
Total	\$3,780



North East ISD Athletic Department  
VIRGIL T. BLOSSOM ATHLETIC CENTER

---

Executive Director  
Kelly Parker

Director/Athletics  
Timothy Woods

Director/Athletics  
Stacey Moore

Director/Athletics  
David Greathouse

Director/Athletics  
John Gallardo

Director/Aquatics  
David Johnson

Director PE/Health/Athletics  
Rachel Naylor

Tennis Coordinator  
Patrick Johnson

**BOARD OF EDUCATION**

SHANNON GRONA President, SANDY WINKLEY Vice President, SANDY HUGHEY Secretary.  
DAVID BEYER Trustee, OMAR LEOS Trustee, TERRI WILLIAMS Trustee, STEVE HILLIARD Trustee

DR. SEAN MAIKA  
Superintendent

**To All Region IV 5A/6A Track & Field Participants,  
Coaches, Administrators, Parents, and Fans**

On behalf of the North East Independent School District, we would like to personally welcome you to Heroes Stadium for the UIL Region IV 5A/6A Track & Field Meet.

To those of you who are traveling, welcome to San Antonio. We hope you enjoy your stay.

The North East Independent School District Athletic Office Staff realizes the importance of this meet and has worked diligently to assure that it will be an enjoyable experience for all. If we can be of any assistance, please let us know.

Good Luck to all participants and safe travels.

Kelly Parker  
2021 Region IV 5A/6A Track Meet Director  
NEISD Executive Director of Athletics

- North East ISD follows all guidelines and recommendations issued by the TEA, UIL, and the CDC.
- At this time **masks** are **required** at all sporting events held on North East ISD property.
- Spectators must sit every other row. We ask that you do not sit on bleachers with a blue X.
- We thank you in advance for your understanding and your cooperation.

Thank You,

Kelly Parker

Executive Director of Athletics, North East ISD

**BOYS AND GIRLS TRACK AND FIELD  
REGION IV CONFERENCES AAAAA AND AAAAAA  
APRIL 23-24, 2021  
HEROES STADIUM  
4799 THOUSAND OAKS– SAN ANTONIO, TX 78233**

**MEET DIRECTOR:** Kelly Parker

Office: (210) 356-6915

Fax: (210) 491-6135

Cell: (210) 392-3589

**ASSISTANT DIRECTOR:** Tim Woods

Ph: (210) 356-6930

**REGION IV ATHLETIC DIRECTOR:** Rudy De Los Santos

**REFEREE:** Tom Nalepa, Head Referee

Bob Majek, Assistant Referee

Don Griffith, Assistant Referee

Jeff Kelso, Assistant Referee

**TRACK ADVISORY COMMITTEE:** Head of Appeals- Richard Ocanas: CCISD,  
Robert Gomez: Edgewood, Ryan Dupree: JISD, Jose Briones: Laredo United, Mike Carew: NISD,  
Stan Laing: NISD, Dyanne Munoz: South San, Lou Mora: Austin ISD, Melanie Hinson: Southwest  
Barbara Wise: SAISD, Richard Thompson: Mission Sharyland, Sylvia Barrera: Laredo, Leal Gilbert:  
Brownsville, Johnathan Lamb: Leander, Spencer Gantt: Victoria, Luis Escamilla: Laredo, Laura Garza:  
Edgewood:

**FACILITIES MANAGER:** David Greathouse

**ENTRY DEADLINE:** **TUESDAY, APRIL 20, 2021 @ 10:00 a.m.**

**DISTRICT/AREA DIRECTORS:** Send a copy of entries and alternates immediately upon completion of the District/Area Meet to: (if using Hy-Tek please see section on Hy-Tek procedures attached)

Kelly Parker, Region IV 5A and 6A Meet Director  
North East ISD Athletic Office  
12002 Jones Maltsberger Rd  
San Antonio, Texas 78216  
Fax: (210) 491-6135  
Email: kparke2@neisd.net

**ALL CHECKS SHOULD BE MAILED TO:** DIRECTOR GENERAL, NISD ATHLETICS  
8400 N. LOOP 1604 W  
SAN ANTONIO, TX 78249

**MAKE CHECKS PAYABLE TO: UIL REGION IV**

**REGION IV 5A-6A**  
**FRIDAY, APRIL 23, 2021**  
**8:00 A.M. – Gates will open for the public**

**6A**  
**AAAAAA Field Events:**

		<u>WEIGH-IN TIMES &amp; LOCATION</u>
<b>9:00 am</b>	Girls Pole Vault	<u>EASTSIDE STORAGE ROOM.</u> 7:00-8:00 am
	Boys High Jump	
	Boys Long Jump	<u>HOME TEAM DRESSING ROOM</u>
	Boys Discus	7:00-8:00 am
	Girls Shot Put	7:00-8:00 am
	Girls WC Div	
	Girls Triple Jump	
<b>11:30 am</b>	Girls Discus	<u>HOME TEAM DRESSING ROOM</u> 9:30 -10:30 am
	Girls High Jump	
	Girls Long Jump	
	Boys Triple Jump	<u>HOME TEAM DRESSING ROOM</u>
	Boys Shot Put	9:30-10:30 am
	Boys WC Div	
	Boys Pole Vault	<u>EASTSIDE STORAGE ROOM</u> 9:30-10:30 am

**5A**  
**AAAAA Field Events:**

		<u>WEIGH-IN TIMES &amp; LOCATION</u>
<b>2:30pm</b>	Girls Pole Vault	<u>EASTSIDE STORAGE ROOM</u> 12:30-1:30 pm
	Boys High Jump	
	Boys Long Jump	<u>HOME TEAM DRESSING ROOM</u>
	Boys Discus	12:30-1:30 pm
	Girls Shot Put	12:30-1:30 pm
	Girls WC Div	
	Girls Triple Jump	
<b>5:00pm</b>	Girls Discus	<u>HOME TEAM DRESSING ROOM</u> 3:00-4:00 pm
	Girls High Jump	
	Girls Long Jump	
	Boys Triple Jump	<u>HOME TEAM DRESSING ROOM</u>
	Boys Shot Put	3:00-4:00 pm
	Boys WC Div	
	Boys Pole Vault	<u>EASTSIDE STORAGE ROOM</u> 3:00-4:00 pm

**RUNNING EVENTS: AAAAA and AAAAAA GIRLS AND BOYS PRELIMINARIES**  
**3200 METER GIRLS AND BOYS FINALS**

Qualifying Procedures:

**Prelims:** Heat and lane assignments are generated *randomly* by the Hy-Tek computerized program.

**Finals :** The winner of each heat and the next 6 fastest times will advance to the finals. Lane assignments are based on times run in prelims. (Lanes 4-5-3-6-2-7-1-8)

**9:00 a.m. 3200 Meter Run Finals: 5A Girls & Boys followed by 6A Girls & Boys**  
 All 5A relay entry cards & scratches due at the Heroes ticket booth.

**5A**

**AAAAA PRELIMS:**

**9:30 a.m.** (5A 4x100 Relays report/uniform check)

**10:00 a.m.** 4X100 Meter Relay (Girls & Boys)

**10:30 a.m.** 100 Meter Hurdles (33") (Girls)

**10:40 a.m.** 110 Meter Hurdles (39") (Boys)

**10:50 a.m.** 100 Meter Dash (Girls & Boys)

**11:10 a.m.** 4X200 Meter Relay (Girls & Boys)

**11:30 a.m.** 400 Meter Dash (Girls & Boys)

**11:50 a.m.** 300 Meter Hurdles (30") (Girls)

**12:00 p.m.** 300 Meter Int. Hurdles (36") (Boys)

**12:10 p.m.** 200 Meter Dash (Girls & Boys)

**12:30 p.m.** 4X400 Meter Relay (Girls & Boys)

\*\*\*\*\*THE ABOVE TIMES ARE APPROXIMATE FOR RUNNING PRELIMS.

\*\*\*\*\*JUDGE YOUR WARM-UP ON EVENTS, NOT TIMES

# REGION IV 5A-6A

FRIDAY, APRIL 23, 2021

CONTINUED

**2:30 p.m.** All 6A relay entry cards & scratches due at the Heroes ticket booth.

## 6A

### AAAAAA PRELIMS:

**3:00 p.m.** (6A 4x100 Relays report/uniform check)

**3:30 p.m.** 4x100 Meter Relay (Girls & Boys)

**4:00 p.m.** 100 Meter Hurdles (33") (Girls)

**4:10 p.m.** 110 Meter Hurdles (39") (Boys)

**4:20 p.m.** 100 Meter Dash (Girls & Boys)

**4:40 p.m.** 4x200 Meter Relay (Girls & Boys)

**5:00 p.m.** 400 Meter Dash (Girls & Boys)

**5:20 p.m.** 300 Meter Hurdles (30") (Girls)

**5:30 p.m.** 300 Meter Int. Hurdles (36") (Boys)

**5:40 p.m.** 200 Meter Dash (Girls & Boys)

**6:00 p.m.** 4X400 Meter Relay (Girls & Boys)

\*\*\*\*\*THE ABOVE TIMES ARE APPROXIMATE FOR RUNNING PRELIMS.

\*\*\*\*\*JUDGE YOUR WARM-UP ON EVENTS, NOT TIMES.

**REGION IV 5A-6A**  
**SATURDAY, APRIL 24, 2021**  
**11:00 A.M. – Gates will open for the public**

**10:00 a.m. Finals packets will be available at the Heroes ticket booth.**

**RUNNING EVENTS: AAAAA and AAAAAA GIRLS AND BOYS FINALS**

PLEASE NOTE: AAAAA teams will run before AAAAAA teams in the Girls and Boys divisions.

- 12:00 p.m.** (4X100 M Relay report/uniform check)  
**12:30 p.m.** 4X100 Meter Relay (Girls and Boys AAAAA and AAAAAA)
- 12:50 p.m.** 800 Meter Run (Girls and Boys AAAAA and AAAAAA)
- 1:10 p.m.** 100 Meter Low Hurdles (33") ( Girls AAAAA and AAAAAA)  
**1:20 p.m.** 110 Meter High Hurdles (39") (Boys AAAAA and AAAAAA)
- 1:30 p.m.** 100 Meter Dash (Girls and Boys AAAAA and AAAAAA)  
**1:35 p.m.** 100 Meter Dash (Girls and Boys AAAAA and AAAAAA Wheelchair Division)
- 1:50 p.m.** 4X200 Meter Relay (Girls and Boys AAAAA and AAAAAA)
- 2:10 p.m.** 400 Meter Dash (Girls and Boys AAAAA and AAAAAA)  
**2:20 p.m.** 400 Meter Dash (Girls and Boys AAAAA and AAAAAA Wheelchair Division)
- 2:35 p.m.** 300 Meter Hurdles (30") (Girls AAAAA and AAAAAA)  
**2:45 p.m.** 300 Meter Int. Hurdles (36") (Boys AAAAA and AAAAAA)
- 2:55 p.m.** 200 Meter Dash (Girls and Boys AAAAA and AAAAAA)
- 3:15 p.m.** 1600 Meter Run (Girls and Boys AAAAA and AAAAAA)
- 3:55 p.m.** 4X400 Meter Relay (Girls and Boys AAAAA and AAAAAA)
- 4:40 p.m.** **AWARDS TO TEAM CHAMPIONS**



## TRACK AND FIELD EVENTS GENERAL INFORMATION

- I. Track and Field information packets will include the following items and will be made available at Heroes Stadium Ticket Booth, 4799 Thousand Oaks, San Antonio, TX 78233 on Thursday, April 22, 2021. Packets will be available for pick up between 2:00 pm and 5:00 pm. Packets may also be picked up at the Heroes Stadium Ticket Booth on Friday from 7:30 am to 3:30 pm and Saturday from 10:00 am to 1:00 pm.

- Field Event Entries
- Schedule of Events
- 3 coaches passes per school (Full time employees of the school district)
- Heat and Lane assignments
- Relay cards

II. **CONTESTANTS:** *All NFHS and UIL rules will govern the events at the regional meet.*

- A. Team camps are located on the east side of the stadium only.
- B. Will not be allowed on the track and/or infield before the first call for their event.
- C. Must remain in the stands when not participating in event or warming up. All participants will use the ramps on the Northeast and Southeast side of the stadium for track entrance.
- D. The first, second and third place winners must report to the awards stand immediately after their event.
- E. Field Events: When a competitor has qualified in more than one field event:
- a. He/She must inform the official upon check-in.
  - b. Upon leaving one event to compete in another, he/she must inform the official of time leaving and has 10 minutes to return.
  - c. Trials may be taken in succession.
- F. The Shot and Discus weigh-in station will be in the Home Team Dressing Room. 6A girls shot put & 6A boys discus, from 7:00 am until 8:00 am. 6A girls discus and 6A boys shot put from 9:30 am until 10:30 am. 5A boys shot put and 5A girls discus from 3:00 pm until 4:00 pm. 5A girls shot put and 5A boys discus from 12:30 pm until 1:30 pm. All implements weighed in will be impounded and only certified implements will be placed in the pool for competition. All implements may be picked-up at the weigh-in station. 6A from 1:45-2:15 pm and 5A from 6:30-7:00 pm, Friday, April 23rd. Athletes will be allowed to warm-up by flights prior to the start of competition with **approved** implements and under the supervision of an official.
- G. Pole Vault weigh-in will be in the East Side storage room. 6A girls weigh-in from 7:00-8:00 a.m. and 6A boys 9:30-10:30 a.m., 5A girls weigh-in from 12:30-1:30 p.m. and 5A boys 3:00 – 4:00 p.m. It is the responsibility of the coach to verify that the competitor will use a legal pole rated at or above his/her weight by submitting the pole vault weight rating sheet contained in this handbook at weigh- in time. Each athlete will be weighed prior to pole vault competition to make sure that pole weight and competitor weight correlates with the rules. **There will be no variance.**
- H. No loud radios will be allowed in the stadium.
- I. Automatic timing system and video will be used for all running events.
- J. In running events with prelims, qualifying for the finals will be the winner of each heat and the next 6 fastest times.
- K. FOR RUNNING EVENT PRELIMS, ATHLETES SHOULD JUDGE THEIR WARM-UP ON EVENTS, BECAUSE TIMES ARE APPROXIMATE.
- L. Designated uniform for shot & discus participants must follow NFHS rules as specified.
- M. Only 1/8 or 1/4 inch spikes will be allowed

- N. NO chalk, tacks, pins, powder, paint, duct tape or any items that may cause injury may be used as marks for field events and relays. ONLY white athletic tape will be allowed on the track and runways and must be removed immediately after the relay race and/or field event competition.
- O. No cell phone usage or other wireless device used for communication will be allowed on the field or during competition. However, electronic devices may be used in unrestricted areas and the designated coaches' boxes.
  - a. Electronic devices shall not be used to transmit information to the competitor during the race or trial.
  - b. Electronic devices shall not be used for any review of an official's decision.
- P. Starting heights for the Pole Vault and High Jump will be determined by the UIL Director of Athletics and the Meet Director before the meet based on District/Area entries. They will be available on the NEISD website on Tuesday, April 20th and in the coach's packet upon check-in.

### III. UNIFORMS: COMPETITOR'S UNIFORM IN TRACK AND FIELD AND CROSS COUNTRY

**NOTE: The wearing of medical alert with the alert visible is encouraged for risk minimization. The ultimate responsibility to have each competitor compliant with uniform rules and other reasonable and legal items is with the coach.**

**ART.1 ....The competitor's uniform shall be school-issued or school-approved, worn as intended by the manufacturer, and meet the following requirements and restrictions:**

- A. Each competitor shall wear shoes on both feet.
  - 1. The shoes shall have an upper and recognizable sole and heel.
  - 2. The (shoe) upper must be designed so that it can be fastened securely to the foot.

NOTE: The games committee may also determine the length of spikes allowed on all-weather surface. (3-2-4a)

- 4. The use of slippers or socks does not meet the requirements of the rule.
- B. Each competitor shall wear a school-issued or school-approved full-length track top and track bottom or one-piece uniform. Any outer garment (e.g., t-shirt, sweatpants, tights) that is school issued or school-approved becomes the official uniform, when worn.
  - 1. When numbers are used, each competitor shall wear his/her assigned, unaltered contestant number.
  - 2. The top and/or bottom or one piece uniform may have school name, school logo, school nickname and/or competitor's name.
  - 3. The top shall not be knotted or have a knot-like protrusion. Bare midriff tops are not permitted. The top must hang below or be tucked into the waistband of the uniform bottom when the competitor is standing upright.
  - 4. Loose-fitting boxer-type bottoms or compression-style bottoms are permitted for boys and girls, however, **boys must wear a loose-fitting track bottom, and they must wear shorts over the one-piece suit or compression style bottoms according to the UIL Manual.** Closed-leg briefs are acceptable for girls. French or high-cut apparel shall not be worn in lieu of the uniform bottom. The waistband of a competitor's bottom shall be worn above the hips.
  - 5. A single manufacturer's logo/trademark/reference, no more than 2 ¼ square inches with no dimension more that 2 ¼ inches, is permitted on the top and bottom or one-piece uniform.

6. One American flag, not to exceed 2 inches by 3 inches, may be worn or occupy space on each item of uniform apparel. By state association adoption, to allow for special occasions, commemorative or memorial patches, not to exceed 4 square inches, may be worn on the uniform without compromising its integrity.
7. Any visible garment(s) worn underneath the uniform top and/or bottom is considered a foundation garment. Foundation garments are not subject to logo/trademark/reference or color restrictions.

**ART. 2...** Additional restrictions for relay teams and cross country teams.

- A. All relay and cross country team members must wear uniforms clearly indicating, through predominant color, school logo and color combination of all outer garments worn as a uniform, that members are from the same team.

NOTE: The official should be able to observe that all members are from the same team.

**PENALTY: (Articles 1, 2) For the wearing of an illegal uniform, when a violation is observed and noted by a meet official, the competitor shall be required to make the uniform legal before becoming eligible for further competition and shall be issued a warning that a subsequent violation shall result in a disqualification from the event. The referee shall be notified of the violation by the observing meet official, and the referee shall then notify or cause to be notified the head coach of the offending school of the competitor's violations and warning.**

**ART. 3...** Removing any part of the team uniform, excluding shoes, while in the area of competition, as defined by the games committee, is illegal.

**PENALTY: This shall lead to a warning and if repeated, to disqualification from the event. If the incident recurs, the competitor will be disqualified from further competition in the meet.**

**IV. COACHES:** *All NFHS and UIL rules will govern the events at the regional meet.*

- A. No district passes or TGCA or THSCA membership passes will be honored.
- B. A Wrist Band identifying Region IV coaches (Full-Time employee of the School District) with qualifying participants will be given out in the information packets and must be worn at all times at all sites. Do not remove the wristband if you plan on returning on Saturday. (three wristbands per team).
- C. All scratches/substitutes for events must be certified by the District/Area Track Meet Director by submitting the changes in writing to Kelly Parker @ Fax# (210) 491-6135 or by e-mail to [kparke2@neisd.net](mailto:kparke2@neisd.net) *Please use the form in the Regional Meet Handbook titled Track & Field Substitute Certification Form.*
- D. **NO SUBSTITUTIONS WILL BE ACCEPTED AFTER 10:00 A.M. ON TUESDAY, APRIL 20, 2021.**

E. Relay cards are due on Friday, April 23<sup>rd</sup> at the Heroes ticket booth at the following times:

**5A – 9:00 am and 6A – 2:30 pm. Names cannot be added or changed after the deadline.**  
*Relay teams will be subject to disqualification if relay cards are not turned in on time.*

- F. Appeals must be made by the coach in written form and submitted to a referee at the referee station under the video board **no later than 30 minutes** after the announcement of the event results. Forms will be provided in the coaches' packet and at the referee's table.

Situations which are subject to appeal include, but are not limited to:

1. Misapplication of the rules
2. Correction of clerical or team scoring errors which must be corrected up to 48 hours after the end of the meet, unless another time period is specified in advance by the games committee or meet director.
3. Correction of meet results involving an ineligible participant which may be made at any time.
4. Failure to follow a procedure contained in the terms and conditions of competition announced in advance by the games committee or meet director. This would include such items as the time schedule, the number of qualifiers to advance, number of trials, etc.

Non-appealable situations:

1. Any judgment decision pertaining to violations or alleged violations of the rules.
2. A decision made by the finish judges or timers that does not involve misapplication of a rule or the terms and conditions of competition.
3. Whether a start is fair and legal.

NOTE: SECTION 3-4: The referee has the sole authority for ruling on infractions or irregularities not covered within the rules.

- G. No coaches will be allowed on the field of competition during running events unless summoned by the referee or filing an appeal. A field marshal will escort the coach to the referee's table.
- H. A coach's box will be provided at all field event sites for coaches, 1 coach per team with approved UIL wristband AND meet issued colored wristband and only while their athlete competes.
- I. Video equipment authorized by the meet director and games committee may be used to review appealable infractions. The replay may be viewed only by the meet referee and/or the jury of appeals
- J. Trainers Station - Trainers from the host site (NEISD) will be on duty in the Northwest (Home) locker room. The host site trainers will be allowed on the track during distance races and if they are called to administer to an athlete. Trainers may not take pictures or review videos with athletes.
- V. **SCORING**
- A. Individual field and running events: (10-8-6-4-2-1)
- B. Relays: (20-16-12-8-4-2)

VI. **ADMISSION PRICES:**

Students: \$5.00 one day

Adults: \$10.00 one day

- VII. All tickets will be sold online at [neisd.net/Page/2881](https://neisd.net/Page/2881) through Ticket Spicket. Download Ticket Spicket App to purchase tickets on Google Play and Apple Store or visit <https://events.ticketspicket.com/agency/4e5ad12e-aa84-444a-990d-1d531b513645> or click on the following QR Code.



VIII. **THERE WILL BE NO PRELIMS IN THE FOLLOWING EVENTS**

- A. 5A Girls and Boys – 800, 1600 and 3200 Meter Runs
- B. 6A Girls and Boys – 800, 1600 and 3200 Meter Runs

COACHES/ATHLETES MAP AND DIRECTIONS TO HEROES STADIUM (East Side)

4799 Thousand Oaks Drive-San Antonio, Texas 78233

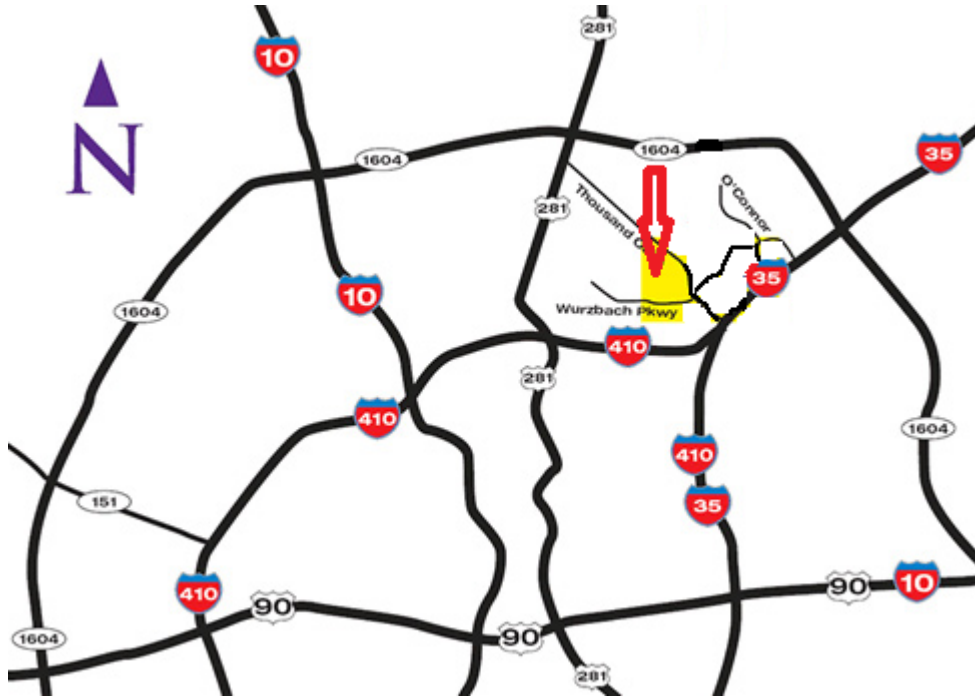

**From South (Corpus Christi)**

Take I-37 North. Exit 133 to merge onto I-410N to I-35N. Take Exit 167 toward Starlight Terrace/Thousand Oaks Drive. Merge onto Interstate 35 Access Road. Turn left onto Starlight Terrace/Thousand Oaks. Follow Thousand Oaks for just over half a mile and turn left onto Quarry Park to Heroes Stadium.

**From West (Del Rio, Uvalde)**

Take US-90 East. Exit I-10 West/I-35 North/US-87 North toward Austin/El Paso. Continue to follow I-35 North for about 14 miles. Take Exit 167 toward Starlight Terrace/Thousand Oaks Drive. Merge onto Interstate 35 Access Road. Turn Left onto Starlight Terrace/Thousand Oaks. Follow Thousand Oaks for just over half a mile and turn left onto Quarry Park to Heroes Stadium.

**From East (Seguin, Houston)**

Take US-90 West. Take the ramp onto I-10 West/US-90 West. Take Exit 581 and merge onto I-410. Continue onto I-35 North/North Panam Expressway. Take Exit 167 toward Starlight Terrace/Thousand Oaks Drive. Merge onto Interstate 35 Access Road.

Turn Left onto Starlight Terrace/Thousand Oaks. Follow Thousand Oaks for just over half a mile and turn left onto Quarry Park to Heroes Stadium.

### **From Austin or Dallas**

Take I-35 South toward San Antonio. Exit 167B toward Thousand Oaks Drive/Starlight Terrace. Merge onto Interstate 35 Access Road. Turn right onto Thousand Oaks Drive. Follow Thousand Oaks for just over half a mile and turn left onto Quarry Park to Heroes Stadium.

### **From West (El Paso, Kerrville)**

Take I-10 East to Exit 564 and merge onto I-410 East. Keep left at the fork and follow signs for I-35 North/Austin. Keep Right at the fork, follow signs for Randolph Boulevard/Windcrest. Keep Left at the fork and follow signs for I-35 North and merge onto Interstate 35 Access Road. Turn left onto Starlight Terrace/Thousand Oaks. Follow Thousand Oaks for just over half a mile and turn left onto Quarry Park to Heroes Stadium.

### **From Downtown San Antonio**

Take I-37 N/US-281 North. Exit I-35 N/North Panam Expressway toward Austin, Exit 142A. Take exit 167 toward Starlight Terrace/Thousand Oaks Drive. Merge onto the Interstate 35 access road. Turn left onto Starlight Terrace/Thousand Oaks. Follow Thousand Oaks for just over half a mile and turn left onto Quarry Park to Heroes Stadium.

### **From North San Antonio (Stone Oak Area)**

Take I-37 S/US-281 South. Exit onto Loop 410 E via the ramp. Keep left at the fork and continue on toward I-35 N/Austin. Keep Right at the next fork and follow signs for Randolph Boulevard/Windcrest. Keep Left at the fork and follow signs for I-35 N and merge onto the I-35 Access Road. Turn Left onto Starlight Terrace/Thousand Oaks. Follow Thousand Oaks for just over half a mile and turn left onto Quarry Park to Heroes Stadium.

### **From the Airport**

From Airport Boulevard, turn Left onto NE 410 Loop Frontage Road. Exit onto NE Loop 410 E via the ramp on the left. Keep Left at the fork and continue on toward I-35 N/Austin. Keep Right at the next fork and follow signs for Randolph Boulevard/Windcrest. Keep Left at the fork and follow signs for I-35 N and merge onto the I-35 Access Road. Turn Left onto Starlight Terrace/Thousand Oaks. Follow Thousand Oaks for just over half a mile and turn left onto Quarry Park to Heroes Stadium.



**REGION IV 5A AND 6A  
TRACK AND FIELD MEET  
MAP OF STADIUM  
APRIL 23-24, 2021**

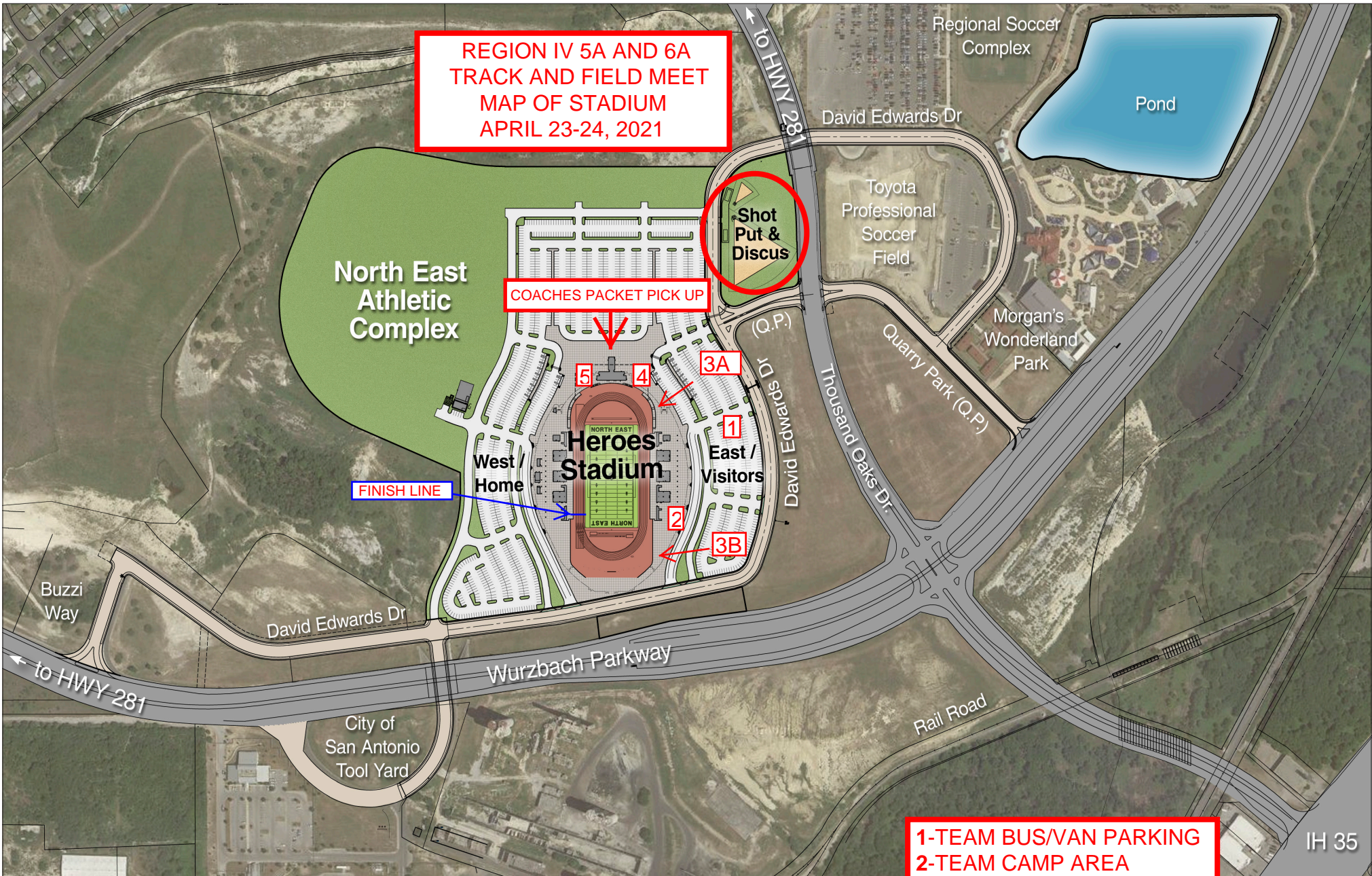

# HEROES STADIUM

4707 David Edwards Drive  
San Antonio, Texas 78233

- 1-TEAM BUS/VAN PARKING
- 2-TEAM CAMP AREA
- 3A-NE TRACK ENTRANCE
- 3B-SW TRACK ENTRANCE
- 4-PV WEIGH IN  
(East side storage room)
- 5-SHOT/DISCUS WEIGH IN  
(West side storage room)





## **HEROES STADIUM** **TRACK MARKINGS**

### **GENERAL**

1. The longest spike that may be used is the 1/4" pyramid.
2. No foreign materials of any kind should be placed on the track or jumping surface areas, including dusts, salt, powders, etc. If temporary markers are needed, the use of plastic or adhesive tape is acceptable, but should be removed as soon as the event is over.
3. The finish line for all events except the 100-M and 110-M Hurdles occurs at the southwest turn.
4. The curved white line at the southeast turn designates the break at the pole.

### **EVENT DESCRIPTIONS**

- 100-M Dash** The white start line is located in the chute near the southwest turn. The white finish line is located on the west side of the track.
- 200-M Dash** The white start lines are located at the north end of the track and are staggered on turn.
- 400-M Dash** The yellow start lines are located at the south end of the track and are staggered two turns.
- 800-M Dash** The white start lines are located at the south end of the track and are staggered one turn.
- 400-M Relay** The start lines are identical to those used in the 400-M Dash. The exchange zones are typical and are colored gold.
- 800-M Relay** The blue start lines are located at the south end of the track and are staggered four turns. The exchange zones are typical and are colored blue except for the third exchange which utilizes the second exchange zone of the 400-M Relay, which is gold.
- 1600-M Relay** The green start lines are located at the south end of the track and are staggered three turns. The first exchange zone is typical and is colored green. The second and third exchanges take place between the broken green lines in each lane located at the southwest corner of the track.
- 100-M Hurdles** The start and finish lines are identical to those used in the 100-M Dash when running south to north. Hurdle settings are designated by gold triangles in each lane facing the direction of the finish line.

#### **10 Hurdles @ 33" - High School Girls**



**110-M Hurdles** The white start line is located in the chute near the southwest turn. The finish line is identical to that used for the 100-M Dash and the 100-M Hurdles when running from south to north.

Hurdle settings are designated by blue triangles in each lane facing the direction of the finish line.

**10 Hurdles @ 39"- High School Boys**

**300-M Hurdles** The white start lines are located near the southeast turn and are staggered one turn.

Hurdle settings are designated by green triangles in each lane.

**8 Hurdles @ 30"- High School Girls**

**8 Hurdles @ 36"- High School Boys**

## **NEISD HEROES STADIUM RUNWAY BOARDS**

### **LJ & TJ PIT BOARDS**

8' Yellow

12' White

20' Blue

24' Yellow

28' White

32' Blue

36' Yellow

40' Blue

## TRACK & FIELD SUBSTITUTE CERTIFICATION FORM

(FOR USE BY COACH TO INFORM DISTRICT/AREA DIRECTOR OF SCRATCH)

_____ School	_____ Coach	_____ District – Conference EX: 29 – 5A
_____ Name of Athlete	_____ Event Scratched	_____ Place in District/Area

**(FOR USE BY DISTRICT/AREA DIRECTOR TO INFORM REGIONAL DIRECTOR OF ADD)**

District /Area Director may fax to (210) 491-6135 or email form to kparke2@neisd.net

_____ Name of Athlete Added	_____ Event	_____ Original Place in District/Area Meet
_____ School	_____ Coach	_____ District/Area Director Signature

**DEADLINE FOR CHANGES: TUESDAY, APRIL 21, 2020 @ 10:00 AM**

\_\_\_\_\_  
Date Submitted to Regional Director

## TRACK & FIELD SUBSTITUTE CERTIFICATION FORM

(FOR USE BY COACH TO INFORM DISTRICT/AREA DIRECTOR OF SCRATCH)

_____ School	_____ Coach	_____ District – Conference EX: 29 – 5A
_____ Name of Athlete	_____ Event Scratched	_____ Place in District/Area

**(FOR USE BY DISTRICT DIRECTOR/AREA TO INFORM REGIONAL DIRECTOR OF ADD)**

District/Area Director may fax to (210) 491-6135 or email form to kparke2@neisd.net

_____ Name of Athlete Added	_____ Event	_____ Original Place in District/Area Meet
_____ School	_____ Coach	_____ District/Area Director Signature

**DEADLINE FOR CHANGES: TUESDAY, APRIL 20, 2021 @ 10:00 A.M.**

\_\_\_\_\_  
Date Submitted to Regional Director

### Practice Relay Cards

These will not be accepted as official relay cards.

**OFFICIAL RELAY CARDS WILL BE AVAILABLE AT CHECK IN**

#### 4x100 (400 METER RELAY)

	<b>PRINT FIRST AND LAST NAMES NEATLY</b>	<b>PRELIMS</b>	<b>FINALS</b>
<b>1.</b>			
<b>2.</b>			
<b>3.</b>			
<b>4.</b>			
<b>5. alt</b>			
<b>6. alt</b>			

#### 4X200 ( 800 METER RELAY )

	<b>PRINT FIRST AND LAST NAMES NEATLY</b>	<b>PRELIMS</b>	<b>FINALS</b>
<b>1.</b>			
<b>2.</b>			
<b>3.</b>			
<b>4.</b>			
<b>5. alt</b>			
<b>6. alt</b>			

#### 4X400 (1600 METER RELAY)

	<b>PRINT FIRST AND LAST NAMES NEATLY</b>	<b>PRELIMS</b>	<b>FINALS</b>
<b>1.</b>			
<b>2.</b>			
<b>3.</b>			
<b>4.</b>			
<b>5. alt</b>			
<b>6. alt</b>			



## UIL Pole Vault Certification Form

In compliance with the National Federation of High Schools Track and Field Rule 7-5-3, this form is provided to verify pole vaulter's weights and pole ratings prior to warm-up and competition.

Vaulter's School:	Coach's Name (print):
Site of Competition:	Date of Competition:

Vaulter's Name:	Vaulter's Weight:	lbs.
Pole #1: Length:	Pole Rating Weight:	lbs.
Pole #2: Length:	Pole Rating Weight:	lbs.
Pole #3: Length:	Pole Rating Weight:	lbs.
Pole #4: Length:	Pole Rating Weight:	lbs.
Pole #5: Length:	Pole Rating Weight:	lbs.
Pole #6: Length:	Pole Rating Weight:	lbs.
Pole #7: Length:	Pole Rating Weight:	lbs.
Pole #8: Length:	Pole Rating Weight:	lbs.
Athlete Signature:	Date:	

Coach's Printed Name:	Date:
Coach's Signature:	Date:



## UIL Pole Vault Certification Form

In compliance with the National Federation of High Schools Track and Field Rule 7-5-3, this form is provided to verify pole vaulter's weights and pole ratings prior to warm-up and competition.

Vaulter's School:	Coach's Name (print):
Site of Competition:	Date of Competition:

Vaulter's Name:	Vaulter's Weight:	lbs.
Pole #1: Length:	Pole Rating Weight:	lbs.
Pole #2: Length:	Pole Rating Weight:	lbs.
Pole #3: Length:	Pole Rating Weight:	lbs.
Pole #4: Length:	Pole Rating Weight:	lbs.
Pole #5: Length:	Pole Rating Weight:	lbs.
Pole #6: Length:	Pole Rating Weight:	lbs.
Pole #7: Length:	Pole Rating Weight:	lbs.
Pole #8: Length:	Pole Rating Weight:	lbs.
Athlete Signature:	Date:	

Coach's Printed Name:	Date:
Coach's Signature:	Date:

**The following are NFHS Track and Field Rules relevant to pole vault safety:**

Rule 7-5-2: The vaulting pole may be of any material and of length and diameter. It may have a binding of not more than two layers of adhesive tape of uniform thickness. However, the bottom of the pole may be protected by several layers of tape, PVC, metal, sponge rubber, or other suitable material to protect it when placed in the planting box.

**Rule 7-5-3:** The competitor's weight shall be at or below the manufacturer's pole rating. The manufacturers must include on each pole: the pole rating that shall be a minimum of  $\frac{3}{4}$  inch in a contrasting color located within or above the top hand-hold position; a 1-inch circular band indicating the maximum top hand-hold position with the position being determined by the manufacturer. Prior to the competition, the Coach must verify that all of the schools' pole vaulters meet these requirements.

**7-5-4:** A competitor shall not use a variable weight pole, a pole which is improperly marked, or a pole rated below his/her weight, or any other equipment that is not legal during warm-up or competition. **NOTE:** Altering the pole in any fashion renders it illegal. **PENALTY: Disqualification from the event.**

**7-5-5:** Prior to warm-up, the field referee, head field judge, or assigned inspector of implements shall inspect each pole to be used in the competition to verify that the poles are legal equipment, per Rule 7-5-3. This includes checking the placement of a top hand-hold band, numerical pole ratings a minimum of  $\frac{3}{4}$ -inches in a contrasting color located within or above the top hand-hold band, and the proper binding of not more than two layers of adhesive tape of uniform thickness. The binding shall not be on or above the top handhold band.

**7-5-23:** A competitor shall not be allowed to use the pole of another individual without the consent of the owner. The event judge shall approve the use and verify that the pole is rated weight-appropriate. **PENALTY: Disqualification from the event.**

**Rule 7-5-29h:** It is a foul if the competitor grips the pole above the top handhold band. **PENALTY: An unsuccessful trial is charged, but not measured.**

**The following are NFHS Track and Field Rules relevant to pole vault safety:**

Rule 7-5-2: The vaulting pole may be of any material and of length and diameter. It may have a binding of not more than two layers of adhesive tape of uniform thickness. However, the bottom of the pole may be protected by several layers of tape, PVC, metal, sponge rubber, or other suitable material to protect it when placed in the planting box.

**Rule 7-5-3:** The competitor's weight shall be at or below the manufacturer's pole rating. The manufacturers must include on each pole: the pole rating that shall be a minimum of  $\frac{3}{4}$  inch in a contrasting color located within or above the top hand-hold position; a 1-inch circular band indicating the maximum top hand-hold position with the position being determined by the manufacturer. Prior to the competition, the Coach must verify that all of the schools' pole vaulters meet these requirements.

**7-5-4:** A competitor shall not use a variable weight pole, a pole which is improperly marked, or a pole rated below his/her weight, or any other equipment that is not legal during warm-up or competition. **NOTE:** Altering the pole in any fashion renders it illegal. **PENALTY: Disqualification from the event.**

**7-5-5:** Prior to warm-up, the field referee, head field judge, or assigned inspector of implements shall inspect each pole to be used in the competition to verify that the poles are legal equipment, per Rule 7-5-3. This includes checking the placement of a top hand-hold band, numerical pole ratings a minimum of  $\frac{3}{4}$ -inches in a contrasting color located within or above the top hand-hold band, and the proper binding of not more than two layers of adhesive tape of uniform thickness. The binding shall not be on or above the top handhold band.

**7-5-23:** A competitor shall not be allowed to use the pole of another individual without the consent of the owner. The event judge shall approve the use and verify that the pole is rated weight-appropriate. **PENALTY: Disqualification from the event.**

**Rule 7-5-29h:** It is a foul if the competitor grips the pole above the top handhold band. **PENALTY: An unsuccessful trial is charged, but not measured.**

TIME: \_\_\_\_\_

### OFFICE OF ATHLETICS

### APPEAL FORM

TIME OF EVENT: \_\_\_\_\_ A.M. P.M.      TIME OF FILING: \_\_\_\_\_ A.M. P.M.

Describe in detail the reason for this appeal: \_\_\_\_\_  
\_\_\_\_\_  
\_\_\_\_\_  
\_\_\_\_\_  
\_\_\_\_\_



Identify your approximate position at the time of the violation with "X".  
Identify the location of the violation with "V". Identify other witness with "W".

Names of Witnesses: \_\_\_\_\_  
\_\_\_\_\_  
\_\_\_\_\_

Please identify what rule was specifically violated:  
Rule# \_\_\_\_\_, Section \_\_\_\_\_ Article \_\_\_\_\_

\_\_\_\_\_  
SIGNATURE OF HEAD COACH

## HyTek Procedures for District/Area Track Meet Director 2021:

If you use HyTek, *immediately after your meet*, export the advancers, and email them to the HyTeK Official at [thasti@neisd.net](mailto:thasti@neisd.net)

You will also need to fax your meet results with finishers of places 1 – 8.

The fax number is (210) 491-6135

If problems occur please call 210-356-6923

### Data Entry Checklist:

1. Please check that all athlete names are spelled correctly with correct capitalization (ex. John Doe is correct...not john doe or JOHN DOE.)
2. The “year in school” should be included for each athlete in the following format: 09 for 9<sup>th</sup> grade, 10 for 10<sup>th</sup> grade, 11 for 11<sup>th</sup> grade and 12 for 12<sup>th</sup> grade.
3. Input names of the relay team members under each relay, including the relay alternates (maximum of 6 names).
4. Field event results must resolve all ties through 6<sup>th</sup> place using NFHS tiebreaker rules.

### Creating the District Meet Using HyTek Windows Meet Manager:

**1. Divisions:** Under “Meet Setup” choose “Divisions by Event.” Also, click Set-up: “Division/Region Names” and choose “Divisions.” Use your conference as listed in the chart below. This set up will put your conference in the correct events when imported.

*This is a very important step.*

Div#	Code	Division Name
5	5A	5A
6	6A	6A

**2. Event Numbers:** *The attached event numbers must be used to ensure that we can merge your meet with ours.* Be sure and use your conference event numbers. Be sure the person in charge of computer scoring gets these event numbers.

#### **6A Codes**

601 – Women 3200 Meter Run 4A  
602 – Men 3200 Meter Run 4A  
603 – Women 4x100 Meter Relay 4A  
604 – Men 4X100 Meter Relay 4A  
605 – Women 800 Meter Run 4A  
606 – Men 800 Meter Run 4A  
607 – Women 100 Meter Hurdles 4A  
608 – Men 110 Meter Hurdles 4A  
609 – Women 100 Meter Dash 4A  
610 – Men 100 Meter Dash 4A  
611 – Women 4x200 Meter Relay 4A  
612 – Men 4x200 Meter Relay 4A  
613 – Women 400 Meter Dash 4A  
614 – Men 400 Meter Dash 4A  
615 – Women 300 Meter Hurdles 4A  
616 – Men 300 Meter Hurdles 4A

#### **5A Codes**

501 – Women 3200 Meter Run 5A  
502 – Men 3200 Meter Run 5A  
503 – Women 4x100 Meter Relay 5A  
504 – Men 4X100 Meter Relay 5A  
505 – Women 800 Meter Run 5A  
506 – Men 800 Meter Run 5A  
507 – Women 100 Meter Hurdles 5A  
508 – Men 110 Meter Hurdles 5A  
509 – Women 100 Meter Dash 5A  
510 – Men 100 Meter Dash 5A  
511 – Women 4x200 Meter Relay 5A  
512 – Men 4x200 Meter Relay 5A  
513 – Women 400 Meter Dash 5A  
514 – Men 400 Meter Dash 5A  
515 – Women 300 Meter Hurdles 5A  
516 – Men 300 Meter Hurdles 5A



617 – Women 200 Meter Dash 4A	517 – Women 200 Meter Dash 5A
618 - Men 200 Meter Dash 4A	518 – Men 200 Meter Dash 5A
619 – Women 1600 Meter Run 4A	519 – Women 1600 Meter Run 5A
620 – Men 1600 Meter Run 4A	520 – Men 1600 Meter Run 5A
621 – Women 4x400 Meter Relay 4A	521 – Women 4x400 Meter Relay 5A
622 – Men 4x400 Meter Relay 4A	522 – Men 4X400 Meter Relay 5A
623 – Women Discus Throw 4A	523 – Women Discus Throw 5A
624 – Men Discus Throw 4A	524 – Men Discus Throw 5A
625 – Women High Jump 4A	525 – Women High Jump 5A
626 – Men High Jump 4A	526 – Men High Jump 5A
627 – Women Long Jump 4A	527 – Women Long Jump 5A
628 – Men Long Jump 4A	528 – Men Long Jump 5A
629 – Women Pole Vault 4A	529 – Women Pole Vault 5A
630 – Men Pole Vault 4A	530 – Men Pole Vault 4A
631 – Women Shot Put 4A	531 – Women Shot Put 4A
632 – Men Shot Put 4A	532 – Men Shot Put 5A
633 – Women Triple Jump 4A	533 – Women Triple Jump 5A
634 – Men Triple Jump 4A	534 – Men Triple Jump 5A

**3. School Codes: The UIL school codes must be used for the HyTek program to work properly. The school code and the school code name must be the same as listed on the UIL list. DO NOT put HS or High School after the school names.**

*The HyTek program does not identify the school unless both of these items are typed correctly.*

Be sure the person in charge of computer scoring gets these school codes. The schools and codes can be found on the UIL Website on this link:

<http://www.uil texas.org/track-field/school-codes>

### **Instructions for Exporting Advancers from HyTek Windows Meet Manager to the Regional Meet Director:**

Advancers: Follow the steps below to export advancers to Regional Meet.

1. Under “File” choose “Export” then choose “Advancers”.
2. Under Advancers you will select all events.

#### ***From District to Regionals:***

Top How Many From Each Event Advance: 1

#### ***From Area to Regionals:***

Top How Many From Each Event Advance: 2

Maximum Qualifiers per Event: Leave Blank

Include Relay Names Check this (we NEED relay names)

Custom Select Advancers Leave Blank

3. Then create the export.
4. Email this report to Regional Meet Manager at: thasti@neisd.net
5. Fax the results to Regional Meet Manager at 210-491-6135 immediately after the meet. The results **DO NOT** need to be typed on the UIL Track And Field District Result Form. You may use the HyTek results format.

**2019 REGION IV – AAAAA GIRLS  
TRACK AND FIELD RECORDS**

MT = MANUAL TIME  
FAT = FULLY AUTOMATIC TIME

3200 Meter Run 5-A	10:54.3	1981	Kim Whitaker - New Braunfels (MT)
	10:44.03	2016	Abby Gray – Alamo Heights (FAT)
4x100 Meter Relay 5-A	46.5	2001	Austin Reagan - (MT) S.Brantley, N.Franklin, L.Moore, L.Urbina
	46.75	2017	Austin Johnson – (FAT) D.Gilbert, R.Horowitz, S.Porter, H.Porter
800 Meter Run 5-A	2:12.4	2001	Dee Dee Cortez - Mission Sharyland (MT)
	2:10.01	2018	Bailey Goggans – Marble Falls (FAT)
100 Meter Hurdles 5-A	14.00	1981	Kari Harris - Gregory Portland (MT)
	14.53	2013	Autymn Scales – Northside Brennan (FAT)
100 Meter Dash 5-A	11.5	2002	Larica Urbina - Austin Reagan (MT)
	11.80	2004	Gyiasha Hall – Austin Reagan (FAT)
4x200 Meter Relay 5-A	1:38.9	2001	Austin-Reagan - (MT) L.Moore, S.Brantley, L.Urbina, N.Franklin
	1:40.15	2018	Austin Johnson – (FAT) D. Gilbert, S. Porter, H. Porter, C. Anyatonwu
400 Meter Dash 5-A	54.50	2003	Johnsie Liles - Austin Johnston (MT)
	55.52	2018	Bailey Goggans – Marbles Falls (FAT)
300 Meter Hurdles 5-A	42.9	2001	Samantha Spaulding - Rockport Fulton (MT)
	43.84	2011	Bailey Johnson – Dripping Springs (FAT)
200 Meter Dash 5-A	24.0	1989	Stacey Clack - Austin Anderson (MT)
	20.62	2017	Caroline Anyatonwu – Austin Johnson (FAT)
1600 Meter Run 5-A	5:01.7	2003	Dacia Barr - Austin Lake Travis (MT)
	4:55.95	2016	Abby Gray – Alamo Heights (FAT)
4x400 Meter Relay 5-A	3:52.6	2000	Austin-Reagan - (MT) S.Brantley, B.Brockington, L.Moore, N. Franklin
	3:50.94	2019	Boerne Champion – (FAT) L. Bolli, H. Stadler, R. Burkey, A. Gonzales
Discus Throw 5-A	156-09	1979	Dana Olson - Austin Westlake
High Jump 5-A	6-00.00	1993	Amy Acuff - Corpus Christi Calallen
Long Jump 5-A	20-00.75	2005	Brandi Stanfield – Pflugerville Connally
Pole Vault 5-A	13-09.00	2018	Riley Floerke – Gregory Portland
Shot Put 5-A	50-01.00	1999	Ibie Benido - Corpus Christi Calallen
Triple Jump 5-A	41-09.75	2005	Brandi Stanfield – Pflugerville Connally

**2019 – REGION IV – AAAAA BOYS  
TRACK AND FIELD RECORDS**

MT = MANUAL TIME  
FAT = FULLY AUTOMATIC TIME

3200 Meter Run 5-A	9:06.2	1999	Tommy Bonn - Lockhart (MT)
	9:12.37	2008	Rory Tunningley – Lockhart (FAT)
4x100 Meter Relay 5-A	41.0	1992	Austin Reagan – (MT) T.Green, R.Howard, C.Hawkins, S.Andrews
	41.08	2018	Angleton – (FAT) E. Hawkins, C. Bowie, M. Ross, T. Williams
800 Meter Run 5-A	1:52.1	1985	Matt Dunn - Hays Consolidated (MT)
	1:53.12	2015	Reagan Olguin – Edinburg Vela (FAT)
110 Meter Hurdles 5-A	13.4	1996	Martin Dossett - Gregory Portland (MT)
	14.20	2013	Jonathan Jefferson – San Antonio Highlands (FAT)
100 Meter Dash 5-A	9.90	2002	Brendan Christian - Austin Reagan (MT)
	10.65	2019	Isaiah Reyes – Flour Bluff (FAT)
4x200 Meter Relay 5-A	1:27.4	2003	Gregory Portland – (MT) C. Greer, C Davis, R. Cortez, C.Wilson
	1:26.20	2013	Corpus Christi Flour Bluff – (FAT) R.Mendoza, J. Pradia, A.Dilworth, T.Martin
400 Meter Dash 5-A	46.8	2000	Jonte Buhl - Pflugerville Connally (MT)
	47.81	2013	Steven Champlin – Castroville Medina Valley (FAT)
300 Meter Hurdles 5-A	36.5	1999	Ira Cunningham - Austin LBJ (MT)
	37.88	2008	Andre Sanders – Cedar Park Vista Ridge (FAT)
200 Meter Dash 5-A	20.7	2002	Brendan Christian - Austin Reagan (MT)
	21.35	2013	J J Pradia – Corpus Christi Flour Bluff (FAT)
1600 Meter Run 5-A	4:16.5	1999	Tommy Bonn - Lockhart (MT)
	4:14.99	2011	Travis Barclay – Boerne Champion (FAT)
4x400 Meter Relay 5-A	3:14.1	1992	Austin-Reagan – (MT) T.Green, W. Lowe, R.Howard, C.Hawkins
	3:17.61	2017	Victoria West – (FAT) J.Smith, J.Ventura, K.Freeman, T.Ogden
Discus Throw 5-A	199-00	2002	Derek Randall - Beeville Jones
High Jump 5-A	6-11.00	1998	Ryan Harlan - Waco Midway
Long Jump 5-A	23-11.50	1995	Tanyana McCray - Flour Bluff
Pole Vault 5-A	16-03.50	2008	Kaleb Sharder – Gregory-Portland
Shot Put 5-A	65-02.50	1987	Lance Wilson - Pflugerville
Triple Jump 5-A	48-07.50	2017	Vonte Davis – Rosenberg Terry

**2019 – REGION IV – AAAAAA GIRLS  
TRACK AND FIELD RECORDS**

MT = MANUAL TIME  
FAT – FULLY AUTOMATIC TIME

3200 Meter Run 6-A	10:49	1984	Kathy Smith - San Antonio Churchill (MT)
	10:18.37	2015	Devin Clark – Spring Branch Smithson Valley (FAT)
4x100 Meter Relay 6-A	46.80	1987	Willowridge - (MT) M. Brookman, R. Taylor, A. Wilbourn, L. Williams
	45.98	2015	Converse Judson – (FAT) K.James, M.Kuykendoll, K.Pickens, K.Horton
800 Meter Run 6-A	2:12.9	1987	Laura Vasquez - Edinburg (MT)
	2:10.78	2017	Megan Rourke – Austin Lake Travis (FAT)
100 Meter Hurdles 6-A	13.6	2002	Angel Boyd - Converse Judson (MT)
	14.19	2013	Jerica Love – Northside Warren (FAT)
100 Meter Dash 6-A	11.10	2002	Marshevet Hooker - San Antonio Southwest (MT)
	11.56	2019	Jasmine Montgomery – San Antonio Reagan (FAT)
4x200 Meter Relay 6-A	1:39.8	1985	San Antonio- Holmes - (MT) F. Knight, R. Boone, K. Bryant, R. Bryant
	1:37.36	2015	Converse Judson (FAT) K.James, M.Kuykendoll, K.Pickens, K.Horton
400 Meter Dash 6-A	54.5	2002	Shanta Bibbs - San Antonio Clark (MT)
	54.63	2016	Mariah Kuykendoll – Judson (FAT)
300 Meter Hurdles 6-A	42.1	1992	Anjanette Kirkland - San Antonio Holmes (MT)
	42.43	2009	Christine Holland – Converse Judson (FAT)
200 Meter Dash 6-A	23.5	2002	Marshevet Hooker - San Antonio Southwest (MT)
	23.52	2015	Kiana Horton – Converse Judson (FAT)
1600 Meter Run 6-A	5:02.4	1990	Sonia Sepulveda - Edinburg (MT)
	4:45.91	2015	Devin Clark – Spring Branch Smithson Valley (FAT)
4x400 Meter Relay 6-A	3:49.7	1998	New Braunfels - (MT) L. Reimer, J. Anderson, L. Gow, K. Reimer
	3:46.11	2015	Converse Judson (FAT) M.Kuykendoll, Z.Dickerson, T.Mack, D.Gibson
Discus Throw 6-A	155-01	2018	Sadey Rodriguez – Laredo United
High Jump 6-A	6-00-00	2010	Michaela Palu – San Antonio Marshall
Long Jump 6-A	20-04.00	1993	Tameka Roberts - CC Moody
Pole Vault 6-A	13-02-00	2014	Sara Kathryn Stevens – New Braunfels
Shot Put 6-A	46-01.50	2009	Taylor Rosser – Converse Judson
Triple Jump 6-A	40-06.75	2001	Chaytan Hill - Converse Judson

**2019– REGION IV – AAAAAA BOYS  
TRACK AND FIELD RECORDS**

MT= MANUAL TIME  
FAT = FULLY AUTOMATIC TIME

3200 Meter Run 6-A	9:00.70	1981	Roland Reina - San Antonio John Jay (MT)
	9:00.60	2015	Alex Rogers – Canyon (FAT)
4x100 Meter Relay 6-A	40.7	1988	Willowridge - (MT) G. Caveness, C. Raby, A. McDonald, M. Miller
	40.98	2017	Converse Judson – (FAT) J.West, C. Mills II, S.Richburg, K.Morgan
800 Meter Run 6-A	1:51.9	1993	Andrew Burrow - Seguin (MT)
	1:49.68	2017	Sam Worley – Canyon (FAT)
110 Meter Hurdles 6-A	13.6	1996	Chris Allen - Converse Judson (MT)
	13.88	2016	Josh McGowen – McAllen (FAT)
100 Meter Dash 6-A	10.2	1990	Stephen Peterson - Austin Johnston (MT)
	10.43	2019	Jose Garcia – Harlingen (FAT)
4x200 Meter Relay 6-A	1:26.8	2003	San Antonio East Central – (MT) Q Young, K Wynn, L Hall, A Boyd
	1:24.83	2017	Converse Judson – (FAT) J.West, C. Mills II, S.Richburg, K.Morgan
400 Meter Dash 6-A	47.0	2001	Darold Williamson - San Antonio Holmes (MT)
	47.26	2016	Jon Mass – Clark (FAT)
300 Meter Hurdles 6-A	36.20	1987	Ralph Carrington - Austin LBJ (MT)
	36.39	2018	Tre’Bien Gilbert – Judson (FAT)
200 Meter Dash 6-A	20.9	1988	Dushon Orr - Austin Reagan (MT)
	20.93	2013	Cameron Williams – San Antonio Johnson (FAT)
1600 Meter Run 6-A	4:12.7	1985	Reuben Reina - San Antonio John Jay (MT)
	4:09.00	2016	Samuel Worley – Canyon (FAT)
4x400 Meter Relay 6-A	3:14.5	2000	San Antonio Holmes - (MT) C. Griffin, O. Rubio, R Quiroga, D. Williamson
	3:15.16	2014	Converse Judson – (FAT) C.Johnson, J. Lewis, B.Sanders, R.Reece
Discus Throw 6-A	192-11.50	1983	David Stanley - Angleton
High Jump 6-A	7-02.00	1990	Russell Garcia - Alice
Long Jump 6-A	24-06.00	1959	Dudley Haas - Corpus Christi Ray
Pole Vault 6-A	16-03.25	2018	Logan Fraley – Brandeis
Shot Put 6-A	72-06.25	2009	Stephen Saenz – Rio Grande Valley
Triple Jump 6-A	49-00.50	2019	Rashod Owens - San Antonio Roosevelt

**2019– REGION IV – GIRLS/BOYS  
WHEELCHAIR TRACK AND FIELD RECORDS**

MT = MANUAL TIME

FAT – FULLY AUTOMATIC TIME

100 Meter Girls	22.00	2019	Suzannah Swanson – McAllen Memorial (FAT)
100 Meter Boys	17.79	2016	Joe Solis – Weslaco (FAT)
400 Meter Girls	1:35.04	2018	Suzannah Swanson – McAllen Memorial (FAT)
400 Meter Boys	1:03.15	2017	Joe Solis - Weslaco (FAT)
Shot Put Girls	11-03	2017	Catalina Clubb – CC Tuloso-Midway
Shot Put Boys	17-04	2017	Bryan Prado – CC Veterans Memorial



# NO PURSES. NO BAGS.

## NEISD BAC PURSE/BAG POLICY



### Prohibited Bags

#### PROHIBITED ITEMS INCLUDE, BUT ARE NOT LIMITED TO:

- All purses, bags or containers larger than a small clutch bag
- Backpacks
- Binocular case – Binoculars may be worn around the neck
- Briefcases
- Camera bags
- Cinch bags
- Computer bags
- Coolers
- Fanny packs
- Luggage of any kind



### Approved Bags

**CLEAR TOTE**  
Plastic, vinyl or PVC –  
not exceeding 12" x 6" x 12"

**PLASTIC STORAGE BAG**  
Clear, one (1) gallon,  
re-sealable

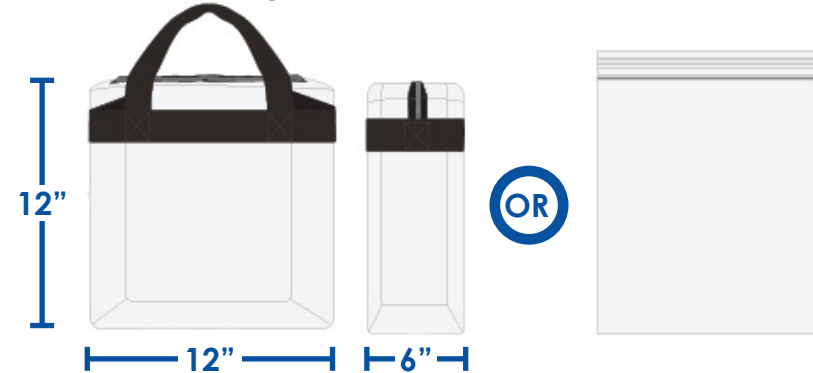

#### SMALL CLUTCH PURSE

Approximately the size of your hand, but absolutely no larger than 5.5" x 8.5" (see our small guide sheet) with or without a handle or strap. Can be carried separately or within an approved plastic bag shown above.



Exceptions will be made for:

- Bags for medically necessary items
- News media equipment (for credentialed media)
- Official team and other field photographers
- Booster clubs selling items
- Diaper bags

**All bags** are subject to inspection prior to entry regardless of size or type.



**2020-21 OFFICIAL DISTRICT ALIGNMENT  
SPRING ATHLETICS  
CONFERENCE 5A**

**Region 1**

**Region 2**

**Region 3**

**Region 4**

<b>District 1</b> El Paso El Paso Address El Paso Austin El Paso Bowie El Paso Burges El Paso Chapin El Paso Irvin El Paso Jefferson	<b>District 5</b> Aledo Azle Granbury White Settlement Brewer Wichita Falls Wichita Falls Rider <b>District 6</b> Colleyville Heritage Denton Denton Ryan Grapevine Lake Dallas N Richland Hills Birdville N Richland Hills Richland Northwest <b>District 7</b> Ft Worth Arlington Hts Ft Worth North Side Ft Worth Polytechnic Ft Worth South Hills Ft Worth Southwest Ft Worth Trimble Tech Ft Worth Wyatt Saginaw <b>District 8</b> Arlington Seguin Burleson Burleson Centennial Crowley Everman Mansfield Legacy Mansfield Summit Mansfield Timberview	<b>District 9</b> Frisco Frisco Centennial Frisco Heritage Frisco Independence Frisco Lebanon Trail Frisco Liberty Frisco Lone Star Frisco Memorial Frisco Reedy Frisco Wakeland <b>District 10</b> Denison Lewisville The Colony Lucas Lovejoy McKinney North Princeton Prosper Rock Hill Sherman Wylie East <b>District 11</b> Carrollton Creekview Carrollton Smith Carrollton Turner Dallas Adams Dallas Conrad Dallas Hillcrest Dallas Jefferson Dallas White Dallas Wilson <b>District 12</b> Dallas Adamson Dallas Kimball Dallas Molina Dallas Samuel Dallas Seagoville Dallas South Oak Cliff Dallas Spruce Dallas Sunset Lancaster	<b>District 13</b> Crandall Dallas Highland Park Forney Greenville Mesquite Poteet North Forney Royse City West Mesquite <b>District 14</b> Cleburne Corsicana Ennis Joshua Midlothian Red Oak Waco University <b>District 15</b> Hallsville Longview Longview Pine Tree Marshall Mount Pleasant Sulphur Springs Texarkana Texas <b>District 16</b> Huntsville Jacksonville Lufkin Nacogdoches Tyler Whitehouse	<b>District 17</b> Austin Anderson Austin Ann Richards Austin Crockett Austin LASA Austin McCallum Austin Navarro Austin Northeast Austin Travis Lockhart <b>District 18</b> Bastrop Bastrop Cedar Creek Elgin Manor Pflugerville Pflugerville Connally Pflugerville Hendrickson Pflugerville Weiss <b>District 19</b> Brenham Bryan Rudder College Station College Station A&M Consolidated Katy Jordan Katy Paetow Magnolia Magnolia West Waller <b>District 20</b> Cleveland Conroe Caney Creek Dayton Humble Kingwood Park Montgomery Montgomery Lake Creek New Caney New Caney Porter	<b>District 21</b> Beaumont United Crosby Galena Park Mt Belvieu Barbers Hill Nederland Port Arthur Memorial Port Neches-Groves <b>District 22</b> Baytown Goose Crk Mem Baytown Lee Baytown Sterling Friendswood Galveston Ball La Porte Manvel Santa Fe Texas City <b>District 23</b> H Austin H Madison H Milby H Northside H Sharpstown H Sterling H Waltrip H Wisdom <b>District 24</b> Angleton Fort Bend Hightower Fort Bend Kempner Fort Bend Marshall Fort Bend Willowridge Lamar Fulshear Richmond Foster Rosenberg Lamar Cons Rosenberg Terry	<b>District 25</b> Cedar Park Georgetown Georgetown East View Leander Leander Glenn Leander Rouse Liberty Hill Marble Falls <b>District 26</b> Boerne Champion Buda Johnson Comal Canyon Dripping Springs Kerrville Tivy Kyle Lehman SA Alamo Heights SA Veterans Memorial Seguin <b>District 27</b> SA Brackenridge San Antonio Burbank San Antonio Edison San Antonio Highlands San Antonio Houston San Antonio Jefferson San Antonio Kennedy San Antonio Lanier San Antonio Memorial <b>District 28</b> Castroville Medina Valley Eagle Pass Winn Floresville SA SW CAST STEM HS San Antonio Harlandale San Antonio McCollum San Antonio Southside San Antonio Southwest Southwest Legacy	<b>District 29</b> CC Carroll CC Flour Bluff CC Veterans Memorial Corpus Christi King Corpus Christi Moody Corpus Christi Ray Gregory-Portland Victoria East Victoria West <b>District 30</b> La Joya Palmview Laredo Cigarroa Laredo Martin Mission Veterans Memorial Rio Grande City Roma <b>District 31</b> McAllen McAllen Memorial McAllen Rowe Mission Sharyland Pharr Valley View PSJA Memorial PSJA Southwest Sharyland Pioneer <b>District 32</b> Brownsville Lopez Brownsville Pace Brownsville Porter Brownsville Veterans Memorial Donna Edcouch-Elsa Mercedes Weslaco East
--	---	---	--	--	---	---	---



## 5A Spring Meet District Chairs

District	Name	Email	Title	School Name
25	Jody Hormann	jody.hormann@leanderisd.org	Athletic Director	Cedar Park HS
26	Dustin Davisson	Dustin.davisson@comalisd.org	Principal	Comal Canyon HS
27	Orlando Vera	overa4806@gmail.com	Administrator	san antonio jefferson hs
28	Paul Black	pblack@swisd.net	Principal	San Antonio Southwest HS
30	Mabeline Rodriguez	Mrodri37@mcisd.org	Head Coach	Mission Veterans Memorial HS
31	Julissa Rodriguez	julissa.rodriguez@psjaisd.us	Administrator	PHARR-SAN JUAN-ALAMO MEMORIAL HS



**2020-21 OFFICIAL DISTRICT ALIGNMENT  
SPRING ATHLETICS  
CONFERENCE 6A**

**Region 1**

**Region 2**

**Region 3**

**Region 4**

<b>District 1</b>	<b>District 5</b>	<b>District 9</b>	<b>District 13</b>	<b>District 17</b>	<b>District 21</b>	<b>District 25</b>	<b>District 29</b>
El Paso Americas	Allen	Garland	Conroe	Cy-Fair	Beaumont West Brook	Austin Vandegrift	Northside Brennan
El Paso Coronado	Denton Braswell	Garland Lakeview Cent	Conroe Grand Oaks	Cyp. Creek	Galena Park North Shore	Cedar Park Vista Ridge	Northside Harlan
El Paso Eastlake	Denton Guyer	Garland Naaman Forest	Conroe Oak Ridge	Cyp. Ridge	Humble	Hutto	Northside Health Careers
El Paso Eastwood	Little Elm	Garland Rowlett	Conroe The Woodlands	Houston Memorial	Humble Atascocita	Round Rock	Northside Holmes
El Paso Franklin	McKinney	Garland Sachse	Conroe Woodlands College Park	Houston Northbrook	Humble Kingwood	Round Rock McNeil	Northside Jay
El Paso Montwood	McKinney Boyd	North Garland	Willis	Houston Spring Woods	Humble Summer Creek	Round Rock Stony Pt.	Northside Marshall
El Paso Pebble Hills	Prosper	South Garland		Houston Stratford	Sheldon King	Round Rock Westwood	Northside O'Connor
El Paso Socorro		Wylie		Jersey Village		RR Cedar Ridge	Northside Stevens
<b>District 2</b>	<b>District 6</b>	<b>District 10</b>	<b>District 14</b>	<b>District 18</b>	<b>District 22</b>	<b>District 26</b>	<b>District 30</b>
Abilene	Coppell	Dallas Skyline	Houston Aldine	H Bellaire	Channelview	Austin	Del Rio
Midland	Lewisville	Mesquite	Houston Benjamin Davis Sr	H Carnegie Vanguard	Deer Park	Austin Akins	Eagle Pass
Midland Lee	Lewisville Flower Mound	Mesquite Horn	Houston Eisenhower	H Chavez	Pasadena	Austin Bowie	Laredo Alexander
Odessa	Lewisville Hebron	North Mesquite	Houston MacArthur	H Heights	Pasadena Dobie	Austin Lake Travis	Laredo Johnson
Odessa Permian	Lewisville Marcus	Rockwall	Houston Nimitz	H Lamar	Pasadena Memorial	Austin Westlake	Laredo Nixon
San Angelo Central	Plano	Rockwall Heath	Spring	H Math Sci. & Tech	Pasadena Rayburn	Buda Hays	Laredo United
Wolfforth Frenship	Plano East	Tyler Lee	Spring Dekaney	H Westbury	Pasadena South Houston	Del Valle	Laredo United South
	Plano West		Spring Westfield	H Westside		San Marcos	
<b>District 3</b>	<b>District 7</b>	<b>District 11</b>	<b>District 15</b>	<b>District 19</b>	<b>District 23</b>	<b>District 27</b>	<b>District 31</b>
Eules Trinity	Dallas Jesuit	Cedar Hill	Klein	Katy	Alief Elsie	Cibolo Steele	Edinburg
Ft Worth Boswell	Irving	De Soto	Klein Cain	Katy Cinco Ranch	Alief Hastings	Comal Smithson Valley	Edinburg Economedes
Ft Worth Paschal	Irving MacArthur	Duncanville	Klein Collins	Katy Mayde Creek	Alief Taylor	Converse Judson	Edinburg North
FW Chisholm Trail	Irving Nimitz	Mansfield	Klein Forest	Katy Morton Ranch	Alvin	New Braunfels	Edinburg Vela
Haltom City Haltom	Richardson	Mansfield Lake Ridge	Klein Oak	Katy Seven Lakes	Alvin Shadow Creek	San Antonio E. Central	La Joya
Hurst Bell	Richardson Berkner	Waco	Tomball	Katy Taylor	Houston Strake Jesuit	San Antonio Wagner	La Joya Juarez-Lincoln
North Crowley	Richardson Lake Highlands	Waco Midway	Tomball Memorial	Katy Tompkins	Pearland	Schertz Clemens	Mission
Weatherford	Richardson Pearce	Waxahachie			Pearland Dawson	South San Antonio	Pharr-San Juan-Alamo
<b>District 4</b>	<b>District 8</b>	<b>District 12</b>	<b>District 16</b>	<b>District 20</b>	<b>District 24</b>	<b>District 28</b>	<b>District 32</b>
Keller	Arlington	Belton	Bridgeland	Fort Bend Austin	Clute Brazoswood	Northside Brandeis	Brownsville Hanna
Keller Central	Arlington Bowie	Bryan	Cyp. Falls	Fort Bend Bush	Dickinson	Northside Clark	Brownsville Rivera
Keller Fossil Ridge	Arlington Houston	Copperas Cove	Cyp. Lakes	Fort Bend Clements	Frndswd Clear Brook	San Antonio Churchill	Donna North
Keller Timber Creek	Arlington Lamar	Killeen	Cyp. Park	Fort Bend Dulles	Houston Clear Lake	San Antonio Johnson	Harlingen
Northwest Eaton	Arlington Martin	Killeen Ellison	Cyp. Ranch	Fort Bend Elkins	LC Clear Creek	San Antonio LEE	Harlingen South
Northwest Nelson	Grand Prairie	Killeen Harker Heights	Cyp. Springs	Fort Bend Ridge Point	LC Clear Falls	San Antonio MacArthur	Los Fresnos
Southlake Carroll	South Grand Prairie	Killeen Shoemaker	Cyp. Woods	Fort Bend Travis	LC Clear Springs	San Antonio Madison	San Benito
		Temple	Langham Creek	Richmond George Ranch		San Antonio Reagan	Weslaco
						San Antonio Roosevelt	

## 6A Spring Meet District Chairs

<b>District</b>	<b>Name</b>	<b>Email</b>	<b>Title</b>	<b>School Name</b>
26	Leal Anderson	leal.j.anderson@gmail.com	Athletic Director	Bowie HS
27	Jana Cervantes	jcervantes@scuc.txed.net	Principal	Cibolo Steele HS
28	Todd Bloomer	tbloom@neisd.net	Principal	North East ISD Churchill HS
29	Darrell Rice	darrell.rice@nisd.net	Principal	Northside ISD Alternative HS
30	Jose Perez	Jose.Perez@sfd-cisd.org	Principal	Del Rio HS
31	Nelinda Villarreal	n.villarreal@ecisd.us	Administrator	Edinburg CISD